

# 2.54mm (0.1") Mini Jumper

## Two Circuit Shunt Connector

### 2206 Series

#### APPLICATION AND FEATURES

1. Easiest way of programming by simply connecting 2 contact point together or opposite.
2. Easy applied—No soldering.
3. All side stackable.
4. Low cost alternative to DIP switch.

#### SPECIFICATIONS

Current Rating: 3 Amps  
 Insulator resistance: 5000 Megohms Min.  
 Dielectric withstanding: AC 500 V  
 Operating Temperature: -40°C to +105°C  
 Contact Material: Phosphor Bronze  
 Insulator Material: Polyester, UL 94V-0

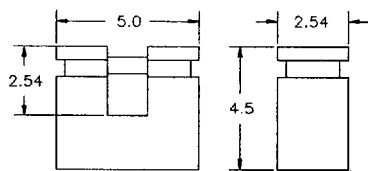

S Type

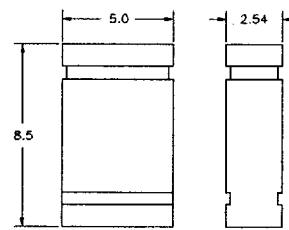
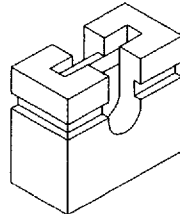

L Type

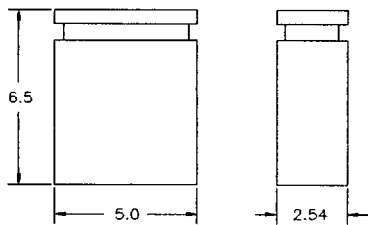
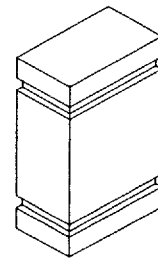

M Type

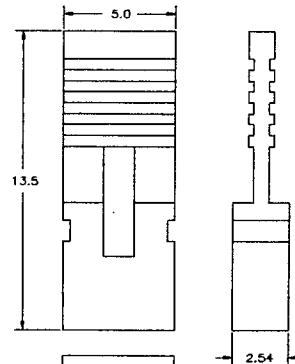
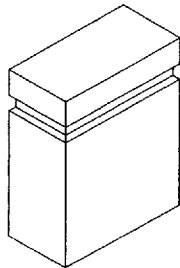

H Type

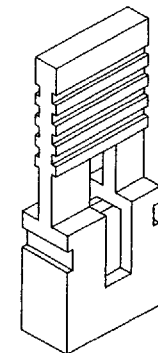

#### Order Information 2206 Series

Example: 2206-S-A-02

Series No.	Height Type	Open or Close	Contact Plating
2206	Definition	Close	Tin Plated
	Code	Open	Gold Plated
	4.5 mm	A	Flash
	6.0 mm (Open)	B	10 μ"
	8.0 mm		30 μ"
	13.8 mm		
	6.5mm (Close)		

SINGATRON ENT. CO., LTD. Tel.: (909) 464-1883 Fax.: (909) 464-1884

9011184 0000066 883