

SPECIFICATIONS

Current Rating: 3A AC,DC
 Voltage Rating: 500V AC,DC
 Temperature Range: -25°C ~ +85°C
 Contact Resistance: 20mΩ Max
 Insulation Resistance: 500MΩ Min
 Withstanding Voltage: 1000V AC/minute
 Pin Material: Brass/Tin-plated
 Material: PBT,UL94V-0
 Color: Natural(Black)

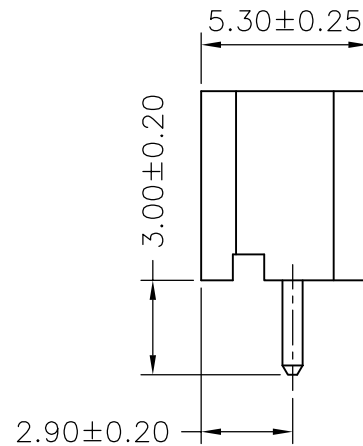
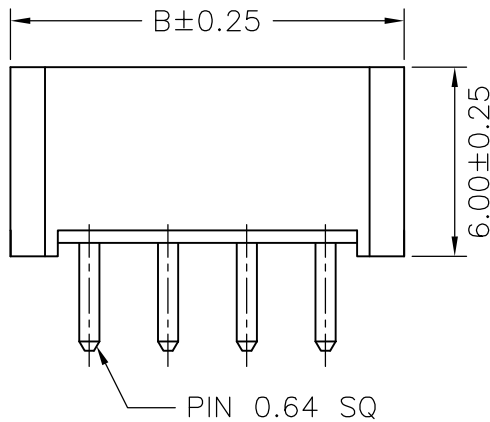

Ordering Information & Dimensions

PART NO.	Dimensions	
	A	B
A2507WV-02P	2.50	7.50
A2507WV-03P	5.00	10.00
A2507WV-04P	7.50	12.50
A2507WV-05P	10.00	15.00
A2507WV-06P	12.50	17.50
A2507WV-07P	15.00	20.00
A2507WV-08P	17.50	22.50
A2507WV-09P	20.00	25.00
A2507WV-10P	22.50	27.50
A2507WV-11P	25.00	30.00
A2507WV-12P	27.50	32.50
A2507WV-13P	30.00	35.00
A2507WV-14P	32.50	37.50
A2507WV-15P	35.00	40.00

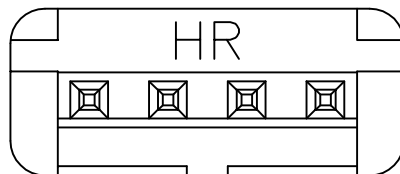

				JOINT TECH ELECTRONIC IND. CO., LTD. JOY DAY INDUSTRIAL CO., LTD.	
		UNIT	SCALE	SHEET	TITLE:
		mm		1 of 1	2.50mm PITCH 180° WAFER
		DRAWN BY		APPROVED BY	
		蕭惠風		謝瑞清	
		2004.04.05		2004.04.05	
B2	REVISE	2007.03.05	GENERAL TOLERANCE		DRAW NO.: A2507WV-XP
B1	REVISE	2005.11.23	X. X±0.25	ANGLE±	
B0	NEW RELEASE	2005.10.22	X. XX±0.15		
REV.	DESCRIPTION	DATE	X. XXX±0.05		
					REV. B2