

2.50mm(.098") Pitch Housing

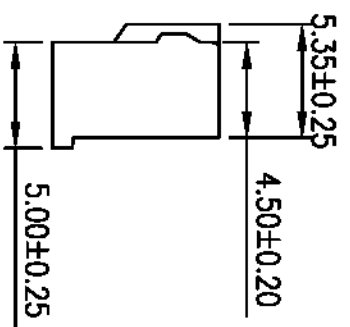
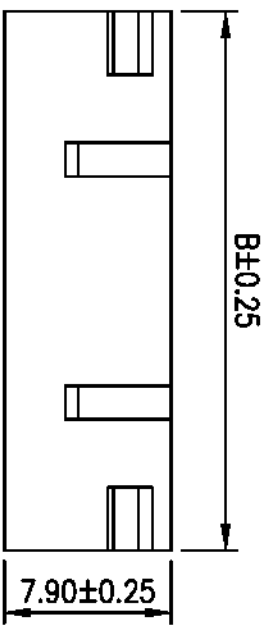
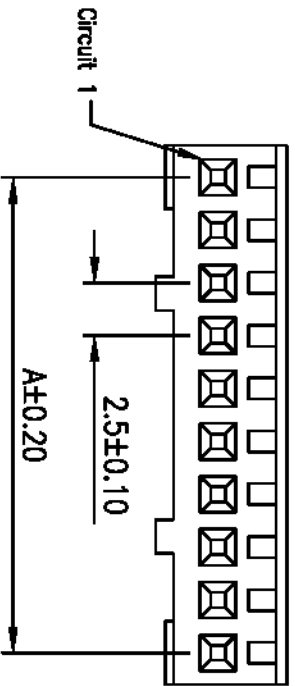

Features:

- * Available in 2 through 15 Circuits
- * Material: Nylon 66 UL94V-0
- * Accepts YY-1250-T Crimp Terminal
- * Mates with YY-1250-WXSS or YY-1250-WXRR Series Wafer

Specifications:

- * Pitch between poles 2.50mm
- * Rated Voltage 250V AC/DC
- * Rated Current 3A
- * Withstand Voltage 800V AC/minute
- * Insulation Resistance 1,000M Ohms/Min
- * Temperature Range -25°C~+85°C

Circuits	Part No	Dimension mm	
		A	B
2	YY-1250-H021	2.50	5.50
3	YY-1250-H031	5.00	8.00
4	YY-1250-H041	7.50	10.50
5	YY-1250-H051	10.00	13.00
6	YY-1250-H061	12.50	15.50
7	YY-1250-H071	15.00	18.00
8	YY-1250-H081	17.50	20.50
9	YY-1250-H091	20.00	23.00
10	YY-1250-H101	22.50	25.50
11	YY-1250-H111	25.00	28.00
12	YY-1250-H121	27.50	30.50
13	YY-1250-H131	30.00	33.00
14	YY-1250-H141	32.50	35.50
15	YY-1250-H151	35.00	38.00

EDITION	DATE	MODIFY	VIEW	DR	BY	AUDITING	APPROVAL	DATE	DWG NO	AS2506H1	TOLERANCE
A0	2003.05.12	DRAWING			Andy He	JEFF	Jessica	2003.05.12	YY-1250-HXX1	152-A0	.00
											.000

YOUNG YAK ENTERPRISE CO.,LTD.
 毅耀實業股份有限公司
 TEL:886-2-2999-9629
 FAX:886-2-2999-0575

2.50mm (.098") Pitch Wafer

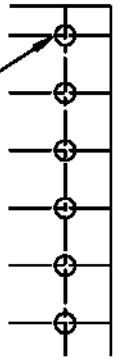
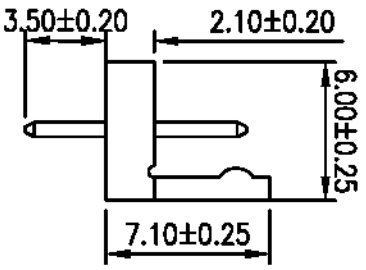
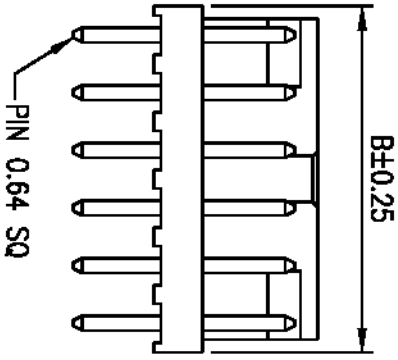
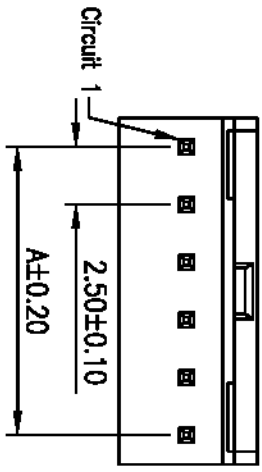

P.C.B. Thickness 0.8~1.6mm
P.C.B. Hole dia. ϕ 1.10mm \pm 0.10
P.C.B. LAYOUT

Ordering information:

YY-1250-WXXXS2

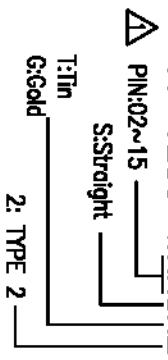

Features:

- * Available in 2 through 15 Circuits
- * Material: Nylon 66 UL94V-0
- * Mates with YY-1250-H Series Housing
- * 0.64mm(.025") Squard Pin
- * Pin Material: Brass/Tin-Plated

Specifications:

- * Pitch between poles 2.5mm
- * Rated Voltage 250V AC,DC
- * Rated Current 3A
- * Withstand Voltage 800V AC/minute
- * Insulation Resistance 1000M Ohms/Min
- * Temperature Range -25C~+85C



Circuits	Part No	Dimension mm	
		A	B
2	YY-1250-W02S	2.50	5.00
3	YY-1250-W03S	5.00	7.50
4	YY-1250-W04S	7.50	10.00
5	YY-1250-W05S	10.00	12.50
6	YY-1250-W06S	12.50	15.00
7	YY-1250-W07S	15.00	17.50
8	YY-1250-W08S	17.50	20.00

Circuits	Part No	Dimension mm	
		A	B
9	YY-1250-W09S	20.00	22.50
10	YY-1250-W10S	22.50	25.00
11	YY-1250-W04S	25.00	27.50
12	YY-1250-W05S	27.50	30.00
13	YY-1250-W06S	30.00	32.50
14	YY-1250-W07S	32.50	35.00
15	YY-1250-W08S	35.00	37.50

EDITION	DATE	MODIFY	VIEW	DRAW BY	AUDITING	APPROVAL	DATE	DWG NO	TOLERANCE
A0	2003.06.07	DRAWING		Andy He	JEFF	Jessica	2004.11.17	A2508WS2 152-A1	.0
A1	2004.11.17	CHANGE						YY-1250-WXXXS2	.00
									.000

YOUNG YAK ENTERPRISE CO.,LTD.
TEL:886-2-2999-9629
FAX:886-2-2999-0575

RoHS compliant

2.50mm(.098") Pitch Wafer

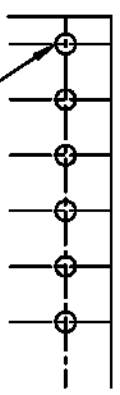
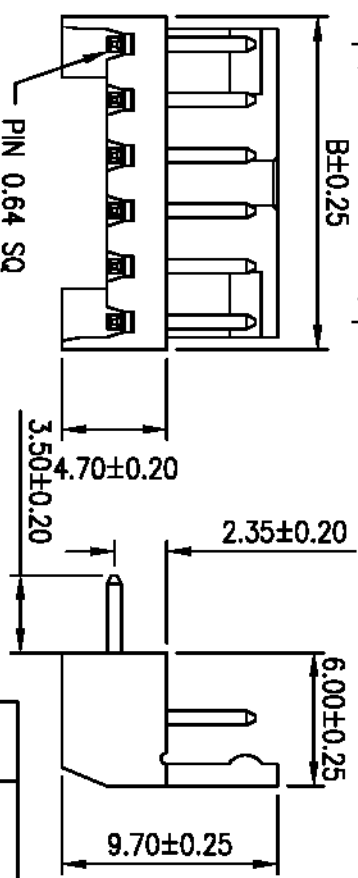
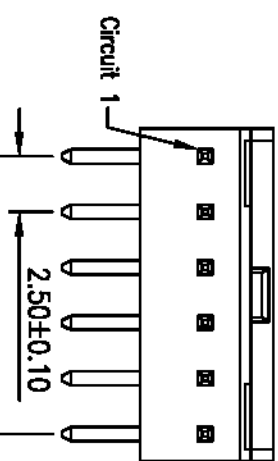

P.C.B. LAYOUT

Ordering information: Features:

YY-1250-WXXRX2

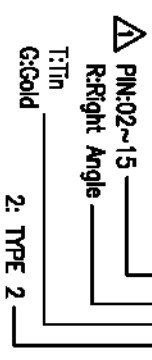

- * Available in 2 through 15 Circuits
- * Material: Nylon 66 UL94V-0
- * Mates with YY-1250-H Series Housing
- * 0.64mm(.025") Squard Pin
- * Pin Material: Brass/Tin-Plated

Specifications:

- * Pitch between poles 2.5mm
- * Rated Voltage 250V AC,DC
- * Rated Current 3A
- * Withstand Voltage 800V AC/minute
- * Insulation Resistance 1000M Ohms/Min
- * Temperature Range -25C~+85C



Circuits	Part No	Dimension mm	
		A	B
2	YY-1250-W02R	2.50	5.00
3	YY-1250-W03R	5.00	7.50
4	YY-1250-W04R	7.50	10.00
5	YY-1250-W05R	10.00	12.50
6	YY-1250-W06R	12.50	15.00
7	YY-1250-W07R	15.00	17.50
8	YY-1250-W08R	17.50	20.00

Circuits	Part No	Dimension mm	
		A	B
9	YY-1250-W09R	20.00	22.50
10	YY-1250-W10R	22.50	25.00
11	YY-1250-W04R	25.00	27.50
12	YY-1250-W05R	27.50	30.00
13	YY-1250-W06R	30.00	32.50
14	YY-1250-W07R	32.50	35.00
15	YY-1250-W08R	35.00	37.50

EDITION	DATE	MODIFY	VIEW	DRAW BY	AUDITING	APPROVAL	DATE	DWG NO	TOLERANCE
A0	2003.06.07	DRAWING		Andy He	JEFF	Jessica	2004.11.17	A2506WR2 152-A1	.0
A1	2004.11.17	CHANGE						YY-1250-WXXRX2	.00
									.000

YOUNG YAK ENTERPRISE CO.,LTD.
TEL:886-2-2999-9629
FAX:886-2-2999-0575

2.50mm (.098") Pitch Crimp Terminal

Features:

- * Mates with YY-1250-HXX Series Housing
- * Accepts AWG 22~28 wire Range
- * Insulation O.D.=1.90mm(max)
- * Material :Phosphor Bronze
- * Finish : Tin-plated
- * Qty/reel : 10,000 PCS

Specification:

- * Pitch between poles 2.5 mm
- * Rated Voltage 250V AC,DC
- * Rated Current 3A
- * Withstand Voltage 800V AC/minute
- * Insulation Resistance 1,000M ohms/Min
- * Temperature Range -25°C~+85°C

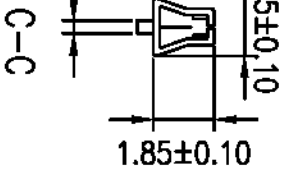
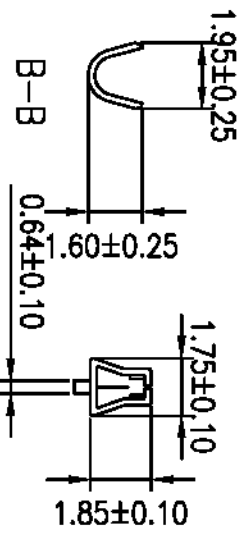
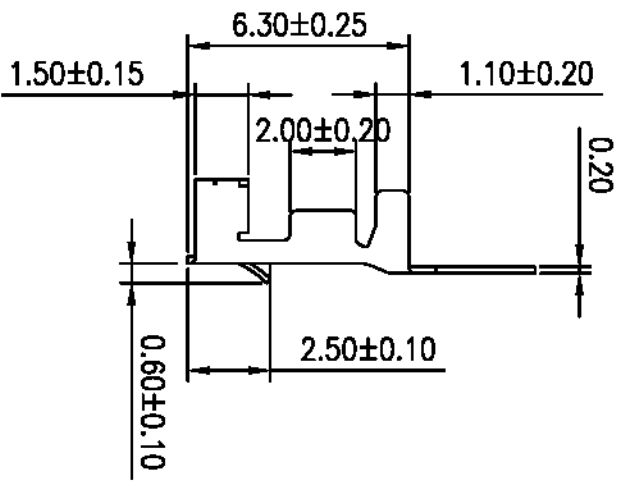
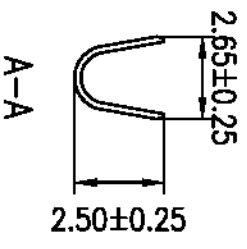
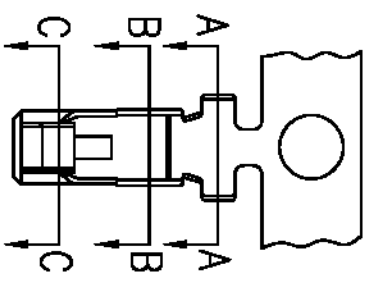

Ordering Information:

YY-1250-TXXX

- : Brass
- P: Phosphor bronze
- A: Plated before Stamping
- B: Stamping before Plated
- T: TIN
- G: GOLD

EDITION	DATE	MODIFY	VIEW			YOUNG YAK ENTERPRISE CO.,LTD. 殺耀實業股份有限公司 TEL:886-2-2999-9629 FAX:886-2-2999-0575	DRAW BY	AUDITING	APPROVAL	DATE	DWG NO	A2506T	TOLERANCE
A0	2003.05.17	DRAWING					Andy He	JEFF	Jessica	2003.05.17	YY-1250-TXXX	152-A0	.0