

**CRSH5-2 SERIES
CRSH5-2G* SERIES**

**SCHOTTKY BARRIER RECTIFIERS
5.0 AMP, 20 THRU 80 VOLTS**

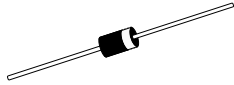

CASE DO-201AD

**CentralTM
Semiconductor Corp.**

DESCRIPTION:

The CENTRAL SEMICONDUCTOR CRSH5-2 Series types are 5.0 Amp, Glass Passivated Schottky Barrier Rectifiers mounted in axial lead epoxy cases using metal-to-silicon junctions to yield low forward voltage drops.

MARKING: FULL PART NUMBER

* Device is *Halogen Free* by design

MAXIMUM RATINGS: ($T_A=25^\circ\text{C}$ unless otherwise noted)

	SYMBOL	CRSH5						UNITS
		-2	-3	-4	-5	-6	-8	
		<u>-2G</u>	<u>-3G</u>	<u>-4G</u>	<u>-5G</u>	<u>-6G</u>	<u>-8G</u>	
Peak Repetitive Reverse Voltage	V_{RRM}	20	30	40	50	60	80	V
DC Blocking Voltage	V_R	20	30	40	50	60	80	V
RMS Reverse Voltage	$V_{R(RMS)}$	14	21	28	35	42	56	V
Average Forward Current ($T_L=100^\circ\text{C}$)	I_O				5.0			A
Peak Forward Surge Current	I_{FSM}				250			A
Operating and Storage								
Junction Temperature	T_J, T_{stg}			-65 to +150				$^\circ\text{C}$

ELECTRICAL CHARACTERISTICS: ($T_A=25^\circ\text{C}$ unless otherwise noted)

SYMBOL	TEST CONDITIONS	MIN	MAX	UNITS
I_R	$V_R=\text{Rated } V_{RRM}$		10	mA
I_R	$V_R=\text{Rated } V_{RRM}, T_A=100^\circ\text{C}$		100	mA
V_F	$I_F=5.0\text{A (20V, 30V, 40V)}$		0.57	V
V_F	$I_F=5.0\text{A (50V, 60V, 80V)}$		0.70	V

CASE DO-201AD - MECHANICAL OUTLINE

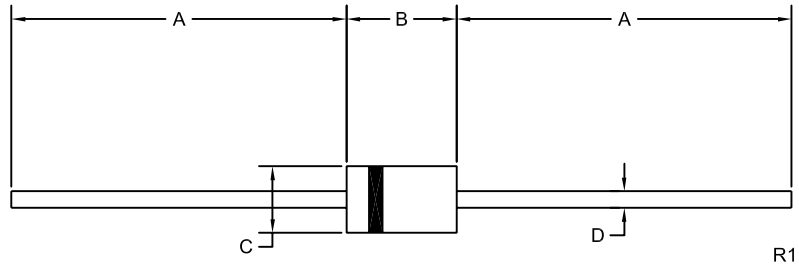

DIMENSIONS				
SYMBOL	INCHES		MILLIMETERS	
	MIN	MAX	MIN	MAX
A	1.000	-	25.40	-
B	0.283	0.375	7.20	9.53
C	0.189	0.210	4.80	5.33
D	0.047	0.052	1.20	1.32

DO-201AD (REV: R1)

MARKING: FULL PART NUMBER

OUTSTANDING SUPPORT AND SUPERIOR SERVICES



PRODUCT SUPPORT

Central's operations team provides the highest level of support to insure product is delivered on-time.

- Supply management (Customer portals)
- Inventory bonding
- Consolidated shipping options
- Custom bar coding for shipments
- Custom product packing

DESIGNER SUPPORT/SERVICES

Central's applications engineering team is ready to discuss your design challenges. Just ask.

- Free quick ship samples (2nd day air)
- Online technical data and parametric search
- SPICE models
- Custom electrical curves
- Environmental regulation compliance
- Customer specific screening
- Up-screening capabilities
- Special wafer diffusions
- PbSn plating options
- Package details
- Application notes
- Application and design sample kits
- Custom product and package development

REQUESTING PRODUCT PLATING

1. If requesting Tin/Lead plated devices, add the suffix "TIN/LEAD" to the part number when ordering (example: 2N2222A TIN/LEAD).
2. If requesting Lead (Pb) Free plated devices, add the suffix "PBFREE" to the part number when ordering (example: 2N2222A PBFREE).

CONTACT US

Corporate Headquarters & Customer Support Team

Central Semiconductor Corp.
145 Adams Avenue
Hauppauge, NY 11788 USA
Main Tel: (631) 435-1110
Main Fax: (631) 435-1824
Support Team Fax: (631) 435-3388
www.centrasemi.com

Worldwide Field Representatives:
www.centrasemi.com/wwreps

Worldwide Distributors:
www.centrasemi.com/wwdistributors

For the latest version of Central Semiconductor's **LIMITATIONS AND DAMAGES DISCLAIMER**, which is part of Central's Standard Terms and Conditions of sale, visit: www.centrasemi.com/terms