

THIS DRAWING CONTAINS INFORMATION PROPRIETARY TO POSITRONIC AND ITS SUBSIDIARIES. POSITRONIC BELIEVES THE DATA ON THIS DRAWING TO BE RELIABLE, SINCE THE TECHNICAL INFORMATION IS GIVEN FREE OF CHARGE, THE USER EMPLOYS SUCH INFORMATION AT HIS OWN DISCRETION AND RISK. POSITRONIC ASSUMES NO RESPONSIBILITY FOR RESULTS OBTAINED OR DAMAGES INCURRED FROM USE OF SUCH INFORMATION IN WHOLE OR IN PART.

DATE	REV	REVISION RECORD	APP	DR	CK
9-8-08	NC	ECO 29929	TK	YK	COLE

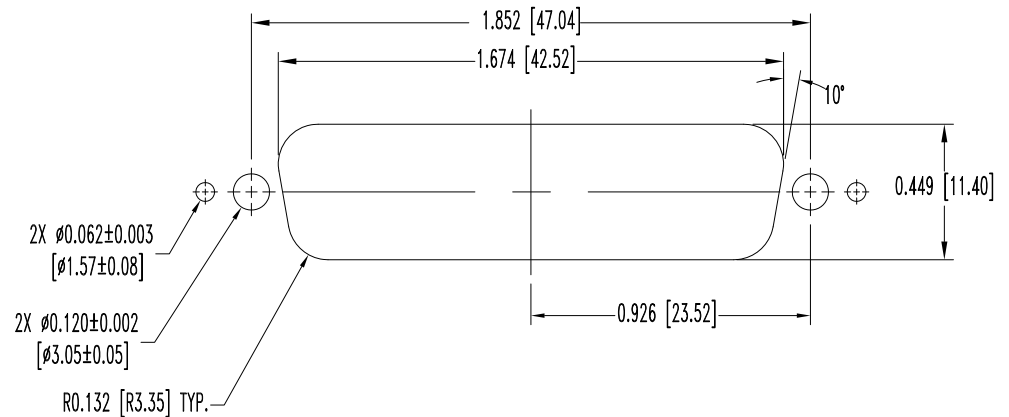
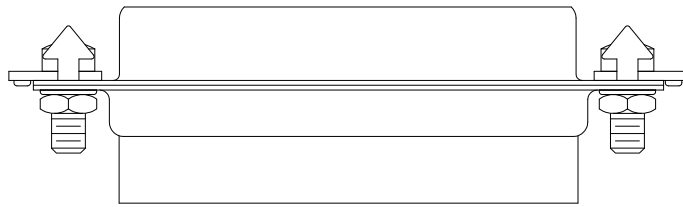
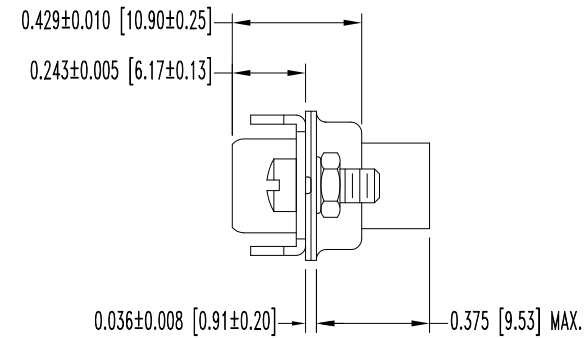
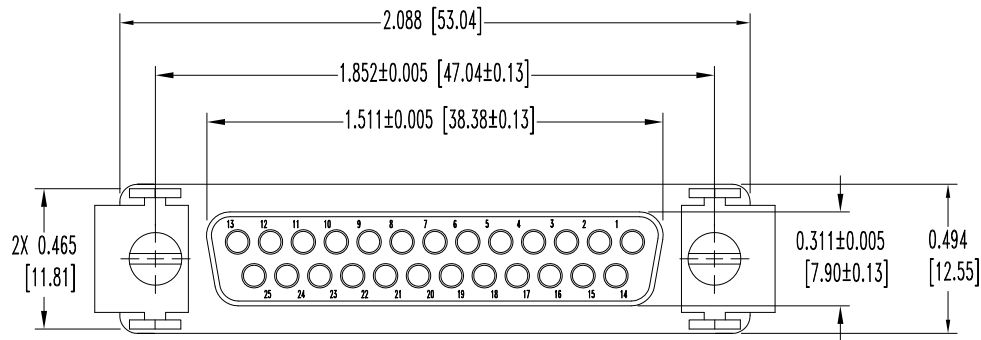

PANEL CUTOUT

NOTES:

1. MATERIALS AND FINISHES:

INSULATOR: GLASS FILLED DAP PER ASTM-D-5948, SDG-F, UL 94V-0, GREEN COLOR.  
 CONTACTS: PRECISION MACHINED HIGH TENSILE COPPER ALLOY WITH STAINLESS STEEL SHROUD, GOLD FLASH OVER NICKEL FINISH.

SHELLS: STEEL, ZINC PLATE WITH CHROMATE SEAL.  
 LOCK TAB: STEEL, NICKEL PLATE.  
 LOCKWASHERS: BRONZE, ZINC PLATE WITH CHROMATE SEAL.  
 HEX NUTS: BRASS, ZINC PLATE WITH CHROMATE SEAL.  
 SCREWS: BRASS, ZINC PLATE WITH CHROMATE SEAL.

2. ELECTRICAL CHARACTERISTICS:

CONTACT CURRENT RATING: 7.5 AMPS NOMINAL.  
 INITIAL CONTACT RESISTANCE: 0.005 OHMS MAXIMUM.  
 INSULATOR RESISTANCE: 5 G OHMS.  
 WORKING VOLTAGE: 300 V r.m.s.

3. WORKING TEMPERATURE: -55°C TO +125°C.

4. DIMENSIONS ARE IN INCHES [MILLIMETERS].

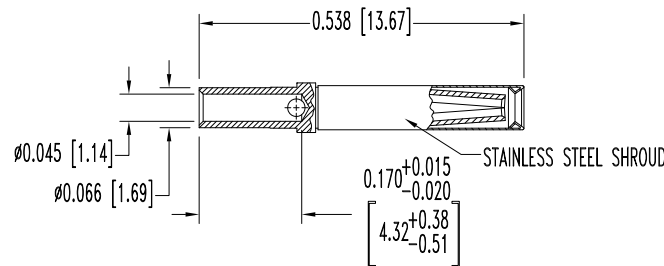

25X FEMALE CONTACT

ENLARGED

	<b>POSITRONIC INDUSTRIES INC.</b> www.connectpositronic.com		FSCM 28198
	DECIMAL TOL. ± 0.015 [0.38]	RD SERIES	SCALE N.T.S.
ANGULAR TOL. ± 5°	DATE 9-8-08	DRAWING NUMBER SK9675	APPROVED BY T KEPLEY
TITLE <b>RD25F100V50</b>			