

2.00mm pitch Female Header
 - THT - 6.35mm profile

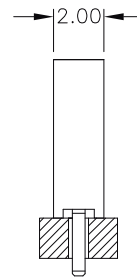

single row

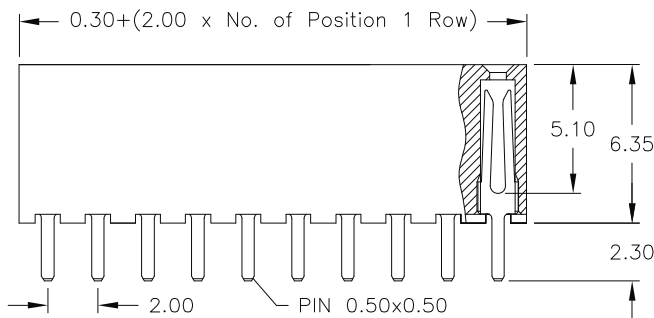
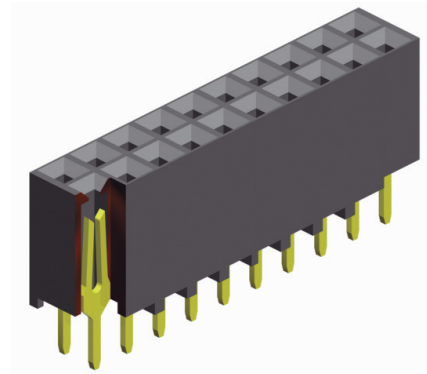
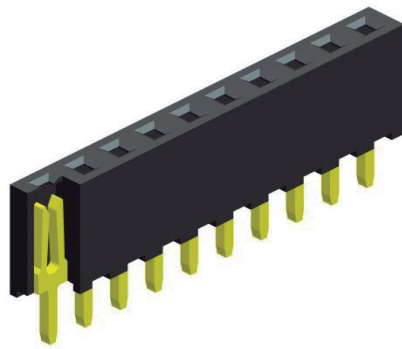
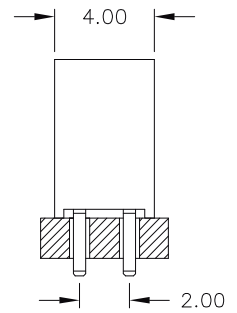

dual row

APPLICATION AND FEATURES

- For board-to-board connections
- Ideal solution for PC/104 Systems
- Accepts 0.50mm square pins
- Hi-rel fork contact design

PCB Hole Layout

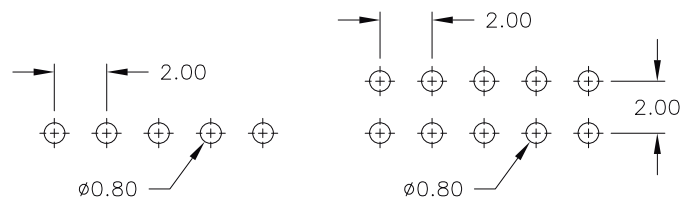

SPECIFICATIONS

Current rating	1 A
Insulator resistance	1000 MΩ min.
Contact resistance	20 mΩ max.
Withstanding voltage	500 V AC

Operating temperature	- 40°C to +105°C
Contact material	(RoHS compliant) Copper Alloy
Insulator material	(RoHS compliant) LCP UL 94 V-0

How to order

BL x - xxx - SH635 - 55 /2

