

P.C.B. LAYOUT

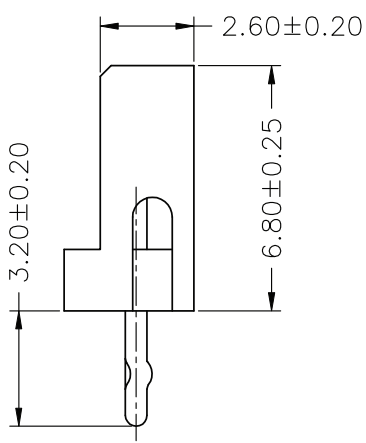
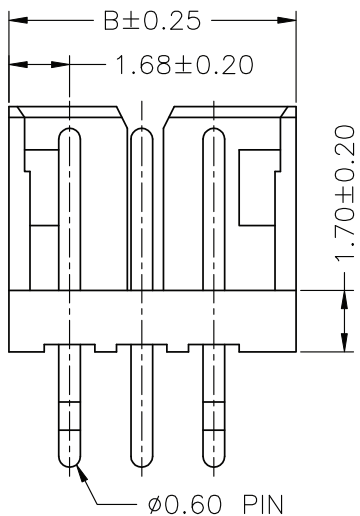

No. of Positions	Dimensions	
	A	B
2	2.00	5.96
3	4.00	7.96
4	6.00	9.96
5	8.00	11.96
6	10.00	13.96
7	12.00	15.96
8	14.00	17.96
9	16.00	19.96
10	18.00	21.96
11	20.00	23.96
12	22.00	25.96
13	24.00	27.96
14	26.00	29.96
15	28.00	31.96

ELECTRICAL:

CURRENT RATING: 1 A AC,DC
 VOLTAGE RATING: 100V AC,DC
 TEMPERATURE RANGE: -25°C TO +85°C
 CONTACT RESISTANCE: 20mΩ (Max.)
 INSULATOR RESISTANCE: 1000 MΩ Min.
 WITHSTANDING VOLTAGE: 800V AC (1 Min.)

MATERIAL:

NYLON 66,UL94V-0
 PIN MATERIAL: COPPER ALLOY / TIN PLATED

HOW TO ORDER:

W 0 3 2 - X X 1 1 - 0 0 1 - Z

OF POSITIONS:
 2 thru 15

**RoHS
 COMPLIANT**

Rev		Drawn	Checked	Approved	Date	SMP TECHNOLOGY, INC.
0	Issued	B.S.	S.M.	S.M.	3/21/07	
SCALE						Header, AMP CT Type, Vertical Thru Hole
TOL. DEC.	.X +/- 0.2	.XX +/-	.XXX +/-	ANGLE +/-	UNIT: mm	P/N: W032-XX11-001-Z Pg: 1