

1 : PC CONNECTOR

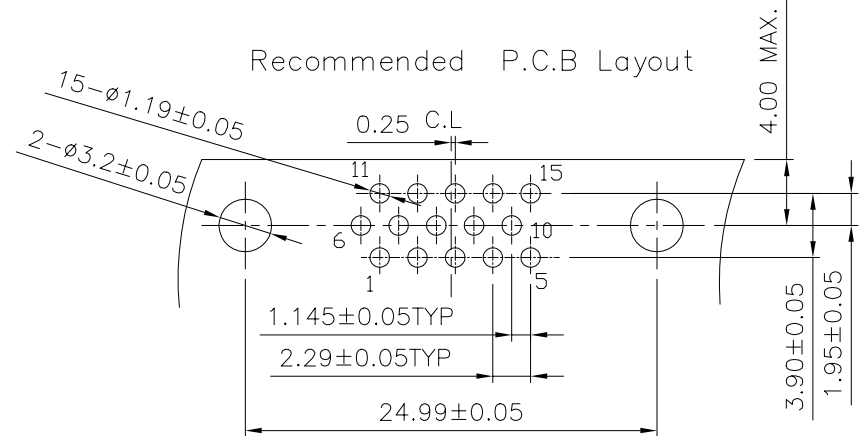

NOTE:  
070207FR015□□20CA

1. Selective plating  
S1-05u"Min. Gold in contact area/  
100u"Min. Tin in solder area.
- S2-Gold flash in contact area/  
100u"Min. Tin in solder area.
- S3-10u"Min. Gold in contact area/  
100u"Min. Tin in solder area.
- S4-15u"Min. Gold in contact area/  
100u"Min. Tin in solder area.
- S5-30u"Min. Gold in contact area/  
100u"Min. Tin in solder area.
- S6-50u"Min. Gold in contact area/  
100u"Min. Tin in solder area.

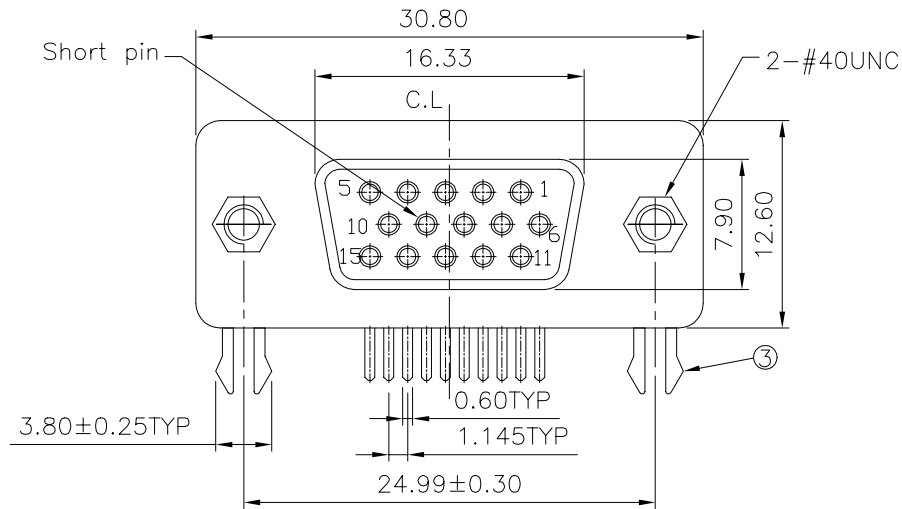
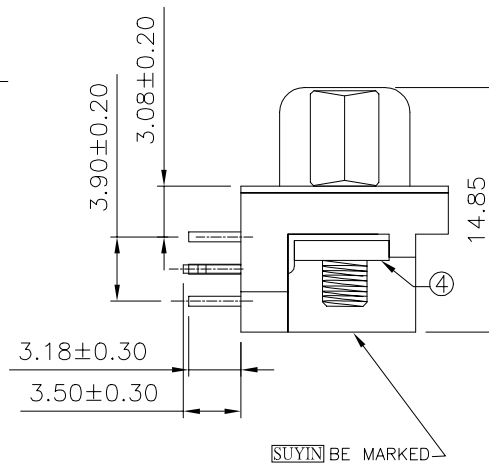
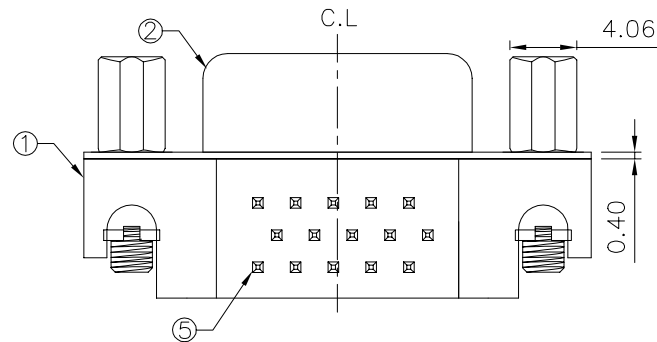

NO.	DESCRIPTION	MATERIAL	COLOR	REMARK
5	Terminal	Pho. Bronze	—	Selective Gold/Tin
4	Rivet	Brass	—	Nickel Plated
3	Fork	Brass	—	Nickel Plated
2	Shell	SPCC	—	Nickel Plated
1	Plastic	PBT	BLUE(6610)	UL94V-0

**SUYIN**  
CONNECTOR

CUSTOMER COPY	TITLE: 15 PIN D-SUB CONNECTOR FEMALE R/A TYPE
PART NO.	070207FR015SX20CA
PART NO.(OLD)	—
DRAWING NO. D/ING	070207FR015SX20CA
SCALE	1:1
UNIT	mm
A4	⊕

ECN(DCN) NO.	REV	DATE	DESCRIPTION	CHANGE	APPRO.	GENERAL TOLERANCE UNLESS OTHERWISE NOTED	APPRO.
	0		NEW			Angle ±2° 30 ~ ±0.50 10 ~ 30 ±0.30 ~ 10 ±0.15	DRAW DESIGN CHECK APPRO.