

PART NO. SEE CHART
DWG. NO. SDA-3246-N

- NOTES:
 1. PRODUCT SPEC. 08-50 APPLIES.
 2. PIN PUSH OUT FORCE (1.3 Kg)/3 LBS. MIN.
 3. PIN MUST CONFORM TO MOLEX SOLDERABILITY SPEC. No. 152.
 4. THIS PART CONFORMS TO MOLEX PROD.SPEC.99020-0087

SDA-3246-N * - *
 BASE No. _____ VOID PIN LOCn.
 No. OF CKTS. _____ ASSY. VERSION

(3.96 ± 0.1) NON-ACCUM.
 $.156 \pm .004$

$\phi (1.83 \pm 0.05)$
 $.072 \pm .002$

RECOMMENDED PCB HOLE DIMENSIONS

CKTS.	DIMN. A	DIMN. B
2	(3.96) .156	(7.92) .312
3	(7.92) .312	(11.89) .468
4	(11.89) .468	(15.85) .624
5	(15.85) .624	(19.81) .780
6	(19.81) .780	(23.77) .936
7	(23.77) .936	(27.74) 1.092
8	(27.74) 1.092	(31.70) 1.248
9	(31.70) 1.248	(35.66) 1.404
10	(35.66) 1.404	(39.62) 1.560
11	(39.62) 1.560	(43.59) 1.716
12	(43.59) 1.716	(47.55) 1.872
13	(47.55) 1.872	(51.51) 2.028
14	(51.51) 2.028	(55.47) 2.184
15	(55.47) 2.184	(59.44) 2.340
16	(59.44) 2.340	(63.40) 2.496
17	(63.40) 2.496	(67.36) 2.652
18	(67.36) 2.652	(71.32) 2.808
19	(71.32) 2.808	(75.29) 2.964
20	(75.29) 2.964	(79.25) 3.120

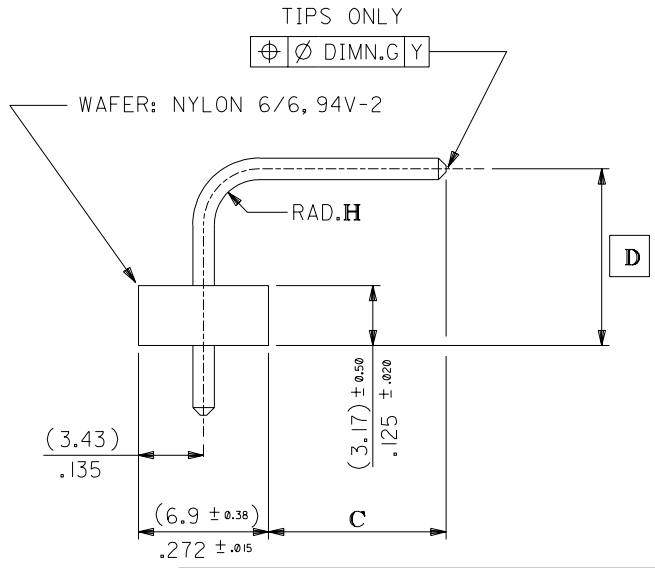
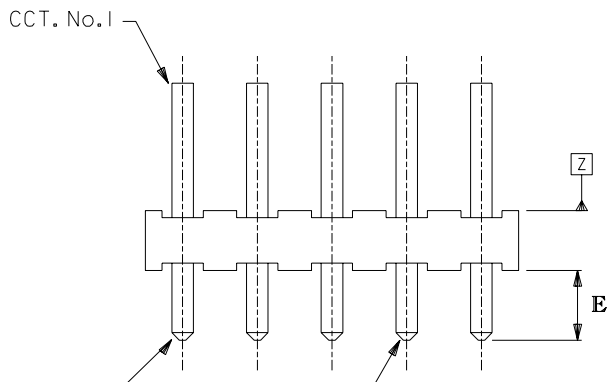
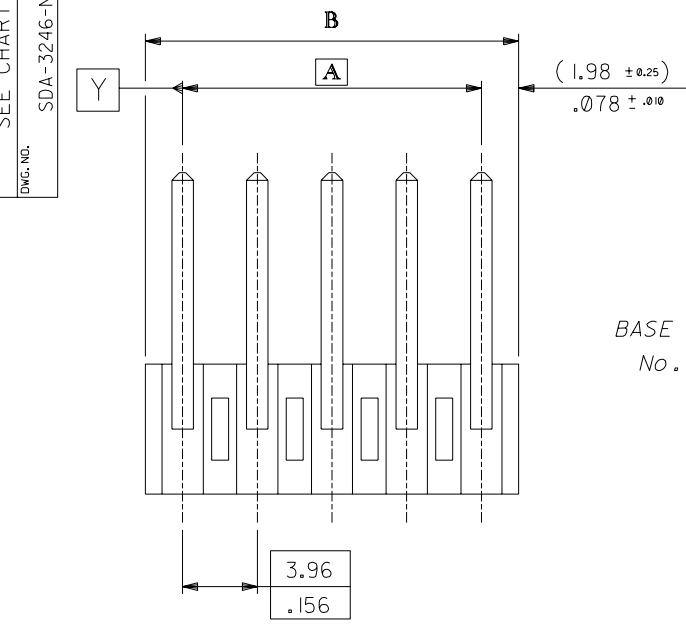

(1.14)/.045 SQ. BRASS WIRE PIN,
 FOR PLATING SEE CHARTS.

FOR PREVIOUS DRAWING ISSUES SEE MRI.

NEW PROD. SPEC. 99020-0087 ADDED EC NO. E2003-0992 DRWN: PSHEAHAN 03/05/29 CHK: / / / APPR: / / / P	QUALITY SYMBOLS MAJOR = CRITICAL =	GENERAL TOLERANCES: (UNLESS SPECIFIED) 4 PLACES ±0. $\frac{mm}{inch}$ 3 PLACES ±0. $\frac{mm}{inch}$ 2 PLACES ±0.25 $\frac{mm}{inch}$ 1 PLACE ±0.35 $\frac{mm}{inch}$ ANGULAR: ± °		SCALE 15:4 DESIGN UNITS <input checked="" type="checkbox"/> mm <input type="checkbox"/> INCH DRAWN BY & DATE MC 18/9 /86 CHECKED BY & DATE APPROVED BY & DATE	DIMENSIONS: <input checked="" type="checkbox"/> mm <input type="checkbox"/> INCH <input type="checkbox"/> mm <input type="checkbox"/> INCH ONLY SHT 3 REV N REVISE ON CAD ONLY
	DESCRIPTION TITLE: 3.96MM KK HDR RT SQPIN VRA	MOLEX INCORPORATED		CAD FILENAME SA3246x1 DGN MATERIAL NO. SEE CHART DRAWING NO. SDA-3246-N SHEET NO. 1 OF 3	
	DRAFT WHERE APPLICABLE MUST REMAIN WITHIN DIMENSIONS		THIS DRAWING CONTAINS INFORMATION THAT IS PROPRIETARY TO MOLEX INCORPORATED AND SHOULD NOT BE USED WITHOUT WRITTEN PERMISSION.		
	DIMENSIONS: mm INCH mm ONLY		DIMENSIONS: mm INCH mm ONLY		

PART NO. SEE CHART
DWG. NO. SDA-3246-N

DIMn. C
DIMn. D
DIMn. E
DIMn. F
DIMn. G
DIMn. H
CKTS.
2
3
4
5
6
7
8
9
10
11
12
13
14
15
16
17
18
19
20
PLTG. TO E.S. 88

A-3246-NA	
(11.17±0.80) / .440±.030	
(8.03) / .316	
(3.96±0.35) / .156±.015	
(0.38) / .015 DIA	
(0.80) / .031 DIA	
(2.36±0.25) / .093±.010	
PART NO	ENG NO
26-10-2021	A-3246-2A
↑ 2031	↑ 3A
2041	4A
2051	5A
2061	6A
2071	7A
2081	8A
2091	9A
2101	10A
2111	11A
2121	12A
2131	13A
2141	14A
2151	15A
2161	16A
2171	17A
2181	18A
↓ 2191	↓ 19A
26-10-2201	A-3246-20A
ELECTRO-TIN (5u) / .0002 MIN. OVER (2.5u) / .0001 COPPER	

A-3246-NAG	
(11.17±0.80) / .440±.030	
(8.03) / .316	
(3.96±0.35) / .156±.015	
(0.38) / .015 DIA	
(0.80) / .031 DIA	
(2.36±0.25) / .093±.010	
PART NO	ENG NO
26-28-2021	A-3246-2AG
↑ 2031	↑ 3AG
2041	4AG
2051	5AG
2061	6AG
2071	7AG
2081	8AG
2091	9AG
2101	10AG
2111	11AG
2121	12AG
2131	13AG
2141	14AG
2151	15AG
2161	16AG
↓ 2171	↓ 17AG
26-28-2181	18AG
26-28-2191	19AG
26-28-2201	A-3246-20AG
GOLD (0.51u) / .00002 MIN. OVER NICKEL (0.76u) / .00003 MIN.	

A-3246-ND	
(2.34±0.38) / .092±.015	
(8.55) / .337	
(12.95±0.38) / .510±.015	
(0.51) / .020 DIA	
(0.80) / .031 DIA	
(2.36±0.25) / .093±.010	
PART NO	ENG NO
38-00-0302	A-3246-2D
↑ 0303	↑ 3D
0304	4D
0305	5D
0306	6D
0307	7D
0308	8D
0309	9D
0310	10D
0311	11D
0312	12D
0313	13D
0314	14D
0315	15D
0316	16D
0317	17D
0318	18D
↓ 0319	↓ 19D
38-00-0320	A-3246-20D
ELECTRO-TIN (5u) / .0002 MIN. OVER (2.5u) / .0001 COPPER	

A-3246-NK	
(11.87±0.38) / .467±.015	
(6.60) / .260	
(3.2±0.35) / .125±.015	
(0.38) / .015 DIA	
(0.80) / .031 DIA	
(2.36±0.25) / .093±.010	
PART NO	ENG NO
NT	A-3246-2K
↑	↑ 3K
	4K
	5K
	6K
	7K
↓	8K
NT	9K
38-00-1590	10K
NT	11K
↑	12K
	13K
	14K
	15K
	16K
	17K
	18K
↓	19K
NT	A-3246-20K
ELECTRO-TIN (5u) / .0002 MIN. OVER (2.5u) / .0001 COPPER	

A-3246-NL	
(13.18±0.38) / .519±.015	
(6.92) / .272	
(3.3±0.38) / .130±.015	
(0.38) / .015 DIA	
(0.80) / .031 DIA	
(2.36±0.25) / .093±.010	
PART NO	ENG NO
NT	A-3246-2L
↑	↑ 3L
	4L
	5L
↓	6L
NT	7L
38-00-1111	8L
↑	9L
	10L
	11L
	12L
	13L
	14L
	15L
	16L
	17L
	18L
↓	19L
NT	A-3246-20L
ELECTRO-TIN (5u) / .0002 MIN. OVER (2.5u) / .0001 COPPER	

15	26-10-4152	A-3246-15A-51	2,4,6,8,10,12 & 14
8	↑ 4082	↑ 8A-51	3
7	↓ 4072	7A-51	2,4 & 6
5	26-10-4052	5A-2	2
4	38-00-0549	4A-3	3
4	38-00-0885	A-3246-4A-2	2
CKTS	A-3246-NA- * "NA" VOID VERSIONS		VOID LOCATION

FOR PREVIOUS DRAWING ISSUES SEE MRI.

NEW P/N 26-28-2191 & 26-28-2201 ADDED
 EC NO. E2003-0928
 DRAWN: PSHEAHAN 03/03/06
 CHK: / / / /
 APPR: / / / /
 REV N

QUALITY SYMBOLS
 MAJOR
 CRITICAL

GENERAL TOLERANCES: (UNLESS SPECIFIED)
 4 PLACES ±0. mm ±. INCH
 3 PLACES ±0. mm ±.010 INCH
 2 PLACES ±0.25 mm ±.014 INCH
 1 PLACE ±0.35 mm ±. INCH
 ANGULAR: ± °
 DRAFT WHERE APPLICABLE MUST REMAIN WITHIN DIMENSIONS

SCALE DESIGN UNITS
 mm INCH
 DRAWN BY & DATE MCC 19/9 /86
 CHECKED BY & DATE
 APPROVED BY & DATE
 CAD FILENAME S43246X2 DGN

THIRD ANGLE PROJECTION
 mm INCH mm ONLY INCH ONLY
 TITLE: 3.96MM KK HDR RA SQPIN VRA
 MOLEX INCORPORATED
 MATERIAL NO. SEE CHART
 DRAWING NO. SDA-3246-N
 SHEET NO. 2 OF 2

THIS DRAWING CONTAINS INFORMATION THAT IS PROPRIETARY TO MOLEX INCORPORATED AND SHOULD NOT BE USED WITHOUT WRITTEN PERMISSION.
 SIZE B