

•Dimensions C and D

Part NO.	C	D
FFC-(1~52) AMEP ( ) (B)	6	2.5
FFC-(1~52) T AMEP ( ) (B)	10.86	2.5
FFC-(1~52) T1 AMEP ( ) (B)	5.84	3.43
FFC-(1~52) T2 AMEP ( ) (B)		12.7
FFC-(1~52) T3 AMEP ( ) (B)	5.72	17.78
FFC-(1~52) T4 AMEP ( ) (B)		5.08
FFC-(1~52) T5 AMEP ( ) (B)		20.32
FFC-(1~52) T6 AMEP ( ) (B)	6	3
FFC-(1~52) T7 AMEP ( ) (B)	5.72	2.54
FFC-(1~52) T8 AMEP ( ) (B)		10.16
FFC-(1~52) T9 AMEP ( ) (B)	5	
FFC-(1~52) T10 AMEP ( ) (B)	7	2.5
FFC-(1~52) T11 AMEP ( ) (B)	8.54	
FFC-(1~52) T12 AMEP ( ) (B)	9.5	4
FFC-(1~52) T13 AMEP ( ) (B)	5.84	
FFC-(1~52) T14 AMEP ( ) (B)	7.5	3.43
FFC-(1~52) T15 AMEP ( ) (B)	1.8	1.7
FFC-(1~52) T16 AMEP ( ) (B)	15.4	1.11
FFC-(1~52) T17 AMEP ( ) (B)	40	
FFC-(1~52) T18 AMEP ( ) (B)	7.5	2
FFC-(1~52) T19 AMEP ( ) (B)	7.56	
FFC-(1~52) T20 AMEP ( ) (B)	6.06	1.4
FFC-(1~52) T21 AMEP ( ) (B)	7.06	
FFC-(1~52) T22 AMEP ( ) (B)	8.56	
FFC-(1~52) T23 AMEP ( ) (B)	9.56	
FFC-(1~52) T24 AMEP ( ) (B)	9.7	2.5
FFC-(1~52) T25 AMEP ( ) (B)	3.72	15.78
FFC-(1~52) T26 AMEP ( ) (B)	3.86	2.5
FFC-(1~52) T27 AMEP ( ) (B)	3	2.5
FFC-(1~52) T28 AMEP ( ) (B)	7	4
FFC-(1~52) T29 AMEP ( ) (B)	25	2
FFC-(1~52) T30 AMEP ( ) (B)	10	2.5

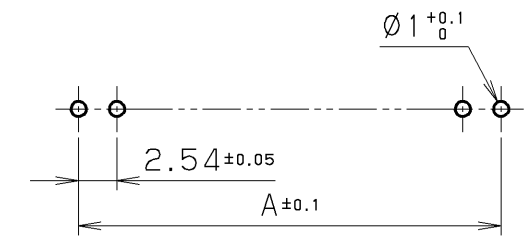

△ RECOMMENDED P. C. B. LAYOUT

•Dimensions A and B

No. of contacts (n)	A	B
1		2.54
2	2.54	5.08
3	5.08	7.62
4	7.62	10.16
5	10.16	12.7
6	12.7	15.24
7	15.24	17.78
8	17.78	20.32
9	20.32	22.86
10	22.86	25.4
11	25.4	27.94
12	27.94	30.48
13	30.48	33.02
14	33.02	35.56
15	35.56	38.1
16	38.1	40.64
17	40.64	43.18
18	43.18	45.72
19	45.72	48.26
20	48.26	50.8
21	50.8	53.34
22	53.34	55.88
23	55.88	58.42
24	58.42	60.96
25	60.96	63.5
26	63.5	66.04

No. of contacts (n)	A	B
27	66.04	68.58
28	68.58	71.12
29	71.12	73.66
30	73.66	76.2
31	76.2	78.74
32	78.74	81.28
33	81.28	83.82
34	83.82	86.36
35	86.36	88.9
36	88.9	91.44
37	91.44	93.98
38	93.98	96.52
39	96.52	99.06
40	99.06	101.6
41	101.6	104.14
42	104.14	106.68
43	106.68	109.22
44	109.22	111.76
45	111.76	114.3
46	114.3	116.84
47	116.84	119.38
48	119.38	121.92
49	121.92	124.46
50	124.46	127
51	127	129.54
52	129.54	132.08

NOTE 1.  
PART NO.

FFC-52T1AMEP1B

Series prefix: FFC  
 Number of contacts: 52  
 Pin length variation (Leave blank for standard version): T1  
 Insulator color: 1B  
 Contact plating: AMEP

Blank:Gold 0.7 μm over nickel  
 1:Gold 0.2 μm over nickel  
 2:TIN/LEAD 3μm over copper  
 8:Gold 0.38μm over nickel  
 9:Gold 0.1 μm over nickel  
 11:Gold 0.05μm over nickel  
 △21:TIN/COPPER 1μm over nickel

△	Oct.13 2006	M.Miyazaki	Add Part.						
△	Aug.10 2004	M.Miyazaki	Add Part.						
△	May.14 2004	M.Miyazaki	Add Part.						
△	Apr.13 2004	M.Miyazaki	Add P.C.B. Layout	2	Contact	Phosphor Bronze	n	Note1	
△	Dec.10 2003	M.Miyazaki	Add Part.	1	Insulator	Nylon66	1		UL94V-0 NOTE1

LTR.	DATE	BY	REV.	DESCRIPT	No.	PART NAME	MATERIAL	QTY	FINISH	NOTE	
	MAR.25.1998										
DATE: MAR.25.1998						SCALE: 2/1		UNIT: mm (INCH)		3RD. A. P	
APP. DATE&REV.						HONDA TSUSHIN KOGYO CO., LTD.					
DR.	DE.	CHK.	CHK.	APP.	NAME		MALE CONNECTOR				
M. MIYAZAKI	M. MIYAZAKI		C. NUNOKAWA	H. EBIHARA	PART NO.		FFC-(n) (T) AMEP ( ) (B)				
										REV. 4E	