

Dimensions					
Circuits (x2 for dual row)	L1	L2	Circuits (x2 for dual row)	L1	L2
2	2.54	5.08	22	53.34	55.88
3	5.08	7.62	23	55.88	58.42
4	7.62	10.16	24	58.42	60.96
5	10.16	12.70	25	60.96	63.50
6	12.70	15.24	26	63.50	66.04
7	15.24	17.78	27	66.04	68.58
8	17.78	20.32	28	68.58	71.12
9	20.32	22.86	29	71.12	73.66
10	22.86	25.40	30	73.66	76.20
11	25.40	27.94	31	76.20	78.74
12	27.94	30.48	32	78.74	81.28
13	30.48	33.02	33	81.28	83.82
14	33.02	35.56	34	83.82	86.36
15	35.56	38.10	35	86.36	88.90
16	38.10	40.64	36	88.90	91.44
17	40.64	43.18	37	91.44	93.98
18	43.18	45.72	38	93.98	96.52
19	45.72	48.26	39	96.52	99.06
20	48.26	50.80	40	99.06	101.60
21	50.80	53.34			

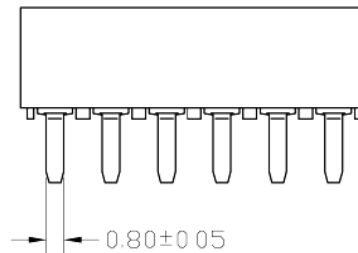

SPECIFICATIONS

Current rating: 3 amps
 Contact material: Phosphor bronze
 Contact resistance: 20 milliohms max.
 Insulator material: PBT or Nylon66. UL94V-0
 Insulator resistance: 5,000 megohms min.
 Withstanding: 500VAC for 1 min.
 Operating temperature: -40°C to +105°C

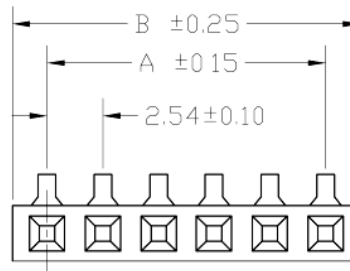
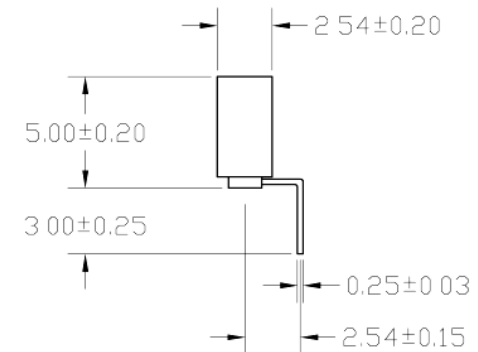

Dimensions (mm)	
A	No. pos. -1 X 2.54"
B	No. pos X 2.54+ 0.50"

RoHS compliant

Series	Rows	Type	Positions	Plating
ARS	01	BE	XX	XX
0.100 receptacle strip	01=single row 02=dual row	BE=Bottom entry	2-40	TN=Tin SGXX=Selective gold GDXX=Gold XX=Flash if blank; 10, 15, 30μ"

Rev.	Description	Date	Approved	Drawing	Name	Date
				Approved	Howard	08/10/99
				Checked	Lizzy	08/10/99
				Drawn	Tina	08/10/99
				0.0 ± 0.35	0.00 ± 0.20	Angles ± 3'
				UNIT: mm		

Central Components Manufacturing
 440 Lincoln Blvd., Middlesex, New Jersey 08846
 Phone 732 469-5720 888 288-5152 Fax 732 469-1919

Part No.: **ARS-01-BE-XX-XX**

Description: Single row receptacle strip, bottom entry