

*** 1086 Series ***

Material :

* Insulator : Thermoplastic UL 94V-0

* Contact : Brass

* Plating : Tin

Ordering information:

1086P**00**
1 2

1.No.of circuits

2.Base color:

01=black

11=grey

13=ivory

RoHS COMPLIANT

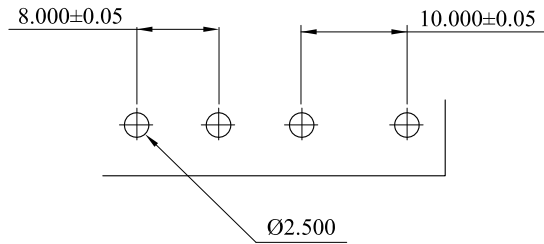

RECOMMENDED HOLE PATTERN

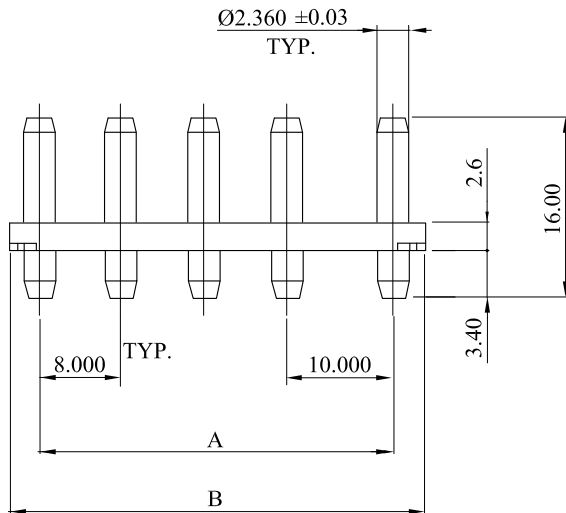

CIRCUITS	DIMENSION	
	A	B
2	10.00±0.20	16.00±0.30
3	18.00±0.20	24.00±0.30
4	26.00±0.30	32.00±0.40
5	34.00±0.30	40.00±0.40
6	42.00±0.30	48.00±0.40

F	ES101209			LEOCO CORPORATION	APPROVED:	PART NO.:						
E	ES070803				GENERAL TOLERANCES: (UNLESS SPECIFIED)	DATE:	1086P**00**					
D	ES031004			mm		inch	CHECKED:	TITLE:				
C	ES000313			1 PLACE	± 0.30	± --	DATE:	HEADER				
B	DWG REL			2 PLACES	± 0.20	± .012	DRAWN:	DRAWING NO.:				
REV.	ECO. NO.	CHG.	APP.	3 PLACES	± 0.10	± .008	DATE:	108604S				
				4 PLACES	± --	± .004		UNITS	SCALE	SIZE	SHEET	REV.
				ANGULAR ± (1°)		mm/inch		2:1	A4	1/1	F	