

PRODUCT NUMBER	N° OF POS.	DIM "C"	DIM "D"
77331-Y04	04	7.62/.300	11.92/.469
77331-Y05	05	10.16/.400	14.46/.569
77331-Y06	06	12.70/.500	17.00/.669

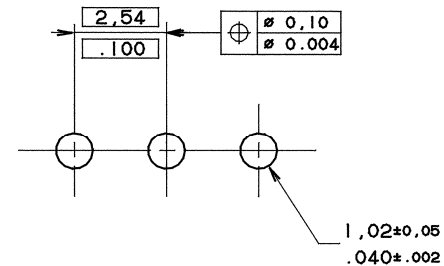
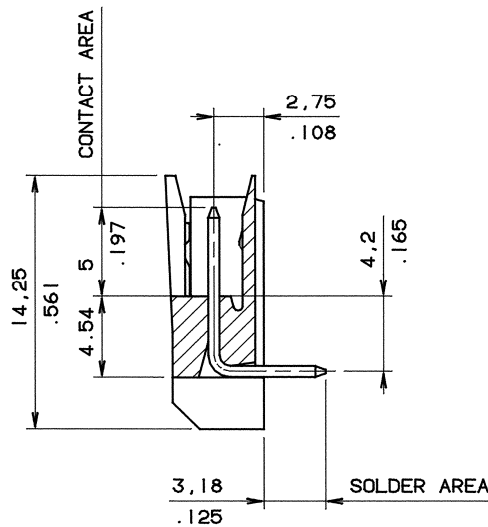
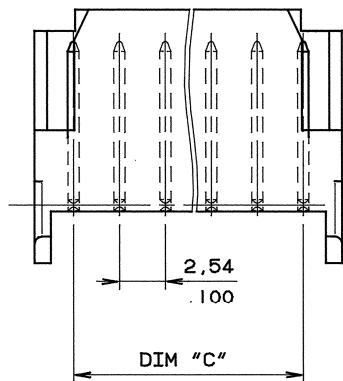
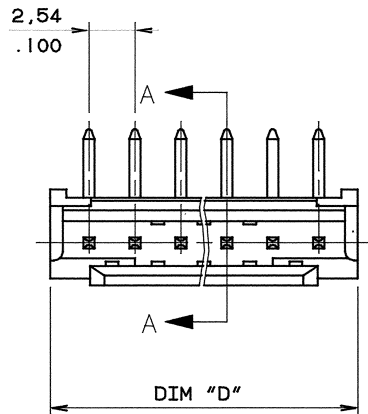

RECOMMENDED HOLE PATTERN

NOTES :

- 1 - MATERIAL BODY : THERMOPLASTIC POLYESTER , 30% GLASS FILLED COLOUR BLUE , FLAME RETARDANT PER UL-94-V0 ;
- MATERIAL PINS : PHOSPHOR BRONZE 3/4 HARD .
- 2 - MINIMUM PUSH-OUT FORCE : 22 NEWTONS .
- 3 - SEE TABLE FOR DIM "C" AND "D"

77331-4XX	4 μm 160 μm	SnPb MIN. OVER	1.3 μm 50 μm	Nt MIN .	SnPb OVER Nt
77331-3XX	0.75 μm 30 μm	Au MIN. OVER	1.3 μm 50 μm	Nt MIN .	SnPb OVER Nt
PLATING CODE	CONTACT AREA		SOLDER TAIL		
	PLATING EXPLANATION				

SECTION A-A

REDRAWN

CAD CUSTOMER COPY FOR REFERENCE ONLY

SURFACE	TOLERANCE	MATL CODE	FINISH
ISO 1302	ISO 406 ISO 1101	SEE NOTE 1	SEE TABLE
<input checked="" type="checkbox"/>		SCALE 5:1	HEATTREAT
		DATE	NAME
		DR 89 10 13	J L CORDIER
		CHR 89 10 13	M RENAUD
		APPD 89 10 13	J M P
		TITLE	
		DX SR SHIELDED RA HEADER SPECIAL	
		DWG N	REV LTR SHEET
		77331	B 213
			1 OF 1
B F 00476	90 09 03	JLC	
A 6237	85 04 23	LNA	
L ECP N	DATE	DR	SUPSD BY

DU PONT ELECTRONICS SUPERSEDES

RELEASE N 2195