

Bestückungsplan - contact layout

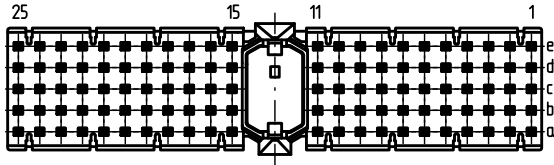

■ bestückt - assemble

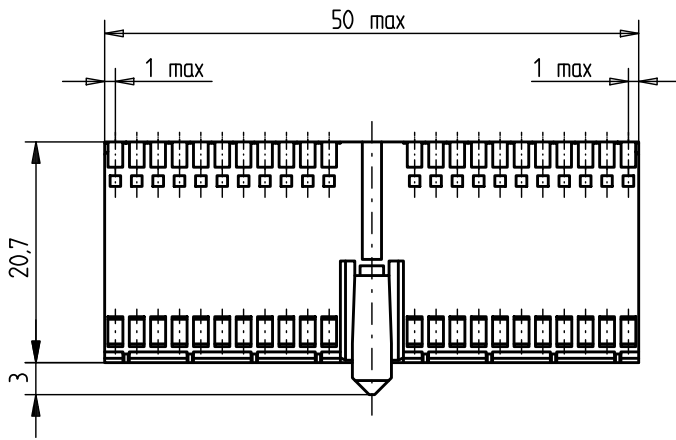
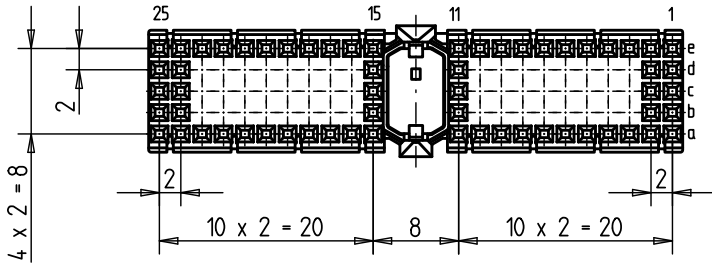

Lochbild für Leiterplatte (Bestückungsseite)

Board hole pattern (Component mounting side)

EE-Zone für durchkontaktierte Löcher $\varnothing 0,6 \pm 0,05$
Compliant zone for thru hole $\varnothing 0,6 \pm 0,05$

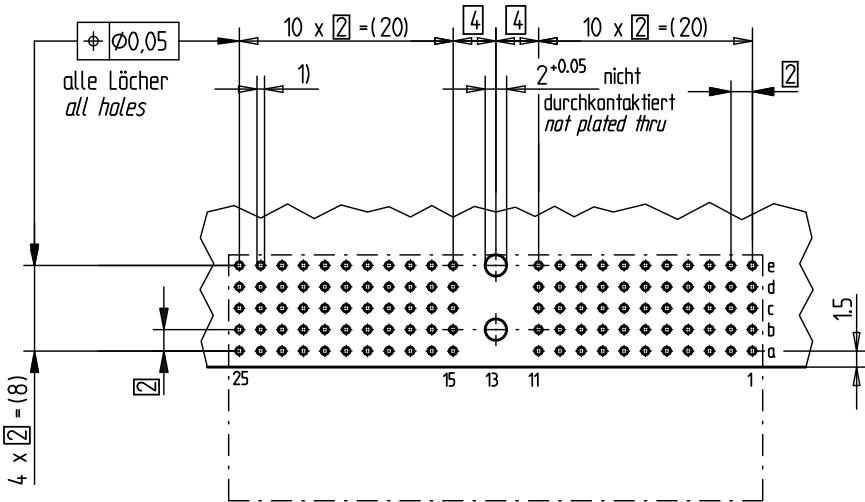
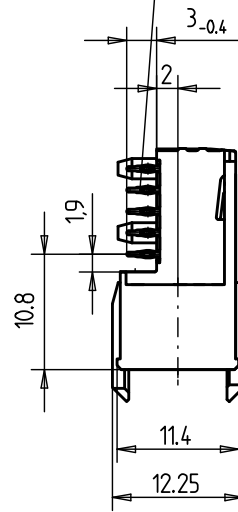

- 1) $\varnothing 0,6 \pm 0,05$ Durchmesser des metallisierten Loches
 $\varnothing 0,6 \pm 0,05$ Diameter of finished plated-through hole
- $\varnothing 0,7 \pm 0,02$ Bohrungsdurchmesser des Loches
 $\varnothing 0,7 \pm 0,02$ Diameter of drilled hole

Schichtaufbau im metallisierten Loch siehe Zeichnung 114406

Metal plating of plated-through hole see drawing 114406

Fehlende Masse und Angaben nach IEC 61076-4-101
Missing information and dimensions per IEC 61076-4-101

Bedruckung siehe Zeichnung 401194
Marking see drawing 401194

| | | | |
|--------------------------------------|--|---|---|
| Consider protection memo from DIN 34 | Information : Anforderungsstufe 2 / class 2 BA 2 | Tolerances All Dimensions in mm | Scale 2:1 |
| | All rights reserved. Only for information. To insure that this is the latest version of this drawing, please contact one of the ERNI companies before using. | Subject to modification without prior notice. Drawing will not be updated. | Designation ERmet Federleiste A <i>ERmet Female Type A</i> |
| b | 0106.2010 | www.ERNI.com | 364297 |
| Index | Date | V:00069810.SZA | ERMA |