

REV.	ZONE	LTR	DESCRIPTION	DATE	REVISOR	APPD

ORDERING INFORMATION:

BC0 0** P - * * S
 (1) (2) (3) (4) (5) (6)

- SERIES
.BC0 : D-SUB CRIMP CONNECTOR
- NUMBER OF CONTACTS
.EX. 009 - 9 POSITIONS
(9 , 15, 25 ,37)
- CONTACT TYPES
.P- PLUG
- COLOR CODES
.1- BLUE .3- BLACK .4- WHITE
- METAL SHELL FINISH
.1 - THE FRONT SHELL AND BACK SHELL ,BOTH TIN PLATED ,WITH GROUNDING INDENTS ON THE FRONT SHELL
.2 - THE FRONT SHELL AND BACK SHELL ,BOTH YELLOW CHROMATE PLATED ,WITHOUT GROUNDING INDENTS ON THE FRONT SHELL
.3 - THE FRONT SHELL AND BACK SHELL ,BOTH YELLOW CHROMATE PLATED ,WITH GROUNDING INDENTS ON THE FRONT SHELL
.6 - THE FRONT SHELL NICKEL PLATED AND WITH GROUNDING INDENTS ,BACK SHELL TIN PLATED
- Mounting Type
.S - STANDARD HOLE.

SPECIFICATIONS:

- .CURRENT RATING : 5 Amp
- .INSULATION RESISTANCE : 5000M MIN. AT 500 V DC (FOR 1 MINUTE)
- .DIELECTRIC WITHSTANDING VOLTAGE : AC 1000V MIN
- .CONTACT RESISTANCE : 15mΩ MAX. MATED
- .OPERATING TEMPERATURE : -25°C - +85°C
- .INSULATOR MATERIAL : PBT & GLASS-FIBER REINFORCED UL 94V-0
- .SHELL : STEEL,TIN OR NICKEL,YELLOW CHROMATE PLATED

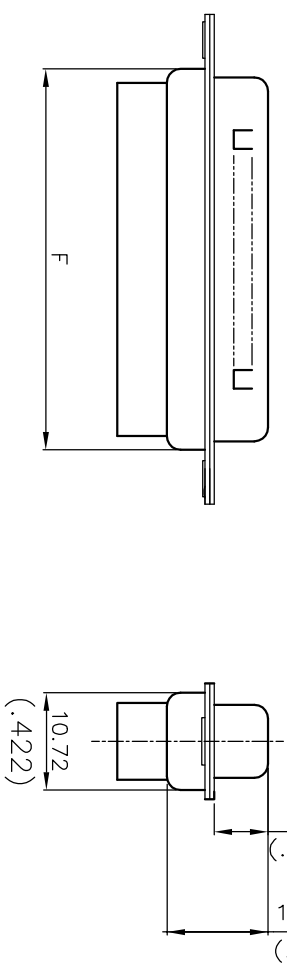
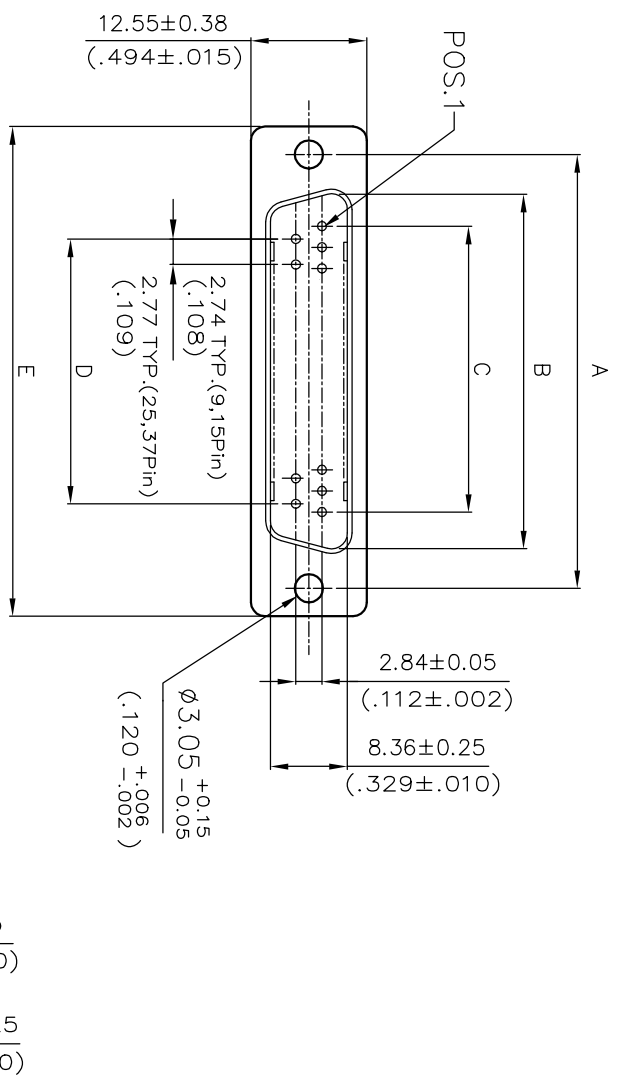

57.71(2.272)	69.40(2.732)	47.09(1.854)	49.86(1.963)	55.25(2.175)	63.50(2.500)	37	8C0037P
41.30(1.625)	53.09(2.090)	30.47(1.200)	33.24(1.309)	38.96(1.534)	47.04(1.852)	25	8C0025P
27.51(1.083)	39.10(1.539)	16.44(.647)	19.18(.755)	25.25(0.994)	33.32(1.312)	15	8C0015P
19.28(.759)	30.89(1.216)	8.22(.324)	10.96(.431)	16.92(0.666)	24.99(0.984)	9	8C0009P
±0.25 ^F (.010)	±0.38 ^F (.015)	±0.13 ^D (.005)	±0.13 ^C (.005)	±0.25 ^B (0.10)	±0.13 ^A (.005)	POSITION	PART NO.

FREEPORT

TOLERANCE UNSPECIFIED	SCALE	UNIT	SHEET
±0.00	1 : 1	mm(Inch)	1 / 1
±0.25			
±0.00			
±			
±			

DESIGNER	NAME	DRAWING NO.	REV.
関文林 3/11'04	8C0 SERIES D-SUB CRIMP MALE CONNECTOR	R-S108C-4	1

CHECKED	APPROVED	DRAWING NO.	REV.
Peterhu	John	R-S108C-4	1

DRAWN	SCALE	UNIT	SHEET
関文林 3/11'04	1 : 1	mm(Inch)	1 / 1

DRAWING NO.	REV.
R-S108C-4	1

DATE	REVISOR	APPD
A3	RS108C41	