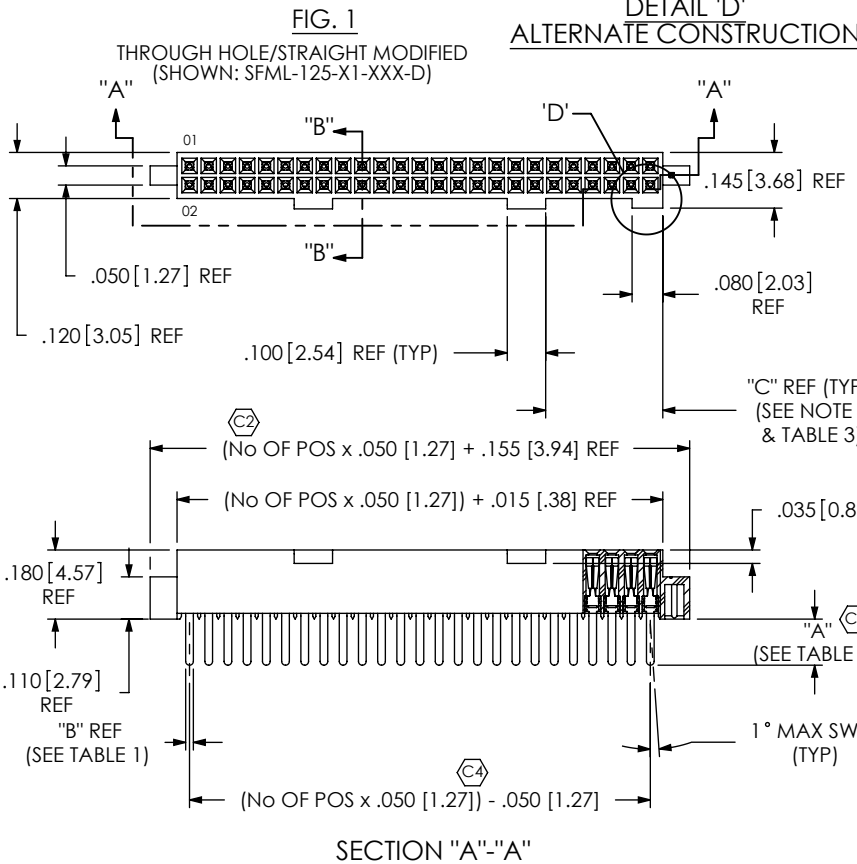
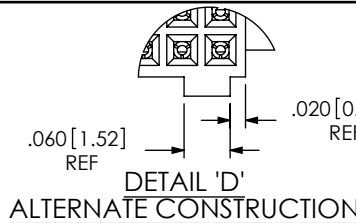

TABLE 1		
STYLE	"A"	"B"
-X1	.120 [3.05]	.020 [.51]
-X3	.075 [1.91]	.016 [.41]

DO NOT SCALE FROM THIS PRINT



SECTION "A"- "A"



- SFML-1XX-XX-XXX-D-XXX**
- No OF POSITIONS  
-05, -07, -10 THRU -50  
(PER ROW)
- LEAD STYLE**
- 01: THROUGH HOLE (USE C-44-01-XXX, SEE FIG 1, SHT 1)
  - 02: SURFACE MOUNT (USE C-44-02-XXX, SEE FIG 3, SHT 2)
  - 03: STRAIGHT MODIFIED (USE C-44-03-XXX, SEE FIG 1, SHT 1)
  - L1: THROUGH HOLE (LOW INSERTION) (USE C-61-01-XXX, SEE FIG 1, SHT 1)
  - L2: SURFACE MOUNT (LOW INSERTION) (USE C-61-02-XXX, SEE FIG 3, SHT 2)
  - L3: STRAIGHT MODIFIED (LOW INSERTION) (USE C-61-03-XXX, SEE FIG 1, SHT 1)
  - T1: THROUGH HOLE (PHOS BRONZE) (USE C-119-01-XXX, SEE FIG 1, SHT 1)
  - T2: SURFACE MOUNT (PHOS BRONZE) (USE C-119-02-XXX, SEE FIG 3, SHT 2)

- OPTIONS**  
(LEAVE BLANK FOR STANDARD AND USE SFML-XX-D)
- A: ALIGNMENT PIN (USE SFML-XX-D-A) (SEE FIG 5, SHT 3)
  - LC: LOCKING CLIP (SEE FIG 7, SHT 3) (USE (2) LC-05-TM & SFML-XX-D) (SEE NOTE 9)
  - P: PICK & PLACE PAD (SEE FIG 6, SHT 3) (USE PPP-02) (NOT AVAILABLE IN 5 POS)
  - TR: TAPE & REEL PACKAGING (N/A with -X1 AND -X3 LEAD STYLE, SEE FIG 2, SHT 1)
  - K: POLYIMIDE FILM PAD (USE K-500-300) (SEE FIG. 4, SHT. 2)
  - SN: SOLDER NAIL (USE SFML-XX-D-SN & WT-27-01-T) (SEE FIG 8, SHT 4) (AVAILABLE ON -X2 LEAD STYLES ONLY)
  - SN2: SOLDER NAIL FOR .093 BOARD
  - AB**: USE SFML-XX-D-SN & WT-27-02-T (SEE FIG 8, SHT 4) (ONLY AVAILABLE WITH -02, L2, AND T2 LEAD STYLE. NOT AVAILABLE WITH -A, -LC OPTIONS)
- ROW SPECIFICATION**
- D: DOUBLE ROW (USE SFML-XX-D-X)
- PLATING SPECIFICATION**
- S: SELECTIVE
  - P: GOLD FLASHED PALLADIUM NICKEL
  - F: FLASH SELECTIVE GOLD
  - H: HEAVY GOLD
  - L: LIGHT SELECTIVE GOLD
  - STL: SELECTIVE GOLD/ TIN-LEAD (ONLY AVAILABLE ON -02 AND -L2 LEADSTYLES)
  - SM: HEAVY SELECTIVE GOLD, MATTE TIN TAIL
  - LM: LIGHT SELECTIVE GOLD, MATTE TIN TAIL
  - FM: FLASH SELECTIVE GOLD, MATTE TIN TAIL

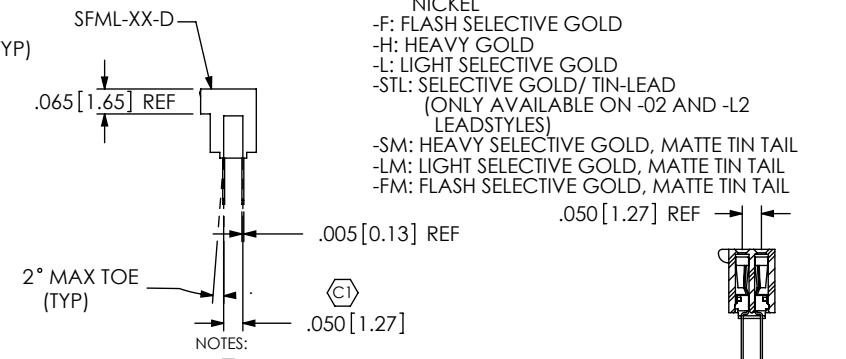

SECTION "B"- "B"

- NOTES:**
1.  $\text{C}$  REPRESENTS A CRITICAL DIMENSION.
  2. COPLANARITY: .004 [.10] FOR POS. 10 THRU 26  
.006 [.15] FOR POS. 27 THRU 50
  3. MINIMUM PUSHOUT FORCE: .5 LB.
  4. MAXIMUM ALLOWABLE BOW: .002 INCH/INCH [MM/MM] AFTER ASSEMBLY.
  5. POSITIONS -05 AND -07 WILL HAVE ONLY ONE CLIP AT DIMENSION SHOWN AND WILL NOT HAVE POLARIZATION NOTCH;  
POSITIONS -10 THROUGH -24 WILL HAVE ONLY ONE CLIP AT DIMENSION SHOWN;  
POSITIONS -25 THROUGH -34 WILL HAVE TWO CLIPS AT DIMENSION SHOWN;  
POSITIONS -35 THROUGH -50 WILL HAVE THREE CLIPS: TWO AT DIMENSION SHOWN & ONE CENTERED ON INSULATOR.
  6. SEE NOTCH FOR PROPER ORIENTATION.
  7. PINS CAN BE ORIENTED IN ANY DIRECTION; BOTH ROWS MUST FACW SAME WAY.
  8. MAXIMUM PIN HEIGHT VARIATION BETWEEN ANY TWO ROWS: .003[.08].
  9. DUE TO THE HIGH AMOUNT OF INSERTION FORCE NEEDED, THE -LC OPTION IS NOT COMPATIBLE WITH AUTO PLACEMENT. SAMTEC RECOMMENDS MANUAL PLACEMENT FOR ALL ASSEMBLIES WITH THE -LC OPTION.
  10. TUBE PARTS WITH NOTCH TOWARD ARROW.

**TABLE 3 (SEE NOTE 5)**

NO OF POS.	"C"
-05, -07	.080 [2.03]
-10 THRU -50	.305 [7.75]

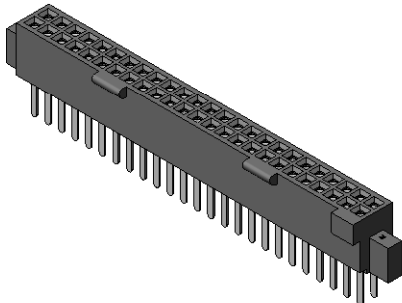
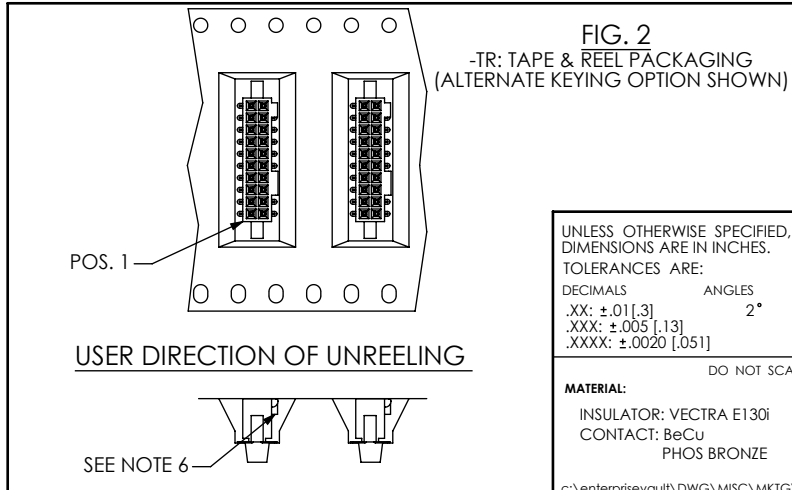

UNLESS OTHERWISE SPECIFIED, DIMENSIONS ARE IN INCHES. TOLERANCES ARE:

DECIMALS	ANGLES
.XX: ±.01 [.3]	2°
.XXX: ±.005 [.13]	
.XXXX: ±.0020 [.051]	

**MATERIAL:**  
INSULATOR: VECTRA E130I  
CONTACT: BeCu  
PHOS BRONZE

DO NOT SCALE DRAWING SHEET SCALE: 2:1

c:\enterprise\val\DWG\MISC\MKTG\SFML-1XX-XX-XXX-D-XXX-MKT.SLDDRW

**PROPRIETARY NOTE**  
THIS DOCUMENT CONTAINS INFORMATION CONFIDENTIAL AND PROPRIETARY TO SAMTEC, INC. AND SHALL NOT BE REPRODUCED OR TRANSFERRED TO OTHER DOCUMENTS OR DISCLOSED TO OTHERS OR USED FOR ANY PURPOSE OTHER THAN THAT WHICH IT WAS OBTAINED WITHOUT THE EXPRESSED WRITTEN CONSENT OF SAMTEC, INC.

520 PARK EAST BLVD, NEW ALBANY, IN 47150  
PHONE: 812-944-6733 FAX: 812-948-5047  
e-Mail: info@SAMTEC.com code: 53322

DESCRIPTION:  
.050 [1.27] x .050 [1.27] LOCKING SOCKET ASSEMBLY

DWG. NO.  
**SFML-1XX-XX-XXX-D-XXX**

BY: BRATCHER 4/19/99 SHEET 1 OF 4

FIG. 3  
 -X2: SURFACE MOUNT  
 (SAME AS FIG. 1, UNLESS OTHERWISE STATED)

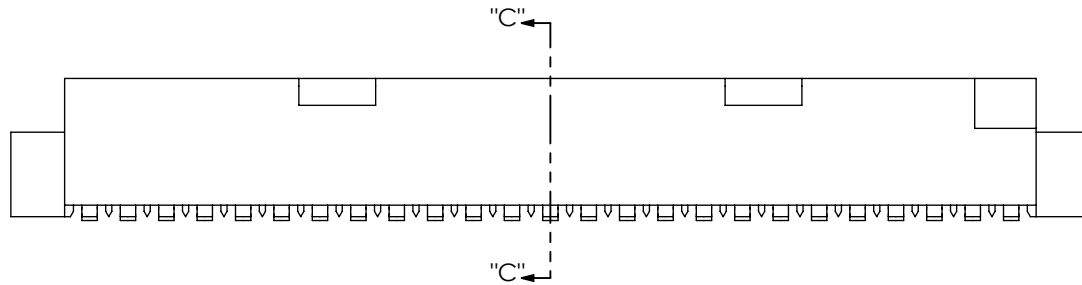
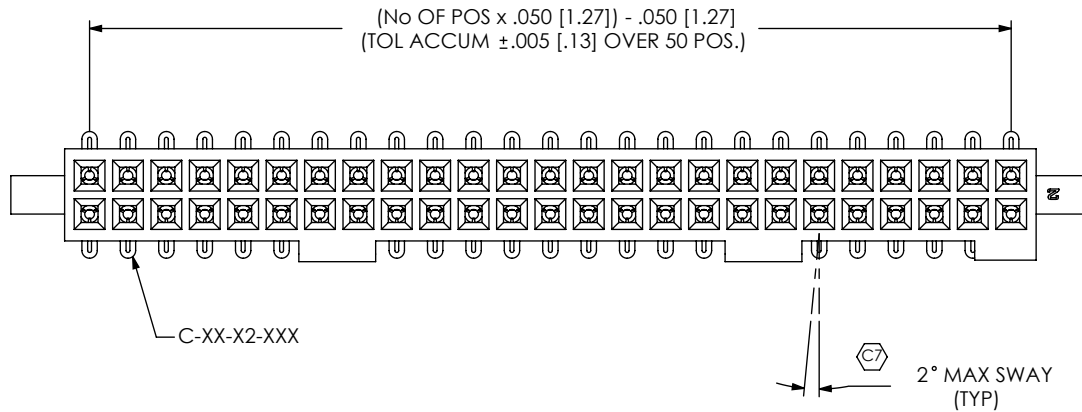
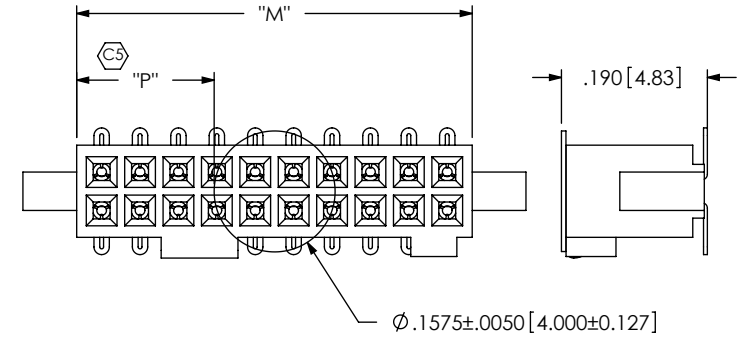
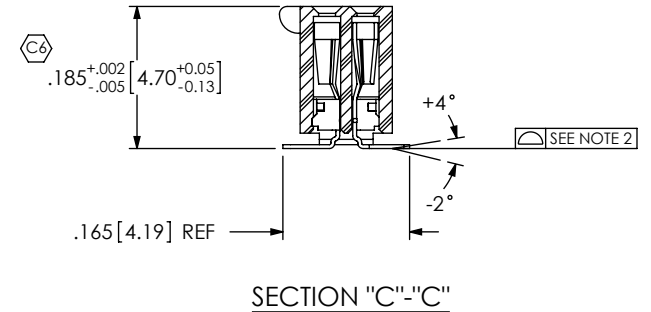

FIG. 4  
 -K: POLYIMIDE FILM PAD OPTION  
 (SHOWN: SFML-110-X2-X-D-K)  
 (ALTERNATE CONSTRUCTION SHOWN)



NOTE:  
 "M" = USED MEASURED DIMENSION (REF)  
 "P" =  $\{("M" - .1575 [4.000]) / 2\} \pm .020 [.51]$



c:\enterprisevault\DWG\MISC\MKTG\SFML-1XX-XX-XXX-D-XXX-MKT.SLDDRW

<p>PROPRIETARY NOTE</p> <p>THIS DOCUMENT CONTAINS INFORMATION CONFIDENTIAL AND PROPRIETARY TO SAMTEC, INC. AND SHALL NOT BE REPRODUCED OR TRANSFERRED TO OTHER DOCUMENTS OR DISCLOSED TO OTHERS OR USED FOR ANY PURPOSE OTHER THAN THAT WHICH IT WAS OBTAINED WITHOUT THE EXPRESSED WRITTEN CONSENT OF SAMTEC, INC.</p> <p>DO NOT SCALE DRAWING</p> <p>SHEET SCALE: 4:1</p>		
	<p>520 PARK EAST BLVD, NEW ALBANY, IN 47150                  PHONE: 812-944-6733 FAX: 812-948-5047                  e-Mail: info@SAMTEC.com code: 55322</p>	
	<p>DESCRIPTION:                  .050 [1.27] x .050 [1.27] LOCKING SOCKET ASSEMBLY</p>	
	<p>DWG. NO.  <b>SFML-1XX-XX-XXX-D-XXX</b></p>	
	<p>BY: BRATCHER 4/19/99</p>	<p>SHEET 2 OF 4</p>

FIG. 5

-A: ALIGNMENT PIN OPTION  
(SAME AS FIG. 1, UNLESS OTHERWISE STATED)  
(ALTERNATE CONSTRUCTION SHOWN)

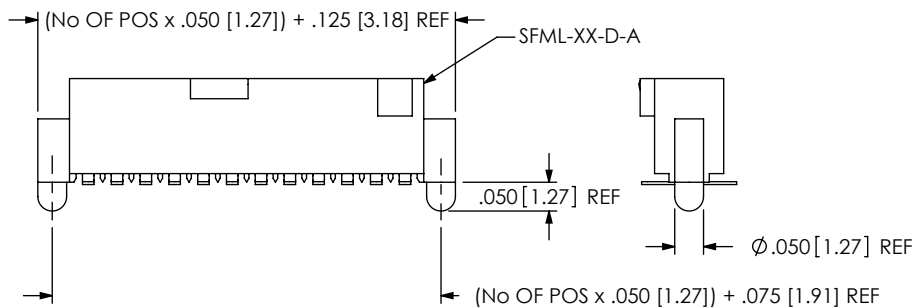

FIG. 6

-P: PICK & PLACE PAD OPTION  
(SAME AS FIG. 1, UNLESS OTHERWISE STATED)  
(ALTERNATE CONSTRUCTION SHOWN)

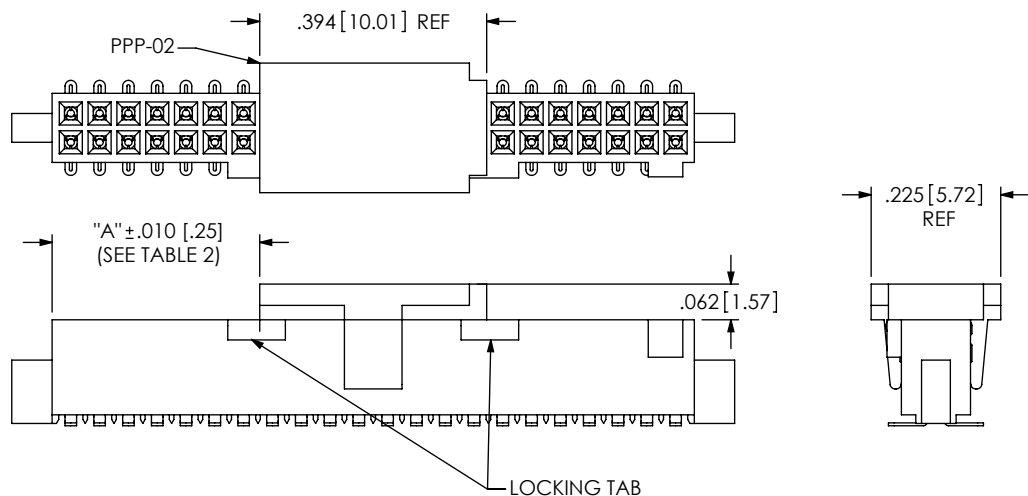
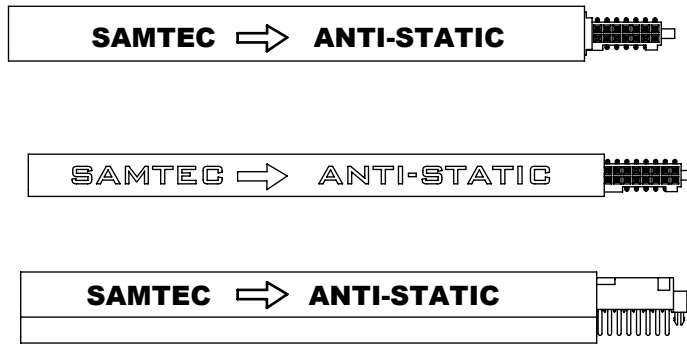
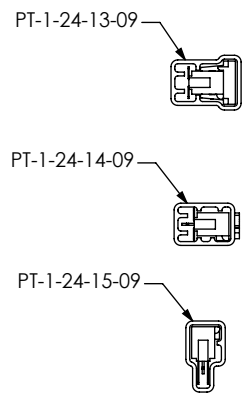

TABLE 2

POS.	"A"
-35 AND ABOVE (ODD)	{{(No OF POS x .050 [1.27]) / 2} -.2895 [7.353]}
EVEN ABOVE -34	{{(No OF POS x .050 [1.27]) / 2} -.3145 [7.989]}
ODD ABOVE -19	{{(No OF POS x .050 [1.27]) / 2} -.1895 [4.813]}
EVEN ABOVE -18	{{(No OF POS x .050 [1.27]) / 2} -.2145 [5.448]}
-07	.065 [1.65] OVERHANG
-10	.086 [2.18]
-11	.136 [3.45]
-12	.186 [4.72]
-13	.236 [5.99]
-14	.286 [7.26]
-15	.086 [2.18]
-16	.136 [3.45]
-17	.186 [4.72]
-18	.236 [5.99]
-19	.286 [7.26]

PACKAGE PARTS IN TUBES AS SHOWN  
(SEE NOTE 9)



LEAD STYLE	PACKAGING TUBE	PLUG
-X1-X, -X3-X (NO PAD)	PT-1-24-15-09	TP-24-02
-X1-X-P (W/ P&P PAD)	PT-1-24-02-17	TP-09
-X2-X (NO P&P PAD)	PT-1-24-14-09	TP-24-02
-X2-X-P, -X3-X-P (W/ P&P PAD)	PT-1-24-13-09	TP-24
-X1-K	PT-1-24-13-09	TP-24
-X2-K	PT-1-24-14-09	TP-24-02

FIG. 7

-LC: LOCKING CLIP OPTION  
(SAME AS FIG. 1, UNLESS OTHERWISE STATED)  
(ALTERNATE CONSTRUCTION SHOWN)

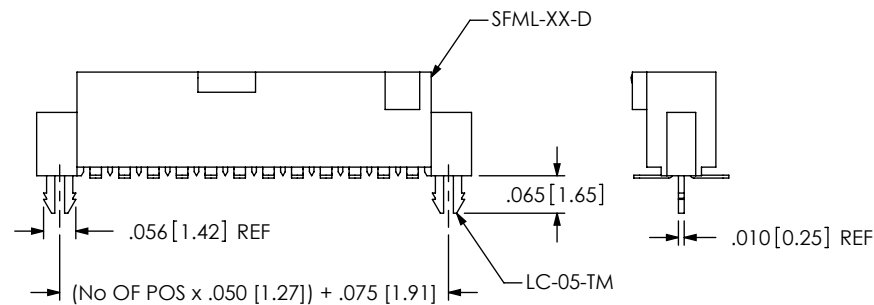

c:\enterprisevault\DWG\MISC\MKTG\SFML-1XX-XX-XXX-D-XXX-MKT.SLDDRW

**PROPRIETARY NOTE**  
THIS DOCUMENT CONTAINS INFORMATION CONFIDENTIAL AND PROPRIETARY TO SAMTEC, INC. AND SHALL NOT BE REPRODUCED OR TRANSFERRED TO OTHER DOCUMENTS OR DISCLOSED TO OTHERS OR USED FOR ANY PURPOSE OTHER THAN THAT WHICH IT WAS OBTAINED WITHOUT THE EXPRESSED WRITTEN CONSENT OF SAMTEC, INC.

DO NOT SCALE DRAWING

SHEET SCALE: 3:1

520 PARK EAST BLVD. NEW ALBANY, IN 47150  
PHONE: 812-944-6733 FAX: 812-948-5047  
e-Mail: info@SAMTEC.com code: 55322

DESCRIPTION:  
.050 [1.27] x .050 [1.27] LOCKING SOCKET ASSEMBLY

DWG. NO.  
**SFML-1XX-XX-XXX-D-XXX**

BY: BRATCHER 4/19/99 SHEET 3 OF 4

FIG. 8  
 -SNX: SOLDER NAIL OPTION  
 (SHOWN: SFML-125-02-XXX-D-SN  
 (SAME AS FIG. 1, UNLESS OTHERWISE STATED)  
 (ONLY AVAILABLE ON -X2 LEAD STYLES)

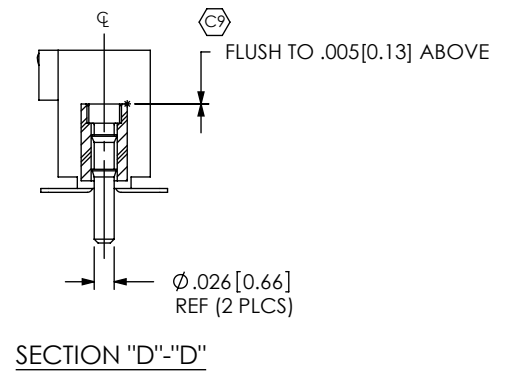
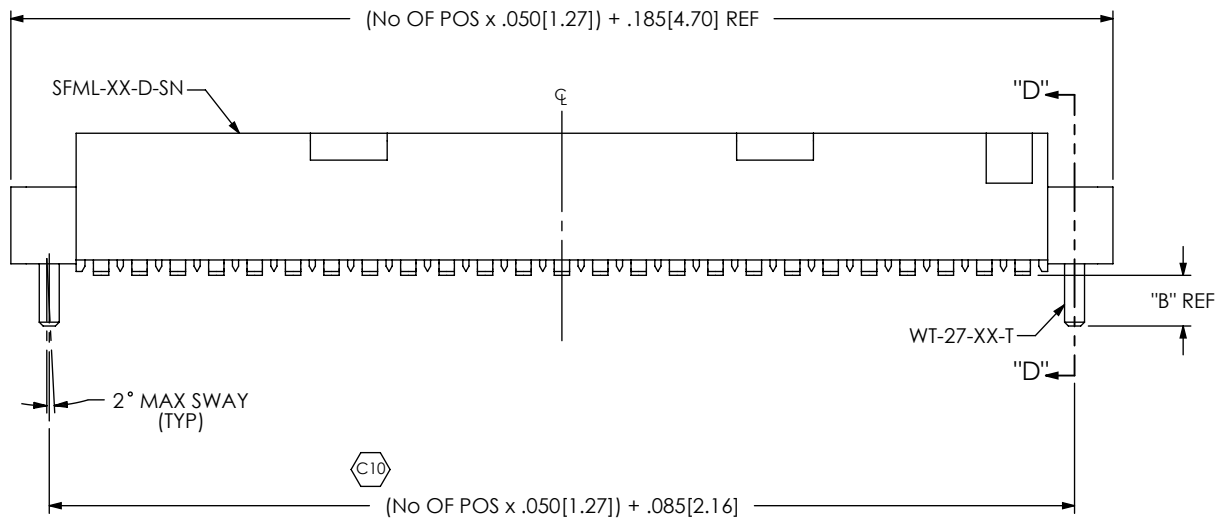

OPTION	"B"
-SN	.066[1.68]
SN2	.101[1.80]

**PROPRIETARY NOTE**  
 THIS DOCUMENT CONTAINS INFORMATION  
 CONFIDENTIAL AND PROPRIETARY TO  
 SAMTEC, INC. AND SHALL NOT BE REPRODUCED  
 OR TRANSFERRED TO OTHER DOCUMENTS OR  
 DISCLOSED TO OTHERS OR USED FOR ANY  
 PURPOSE OTHER THAN THAT WHICH IT WAS  
 OBTAINED WITHOUT THE EXPRESSED WRITTEN  
 CONSENT OF SAMTEC, INC.

DO NOT SCALE DRAWING

SHEET SCALE: 4:1

**samtec**

520 PARK EAST BLVD., NEW ALBANY, IN 47150  
 PHONE: 812-944-6733 FAX: 812-948-5047  
 e-Mail: info@SAMTEC.com code: 55322

DESCRIPTION:  
 .050 [1.27] x .050 [1.27] LOCKING SOCKET ASSEMBLY

DWG. NO.  
**SFML-1XX-XX-XXX-D-XXX**

BY: BRATCHER 4/19/99 SHEET 4 OF 4