

CUSTOMER COPY

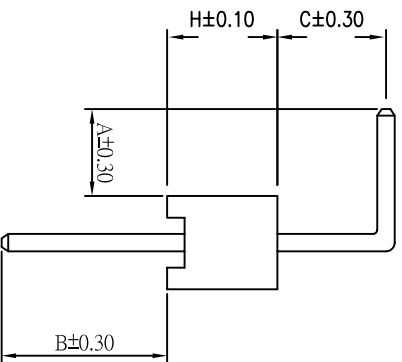

ORDER INFORMATION

181 00 XX XX X

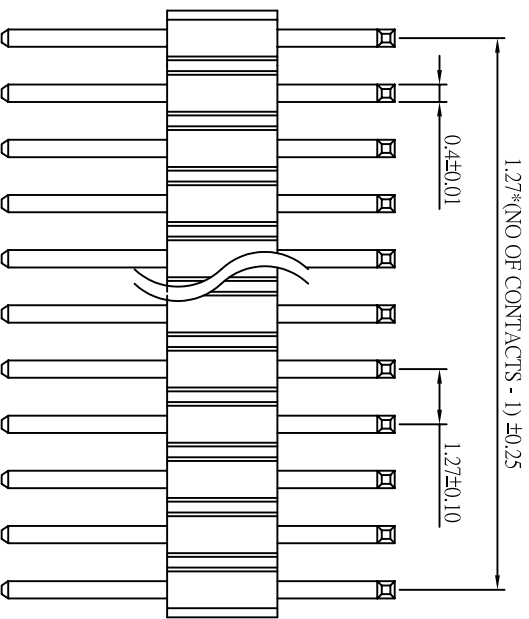
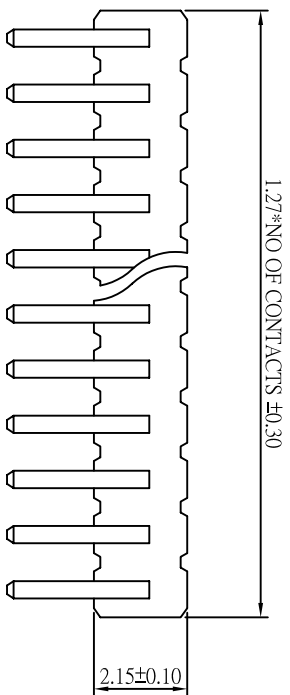
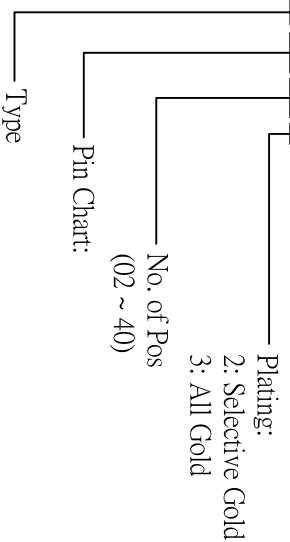

REV	ECN NO.	APP.	DATE
A	NEW DESIGN		

SPECIFICATION

- * Current Rating: 1 A
- * Withstanding Voltage: 600 VAC (1 min.)
- Insulation Resistance: * 1000 Megohms MAX.
- * Contact Resistance: 30 Milliohms MAX.
- * Operating Temperature: -55°C to +105°C
- * Retention Force: 450g MIN.

MATERIAL

- * Contact: Phosphor Bronze
- * Insulator: High Temperature Plastic
- * Plating: Selective Gold or ALL Gold

Pin Chart

No.	A	B	C	H
00	3.80	4.50	1.00	1.00
01	2.30	4.50	1.00	1.00
02	2.30	6.00	1.00	1.00
03				

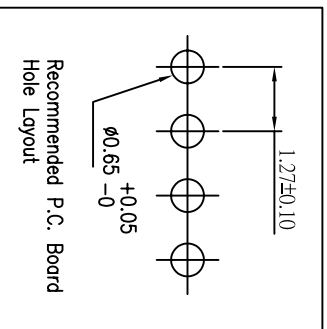

ACMELUX CO., LTD.

TEL.:886-85124595 FAX:886-85124322

SCALE: 0.0±

UNIT: MM

0.000±

TITLE:

1.27mm(.05") center pin header

R/A single Row

PART NO: 107110

APP BY:

CHK BY:

DR BY: JACK LIN



DWG. NO. C18100XXXXXX