

PRODUCT NUMBER	NUMBER OF POS	DIM "A"	DIM "B"	DIM "L"	PLATING TYPE
92849-001-XX	2 THRU 72	5.84	2.41	10.8	2u"Au OVER 50u"Ni
92849-002-XX	2 THRU 72	8.08	2.41	13.03	2u"Au OVER 50u"Ni
92849-003-XX	2 THRU 72	6	3.05	11.59	2u"Au OVER 50u"Ni

PART NUMBER

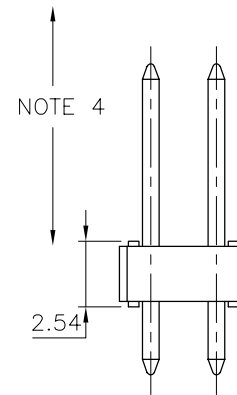
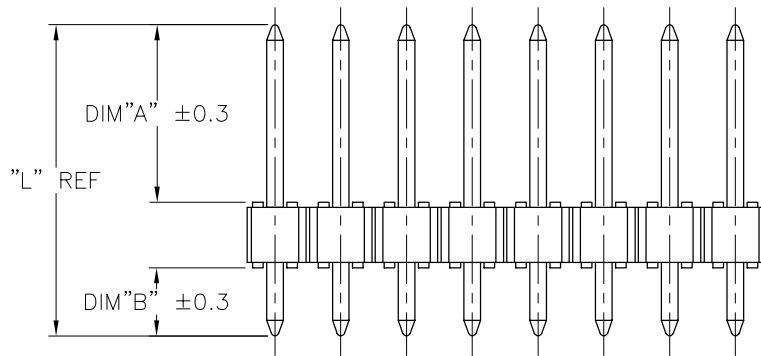
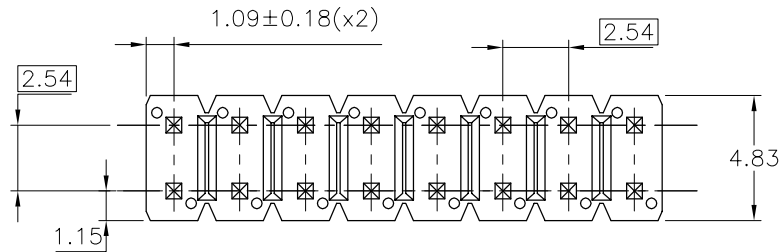
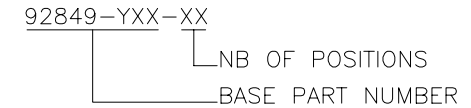

NOTES:

- 1 - MOLDING MATL: 30% GF PCT COLOR BLACK , FLAME RETARDANT PER UL-94V-0.
- 2 - PIN MATERIAL: BRASS
- 3 - PIN PUSH OUT FORCE 9N MINIMUM, IN EITHER DIRECTION
- 4 - PACKAGE IN POLYBAGS.
- 5 - TWO SIDES OF PIN TIPS NOT PLATED; TYP BOTH ENDS

Tous droits réservés. Toute réimpression ou reproduction non autorisée sans la permission écrite de la propriété intellectuelle de FCI Electronics S.A.

All rights strictly reserved. Reproduction or issue in third parties in any form without the written authority of FCI Electronics S.A. is prohibited. Copyright © FCI Electronics S.A.

mat'l. code SEE TABLE				tolerances unless otherwise specified		CUSTOMER COPY		ELECTRONICS www.fciconnect.com	
ltr	ecn no	dr	date	linear		projection	title DR,ECON-STIK		
A	F60588	JMC	96.08.26				EUROPEAN SOURCING		
B	F03-020	LMU	03.04.23	angles		 mm	product family HEADER BSTIK		code
				dr	COMPAGNON J		96.06.29	size dwg no	
				engr	JMC	96.06.29	scale		1:1
				chr			A3		95266
				app	JMC	96.06.29			sheet 1 of 1
sheet index	revision sheet								