

**NOTES:**

- 1 MATERIAL: BASE AND COVER: 30% GLASS FILLED POLYESTER FLAME RETARDANT PER UL-94-V0 COLOUR GREY STRAIN RELIEF: UNREINFORCED THERMOPLASTIC FLAME RETARDANT PER UL-94-V0 COLOUR GREY CONTACT: PHOSPHOR BRONZE
- 2 PLATING: 0.38  $\mu$ m Au OVER 1.27  $\mu$ m Ni IN CONTACT AREA REMAINDER OF PRODUCT (IDC PART) 1.27  $\mu$ m Ni
- 3 TRIANGLE NOT MOLDED-IN ON 2x2 AND 2x3 POSITIONS WITH CENTRAL KEY
- 4 THE DASH "L" AT THE END OF THE PART NUMBER TO INDICATE A NEW LATCH DESIGN "COVER LATCH STYLE" IS THE MANUFACTURER'S OPTION. (P/N ENDING WITH OR WITHOUT AN "L"). ORDERS WITH THE "L" DESIGNATION MUST CONTAIN THE NEW LATCH DESIGN.

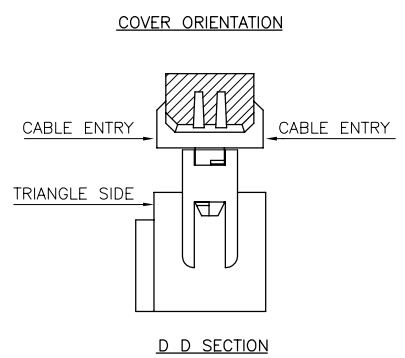
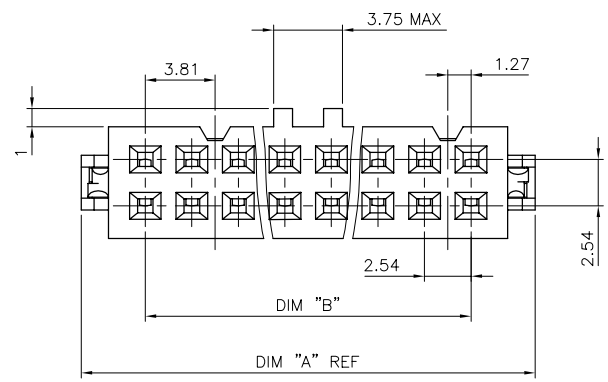

**CUSTOMER COPY FOR REFERENCE ONLY**

mat'l. code		SEE NOTES		tolerances unless otherwise specified		CUSTOMER COPY			
ltr	ecr no	dr	date	linear		projection	<b>QUICKIE III FEM</b> 0.38 $\mu$ m Au		
G	F40397	PNZ	94.05.30				product family	QKIE FEM	code
H	F50871	PNZ	95.11.23				size	dwg no	213
J	F00147	DLE	00.03.08	angles		mm [inch]	scale	A2	sheet
K	V11866	DLE	01.07.20	dr	P. NIZZI	95.11.23	5:1	71601	1 of 3
L	F10566	DLE	01.10.24	engr	JM PHAMVAN	95.11.23			
M	F03019	DLE	03.01.23	chr	P. NIZZI	95.11.23			
				appd	JM P	95.11.23			
sheet	revision	M	K	C					
index	sheet	1	2	3					

PRODUCT NUMBER	SIZE	DIM "A"	DIM "B"	DIM "C"	DIM "S"	SLOT STYLE
71601-X04	2x 2	9.54	2.54	9.46	5.66	NO SLOT
71601-X06	2x 3	12.08	5.08	12.00	8.20	RIGHT IF NO KEY
71601-X08	2x 4	14.62	7.62	14.54	10.74	RIGHT IF NO KEY
71601-X10	2x 5	17.16	10.16	17.08	13.28	RIGHT SLOT
71601-X14	2x 7	22.24	15.24	22.16	18.36	RIGHT SLOT
71601-X16	2x 8	24.78	17.78	24.70	20.90	2 SLOTS
71601-X18	2x 9	27.32	20.32	27.24	23.44	2 SLOTS
71601-X20	2x 10	29.86	22.86	29.78	25.98	2 SLOTS
71601-X24	2x 12	34.94	27.94	34.85	31.06	2 SLOTS
71601-X26	2x 13	37.48	30.48	37.40	33.60	2 SLOTS
71601-X30	2x 15	42.56	35.56	42.48	38.68	2 SLOTS
71601-X34	2x 17	47.64	40.64	47.56	43.76	2 SLOTS
71601-X40	2x 20	55.26	48.26	55.18	51.38	2 SLOTS
71601-X44	2x 22	60.34	53.34	60.26	56.46	2 SLOTS
71601-X50	2x 25	67.96	60.96	67.88	64.08	2 SLOTS
71601-X60	2x 30	80.66	73.66	80.58	76.78	2 SLOTS
71601-X64	2x 32	85.74	78.74	85.66	81.86	2 SLOTS

71601-XYL SEE NOTE 4 SHEET 1

WINDOWS MOLDED CLOSED POSITION	MISSING CONTACT POSITION
-----------------------------------	-----------------------------

71601-X09	2x 5	17.16	10.16	17.08	13.28	RIGHT SLOT	1	1
-----------	------	-------	-------	-------	-------	------------	---	---

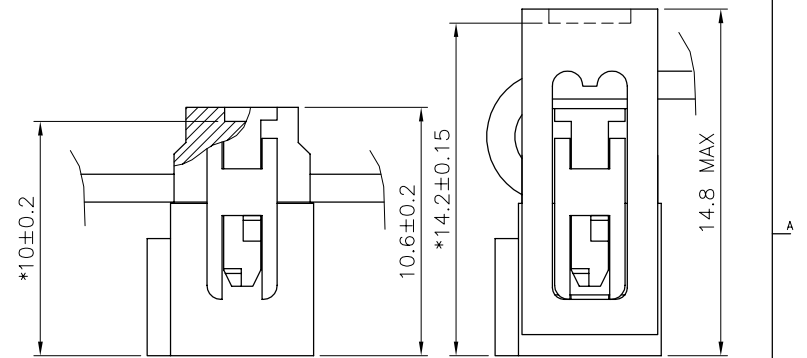

WITHOUT STRAIN RELIEF WITH LOW PROFILE STRAIN RELIEF

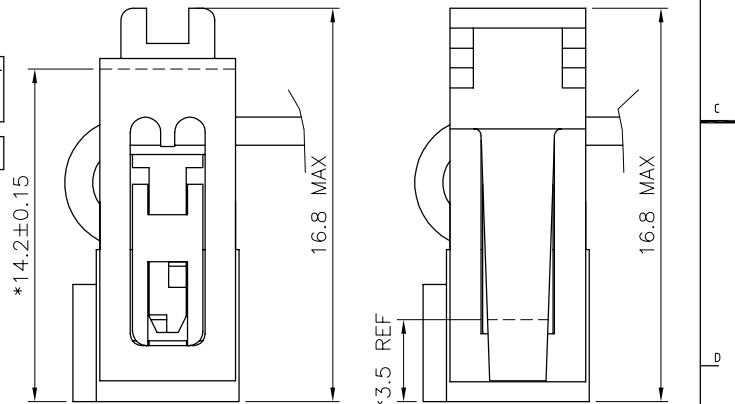

WITH STANDARD STRAIN RELIEF WITH LATCHING STRAIN RELIEF

AFTER TERMINATION SIDE VIEW OF ASSEMBLY (\* LATCHING DIM ON HEADER)

71601-7YY		⊗				⊗	724
71601-6YY	⊗					⊗	624
71601-5YY		⊗			⊗		504 524 530
71601-4YY		⊗			⊗		
71601-3YY		⊗		⊗			304
71601-2YY	⊗				⊗		204 224 230
71601-1YY	⊗				⊗		
71601-0YY	⊗			⊗			004
PRODUCT NUMBER	WITH CENTRAL KEY	WITHOUT CENTRAL KEY	STANDARD	WITHOUT	LOW PROFILE	LATCHING	DASHES NOT AVAILABLE
			STRAIN RELIEF				

mat'l. code		tolerances unless otherwise specified		CUSTOMER COPY		FCI ELECTRONICS	
ltr	ecn no	dr	date	linear	projection	title	www.fciconnect.com
H	F50871	PNZ	95.11.23			QUICKIE III FEM	
J	F00147	DLE	00.03.08			0.38 μm Au	
K	F03019	DLE	03.01.23	angles	mm [inch]	product family	code
				dr	O.MATHEVON	95.08.04	213
				enr	JM PHAMVAN	95.11.23	sheet
				chr	P. NIZZI	95.11.23	2 of -
				app	JM P	95.11.23	
sheet	revision			scale	N/A	A2	71601
index	sheet						

PRODUCT NUMBER	SIZE	DIM "A"	DIM "B"	DIM "C"	DIM "S"	SLOT STYLE
71601-X04K	2x 2	9.54	2.54	9.46	5.66	NO SLOT
71601-X06K	2x 3	12.08	5.08	12.00	8.20	RIGHT IF NO KEY
71601-X08K	2x 4	14.62	7.62	14.54	10.74	RIGHT IF NO KEY
71601-X10K	2x 5	17.16	10.16	17.08	13.28	RIGHT SLOT
71601-X14K	2x 7	22.24	15.24	22.16	18.36	RIGHT SLOT
71601-X16K	2x 8	24.78	17.78	24.70	20.90	2 SLOTS
71601-X18K	2x 9	27.32	20.32	27.24	23.44	2 SLOTS
71601-X20K	2x 10	29.86	22.86	29.78	25.98	2 SLOTS
71601-X24K	2x 12	34.94	27.94	34.85	31.06	2 SLOTS
71601-X26K	2x 13	37.48	30.48	37.40	33.60	2 SLOTS
71601-X30K	2x 15	42.56	35.56	42.48	38.68	2 SLOTS
71601-X34K	2x 17	47.64	40.64	47.56	43.76	2 SLOTS
71601-X40K	2x 20	55.26	48.26	55.18	51.38	2 SLOTS
71601-X44K	2x 22	60.34	53.34	60.26	56.46	2 SLOTS
71601-X50K	2x 25	67.96	60.96	67.88	64.08	2 SLOTS
71601-X60K	2x 30	80.66	73.66	80.58	76.78	2 SLOTS
71601-X64K	2x 32	85.74	78.74	85.66	81.86	2 SLOTS

71601-XYKLL SEE NOTE 4 SHEET 1

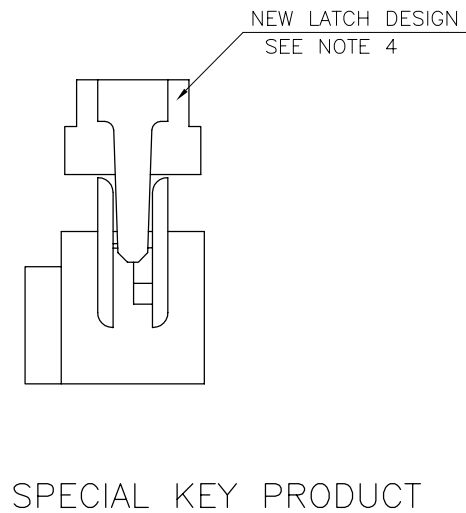
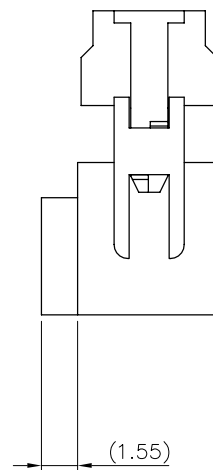
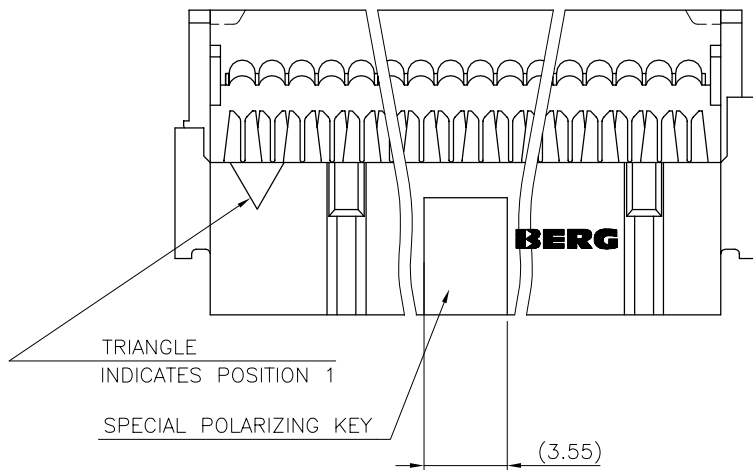

71601-6YYK	●					●	624
71601-2YYK	●					●	204 224 230
71601-1YYK	●				●		
71601-0YYK	●			●			004
PRODUCT NUMBER	WITH CENTRAL KEY	WITHOUT CENTRAL KEY	STANDARD	WITHOUT STRAIN RELIEF	LOW PROFILE	LATCHING	DASHES NOT AVAILABLE

mat'l. code		tolerances unless otherwise specified		CUSTOMER COPY		FCI ELECTRONICS	
ltr	ecn no	dr	date	linear	projection	title QUICKIE III FEM	
A	F40397	PNZ	94.05.30			0.38 μm Au	
B	F50871	PNZ	95.11.23			product family	code 213
C	F10566	DLE	01.10.24	angles		size	sheet 3 of -
		dr	O.MATHEVON	95.08.04	mm [inch]	product family	code 213
		engn	JM PHAMVAN	95.11.23		size	sheet 3 of -
		chr	P. NIZZI	95.11.23	scale	A2	71601
		appd	JM P	95.11.23	N/A		
sheet index	revision sheet						