

RIGHT ANGLE D-SUB DSM-318 SERIES

SPECIFICATIONS

For complete specifications see www.samtec.com?DSM-318

Insulator Material:
Black High Temperature Thermoplastic

Pin Material:
Brass

Socket Material:
Phosphor Bronze

Shell Material:
Steel

Operating Temp Range:
-65°C to +125°C

Plating:
Gold Flash on Contacts, Nickel on Shell and Tin-Lead on Tails

Current Rating:
5 A per contact

Voltage Rating:
40 VAC

Contact Resistance:
20 m max

Minimum Cycles:
1000

ALSO AVAILABLE

Metric Jackscrews also available. Call Samtec.

9, 15, 25 or 37 Contacts (Pins or Sockets)

Choice of Selective Platings

Threaded Inserts or Removable Jackscrews

DSM 318 SHELL SIZE POSITIONS GENDER PLATING BOARD MOUNT FACE MOUNT

- E-09 = 9 Positions
- A-15 = 15 Positions
- B-25 = 25 Positions
- C-37 = 37 Positions

- P = Pin
- S = Socket

- F = Gold Flash on Mating Area, Tin-Lead on Tails
- L = 10µ" (0.25µm) Gold on Mating Area, Tin-Lead on Tails
- S = 30µ" (0.76µm) Gold on Mating Area, Tin-Lead on Tails

- LB = "L" Bracket
- FB = Forked Board Locks

- FT = #4-40 Flush Threaded Inserts
- RJ = Threaded Inserts with Removable #4-40 Jackscrews

Processing:

Suggested PCB Layouts:
For reference only. Please contact Samtec or go to www.samtec.com?DSM-318 for recommended PCB layout.

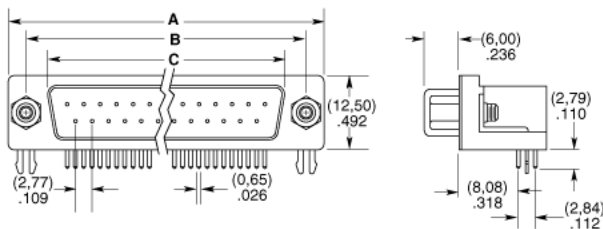
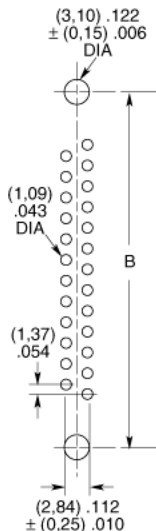

SHELL SIZE-POSITION	A	B	C (-P)	C (-S)
	± (0,25) .010	± (0,25) .010	± (0,25) .010	± (0,25) .010
-E-09	(30,81) 1.213	(24,99) .984	(16,92) .666	(16,33) .643
-A-15	(39,14) 1.541	(33,32) 1.312	(25,25) .994	(24,66) .971
-B-25	(53,04) 2.088	(47,04) 1.852	(38,96) 1.534	(38,38) 1.511
-C-37	(69,32) 2.729	(63,50) 2.500	(55,43) 2.182	(54,84) 2.159

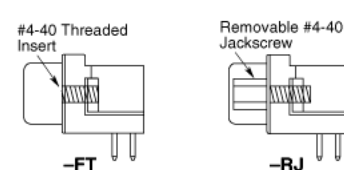
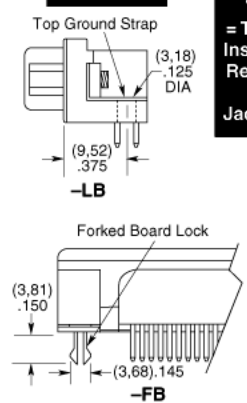

Due to technical progress, all designs, specifications and components are subject to change without notice.

WWW.SAMTEC.COM