

# KSR2D Series Subminiature Detect Switch for SMT

## Features/Benefits

- Saves PCB space
- G terminations
- Soft actuator
- RoHS compliant and compatible

## Typical Applications

- Automotive
- Cellular phones & accessories
- Industrial electronics
- Computers & network equipment



## Specification

FUNCTION: momentary action  
CONTACT ARRANGEMENT: N.O.  
TERMINALS: Gullwing type for SMT

## Mechanical

Type	Operating force Newtons (grams)	Operating life (operations)	Travel
KSR2D3G	1,5 ± 0,5N	100,000	0,3 ± 0,15

## Packaging

Switches are delivered on continuous tape, in reels of 2,500 pieces.

**NOTE:** Part numbers listed above do not represent all possible configurations.

For information on specific and custom switches, consult Customer Service Center.

## Electrical

MAXIMUM POWER: 0.2 VA  
MAXIMUM VOLTAGE: 32 VDC  
MINIMUM VOLTAGE: 20 mV  
MAXIMUM CURRENT DC: 10 mA  
MINIMUM CURRENT DC: 1 mA

CONTACT RESISTANCE: 100 mΩ  
INSULATION RESISTANCE (100 V): 10<sup>9</sup> Ω  
BOUNCE TIME: 1 ms

## Environmental

OPERATING TEMPERATURE: -40°C to 125°C  
STORAGE TEMPERATURE: -55°C to 125°C

## Process

SOLDERING: Infrared reflow according to lead free soldering process

## How To Order

Our easy build-a-switch concept allows you to mix and match options to create the switch you need. To order, select desired option from each category and place it in the appropriate box.

However, please note that all the combinations of these options are not feasible.

For any part number different from those listed above, please consult your local representative.

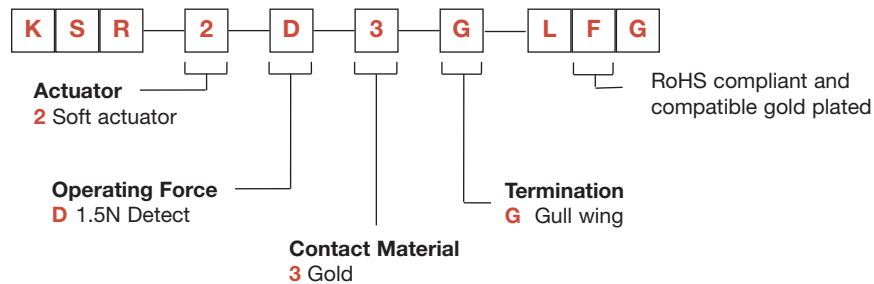

F

Detect

KSR2D

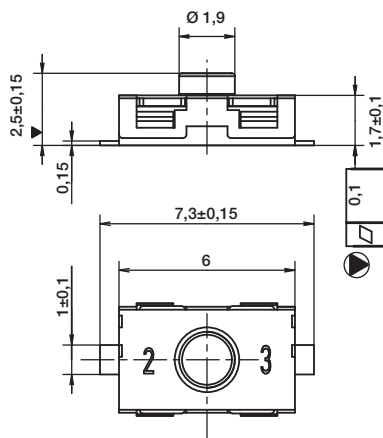

PAD LAYOUT NORMALLY OPEN

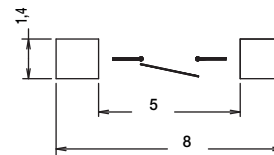

Dimensions are shown: mm  
Specifications and dimensions subject to change