

\*\*\* 2011 H Series \*\*\*

Material :

\* Insulator : UL 94V-0 Nylon 6/6

\* Contact : Brass

\* Plating : Tin plated 120μ " min over 30μ " min. nickel overall

2011P\*\*H\*0\*  
1 2 3

1.No.of circuits

2.Packing: 0=Plastic Bag A=Tube

3.Color:

0=white 1=black 3=red 5=yellow

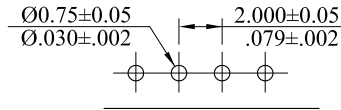

Recommended PCB Hole Pattern

RoHS COMPLIANT

Circuits with The position of the kink

circuits	the position of the kink
2P	1st 2nd
3P	1st 3rd
4P	1st 4th
5P	1st 5th
6P	1st 6th
7P	1st 4th 7th
8P	1st 4th 8th
9P	1st 5th 9th
10P	1st 5th 10th
11P	1st 6th 11st
12P	1st 6th 12nd
13P	1st 7th 13rd
14P	1st 7th 14th
15P	1st 8th 15th
16P	1st 9th 16th

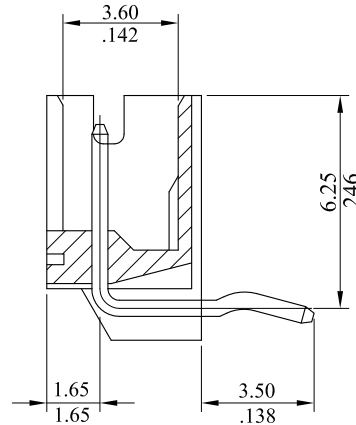
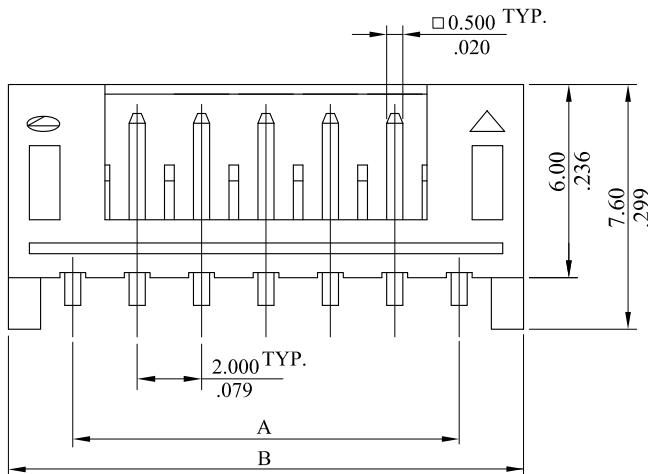
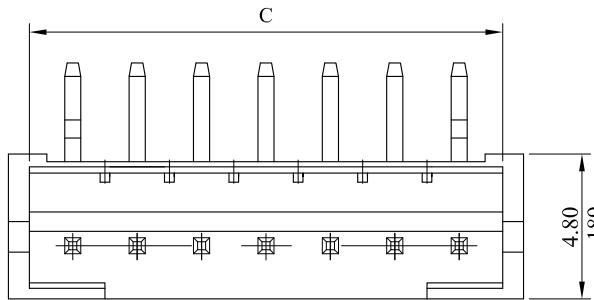

Part No.	DIM. A	DIM. B	DIM. C	Part No.	DIM. A	DIM. B	DIM. C
2011P02H*0*	2.000 (.079)	6.0 (.236)	4.70 (.185)	2011P12H*0*	22.00 (.866)	26.0 (1.024)	24.70 (.972)
2011P03H*0*	4.000 (.157)	8.0 (.315)	6.70 (.264)	2011P13H*0*	24.00 (.945)	28.0 (1.102)	26.70 (1.051)
2011P04H*0*	6.000 (.236)	10.0 (.394)	8.70 (.345)	2011P14H*0*	26.00 (1.024)	30.0 (1.181)	28.70 (1.130)
2011P05H*0*	8.000 (.315)	12.0 (.472)	10.70 (.421)	2011P15H*0*	28.00 (1.102)	32.0 (1.260)	30.70 (1.209)
2011P06H*0*	10.000 (.394)	14.0 (.551)	12.70 (.500)	2011P16H*0*	30.00 (1.181)	34.0 (1.338)	32.70 (1.287)
2011P07H*0*	12.000 (.472)	16.0 (.630)	14.70 (.579)	2011P17H*0*	32.00 (1.260)	36.0 (1.417)	34.70 (1.366)
2011P08H*0*	14.000 (.551)	18.0 (.709)	16.70 (.657)	2011P18H*0*	34.00 (1.338)	38.0 (1.496)	36.70 (1.445)
2011P09H*0*	16.000 (.630)	20.0 (.787)	18.70 (.736)	2011P19H*0*	36.00 (1.417)	40.0 (1.575)	38.70 (1.524)
2011P10H*0*	18.000 (.709)	22.0 (.866)	20.70 (.815)	2011P20H*0*	38.00 (1.496)	42.0 (1.654)	40.70 (1.602)
2011P11H*0*	20.00 (.787)	24.0 (.945)	22.70 (.894)				

H	ES110311			<b>LECO CORPORATION</b> GENERAL TOLERANCES: (UNLESS SPECIFIED) <table border="1"> <thead> <tr> <th></th> <th>mm</th> <th>inch</th> </tr> </thead> <tbody> <tr><td>1 PLACE</td><td>± 0.30</td><td>± --</td></tr> <tr><td>2 PLACES</td><td>± 0.20</td><td>± .012</td></tr> <tr><td>3 PLACES</td><td>± 0.10</td><td>± .008</td></tr> <tr><td>4 PLACES</td><td>± --</td><td>± .004</td></tr> </tbody> </table> ANGULAR ± ( 1° )		mm	inch	1 PLACE	± 0.30	± --	2 PLACES	± 0.20	± .012	3 PLACES	± 0.10	± .008	4 PLACES	± --	± .004	APPROVED:	PART NO.:			
	mm	inch																						
1 PLACE	± 0.30	± --																						
2 PLACES	± 0.20	± .012																						
3 PLACES	± 0.10	± .008																						
4 PLACES	± --	± .004																						
G	ES101222			DATE:	2011P**H*0*																			
F	ES101008			CHECKED:	TITLE:																			
E	ES061123			DATE:	HEADER																			
A	DWG REL			DRAWN:	DRAWING NO.:																			
REV.	ECO. NO.	CHG.	APP.	DATE:	201109S																			
					UNITS	SCALE	SIZE	SHEET	REV.															
					mm / inch	4:1	A4	1/1	H															