

1		2		3		4		5		6		7		8	
REV.	DESCRIPTION	DRAWN	DATE	REV.	DESCRIPTION	DRAWN	DATE	REV.	DESCRIPTION	DRAWN	DATE	REV.	DESCRIPTION	DRAWN	DATE
A	Release	Lyndon Lin	2008/03/18	C	Add pin code "105/06"	Lyndon Lin	2008/05/20								
B	(1) Changed "Lxxx/xx" to "Sxxx/xx" (2) Add pin code "076/02" & "085/04"	Lyndon Lin	2008/03/28	D	Add Pin Code "085/05"	Lyndon Lin	2009/04/24								
				E	Add Pin Code "085/06"	Ryan Chou	2009/08/20								

No. of Pin	Dimension(mm)	
	L1	L2
002	2.54	5.08
003	5.08	7.62
004	7.62	10.16
005	10.16	12.70
006	12.70	15.24
007	15.24	17.78
008	17.78	20.32
009	20.32	22.86
010	22.86	25.40
011	25.40	27.94
012	27.94	30.48
013	30.48	33.02
014	33.02	35.56
015	35.56	38.10
016	38.10	40.64
017	40.64	43.18
018	43.18	45.72
019	45.72	48.26
020	48.26	50.80
021	50.80	53.34
022	53.34	55.88
023	55.88	58.42
024	58.42	60.96
025	60.96	63.50
026	63.50	66.04
027	66.04	68.58
028	68.58	71.12
029	71.12	73.66
030	73.66	76.20
031	76.20	78.74
032	78.74	81.28
033	81.28	83.82
034	83.82	86.36
035	86.36	88.90
036	88.90	91.44
037	91.44	93.98
038	93.98	96.52
039	96.52	99.06
040	99.06	101.60

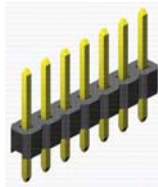
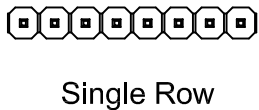
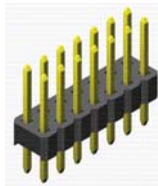
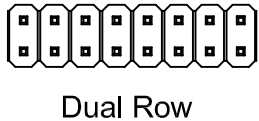

ORDER CODE

SLx-xxx-SL xxx/xx-xx

Rows
Single Row = 1
Dual Row = 2

No. of Pin
(Single Row) 002 to 040
(Dual Row) 004 to 080

Execution
Straight (Hi Temp. insulator) = B
Straight (P.B.T insulator) = L

Pin Type
See Table

Plating
55 = Gold flash
(Standard)
66 = 10μ" Gold
77 = 15μ" Gold
88 = 30μ" Gold
99 = Tin

Duplex plating
95 = Tin/Gold flash
96 = Tin/10μ" Gold
97 = Tin/15μ" Gold
98 = Tin/30μ" Gold

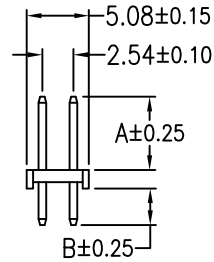
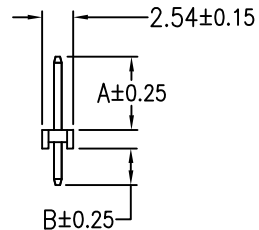
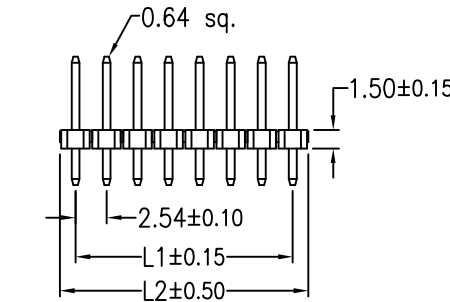

SPECIFICATIONS

Current Rating : 3A
 Insulator resistance : 1000 MΩ min.
 Contact Resistance : 20 mΩ max.
 Dielectric Withstanding : AC 500V/Minute
 Operating Temperature : -40° ~ +105°C
 Contact Material : Brass
 Insulator Material : PBT or High Temperature
 Color : Black
 Plating: Gold, Tin or Duplex plated
 *Duplex plated: Gold plated on contact area
 Tin on solder area

Terminal Style		
Pin Code	Dim."A" (mm)	Dim."B" (mm)
076/01	3.40	2.70
076/02	2.70	3.40
085/04	3.90	3.10
085/05	2.67	4.32
085/06	4.70	2.30
105/06	6.00	3.00
109/01	7.10	2.30
109/02	7.00	2.40
135/06	9.70	2.30
Others on request		

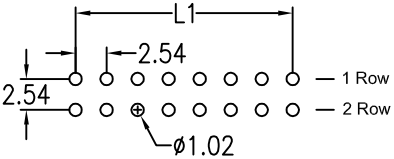

UNIT mm	GENERAL TOLERANCE	DRAWN Lyndon Lin	DATE Mar 18 2008	DWG. NO. SLx-SLxxx/xx	SHEET 1/1
SCALE Free	X.° ± 3° .X° ±	CHECK Lyndon Lin	DATE Aug 20 2009	PART NO. SLx-xxx-SLxxx/xx-xx	REV. E
	XX. ± .XX ± 0.25	APPROVE Selena Hong	DATE Aug 20 2009		
	XXX. ± .XXX ±				

2.54mm Pitch Pin Header
-THT- Straight Single & Dual Row
Insulator H:1.50mm