

RECOMMENDED PCB LAYOUT

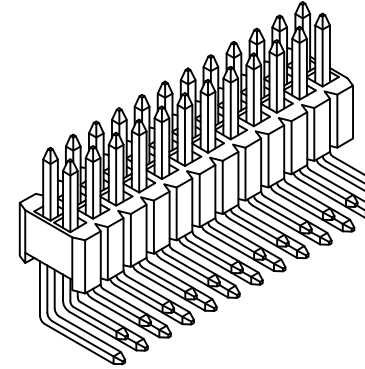
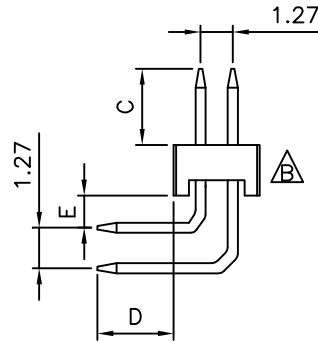
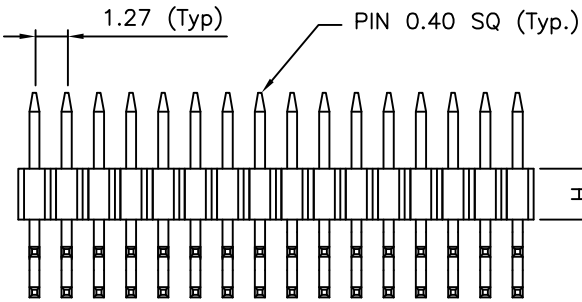

CONTACTS	DIMENSION	
	A	B
4	1.27	2.54
6	2.54	3.81
8	3.81	5.08
10	5.08	6.35
12	6.35	7.62
14	7.62	8.89
16	8.89	10.16
18	10.16	11.43
20	11.43	12.70
22	12.70	13.97
24	13.97	15.24
26	15.24	16.51
28	16.51	17.78
30	17.78	19.05
32	19.05	20.32
34	20.32	21.59
36	21.59	22.86
38	22.86	24.13
40	24.13	25.40
42	25.40	26.67
44	26.67	27.94
46	27.94	29.21
48	29.21	30.48
50	30.48	31.75
52	31.75	33.02
54	33.02	34.29
56	34.29	35.56
58	35.56	36.83
60	36.83	38.10
62	38.10	39.37
64	39.37	40.64
66	40.64	41.91

Ordering Grid
BD035 - **XXX** - **X** - **XXXX** - **XXXX** - **XXXX** - **N** - **X** **REQUEST SAMPLES AND QUOTATION**

SPECIFICATIONS 规格:

CURRENT RATING 电流额定值: 1 AMP
 INSULATOR RESISTANCE 绝缘电阻值: 1000 MEGOHMS MIN.
 DIELECTRIC WITHSTANDING 耐电压: AC 300 V
 CONTACT RESISTANCE 接触电阻值: 20mΩ Max.
 OPERATING TEMPERATURE 工作温度: -40°C TO +105°C
 CONTACT MATERIAL 端子物料: COPPER ALLOY
 INSULATOR MATERIAL 绝缘体物料:

STANDARD 标准物料: POLYAMIDE 聚酰胺, NYLON 6T, UL 94-V0
 SOLDERING PROCESS 可焊性:
 NYLON 6T (STANDARD 标准物料) -
 IR REFLOW 回流焊: 260°C for 10 sec.
 WAVE 波峰焊: 230°C for 5-10 sec.
 MANUAL SOLDER 人工焊接: 350°C for 3-5sec

MATES WITH 配套之母座 (SUBJECT TO PIN LENGTH 在端子长度适合的条件下):

BD050 BD055 BD057 BD060 BD064
 BD065 BD067 BD091 BD092 BD093

Contact Plating
 A = Gold Flash All Over
 B = Selective Gold Flash Contact Area/
 Tin On Tail
 C = Tin All Over
 G = 10µ" Gold Contact Area/Tin On Tail
 I = 30µ" Gold Contact Area/Tin On Tail
Standard = Gold Flash All Over

No. of Contacts
 04 to 66

Insulator Height 'H'
 K = 1.0mm
 A = 1.5mm
 G = 1.7mm
 B = 2.0mm
 L = 2.5mm
 M = 2.7mm
 F = 3.0mm
Standard = 2.5mm

Dimension D (1/100mm)
 (Tail Length)
Standard - 2.50mm = 0250
 or specify Dimension D
 e.g. 2.50mm = 0250
 Tol +/- 0.2mm

Dimension C (1/100mm)
 (Post Height)
Standard - 4.80mm = 0480
 or specify Dimension C
 e.g. 2.50mm = 0250
 Tol +/- 0.2mm

Packing Options
G = Plastic Box (Standard)
 D = Tube
 E = Tube with Cap

Insulator Material
N = Nylon 6T (Standard)
 Dimension E (1/100mm)
 (Centre of Pin to Insulator)
 Minimum = 2 x 'H'
 or specify Dimension E
 (See table opposite for standards)
 e.g. 2.50mm = 0250
 Tol +/- 0.2mm

DIMENSION STANDARDS	
INSULATOR HEIGHT 'H'	DIMENSION E
1.00mm	0.20mm
1.50mm	0.30mm
1.70mm	1.30mm
2.00mm	0.80mm
2.50mm	0.80mm
2.70mm	0.20mm
3.00mm	1.20mm

By	VJ	PN	PN	CB	AE
DETAIL	DRAWING RELEASE	SIDE VIEW AMENDED	STANDARD INSULATOR MATERIAL CHANGED	PACKING OPTIONS CHANGED	INSULATOR INFO AMENDED
REV DATE	A 21/12/07	B 17/04/09	C 27/04/09	D 20/05/09	E 27/07/09



Tolerances (Except as noted)	Part Number:-	Date:-
Dimensions in mm X. ± 0.30 X.° ± 5° X.X ± 0.20 X.° ± 2° X.XX ± 0.15 XX° ± 1° X.XXX ± 0.10 XXX° ± 0.5°	BD035	21 DEC 07
Third Angle Projection	Description:- 1.27mm PITCH PIN HEADER, DUAL ROW, THROUGH HOLE, HORIZONTAL	
	© THIS DRAWING IS CONFIDENTIAL AND MUST NOT BE COPIED OR DISCLOSED WITHOUT WRITTEN CONSENT	

GCT

www.globalconnectortechology.com

Scale	Revision	Material	Drawn by	Sheet No.
NTS	E	See Note	VJ	E & OE 1/1