

V1.2 NOTE: THIS DEVICE IS ROHS COMPLIANT.

30.81±0.38

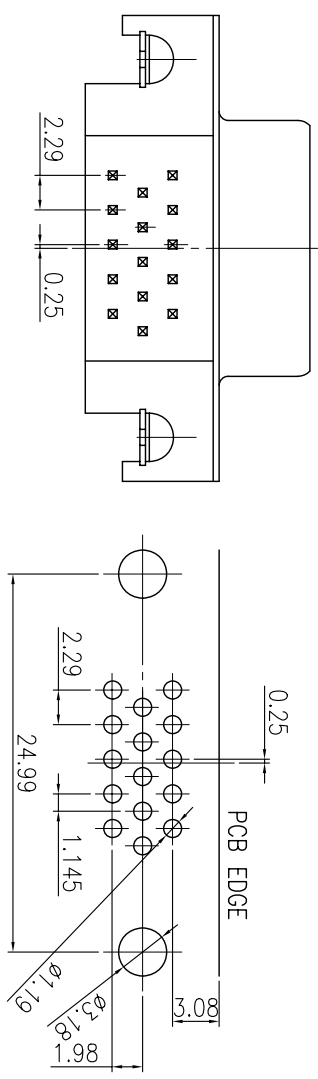
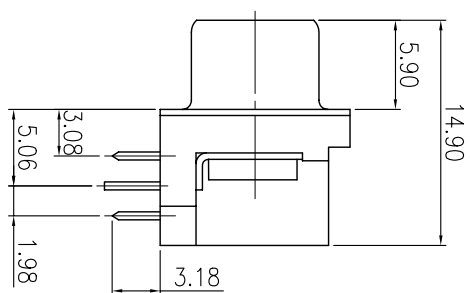
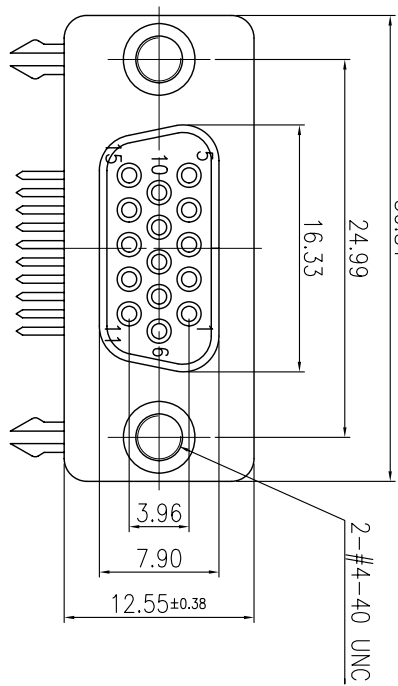

HEX NUTDETAIL (4/1)

RECOMMENDED P.C. BOARD LAYOUT

ORDER INFORMATION:
HDB15X-PdF15GX-2d
HBD: HIGH DENSITY TYPE
15X: SERIES NO.
-150: BLACK VGA CONNECTOR
-151: BLUE VGA CONNECTOR
Pd: PCB TYPE, RIGHT ANGLE
F: FEMALE
15: 15 OF CONTACTS
GX: PLATING OPTION
-Gf: GOLD FLUSH OVER ALL
-Gft: GOLD FLUSH ON CONTACT, TIN PLATING ON SOLDER TAIL
-Gf5t: 15u" GOLD ON CONTACT, TIN PLATING ON SOLDER TAIL
-G30t: 30u" GOLD ON CONTACT, TIN PLATING ON SOLDER TAIL
-2: 2 PRONG BOARD LOCK
α: WITH #4-40UNC THREAD INSERT GROUNDING BRACKET & BOARD LOCK

SYMBOL		DESCRIPTION	DATE	APPROVED	SYM	DISCRIPTION	DATE	APPROVED
Δ	NOTE	ROHS STANDARD	10/NOV/05	AARON	Δ			
Δ					Δ			

**CUSTOMER DRAWING FOR REFERENCE ONLY, SAMPLES APPROVAL ARE REQUIRED!!

047

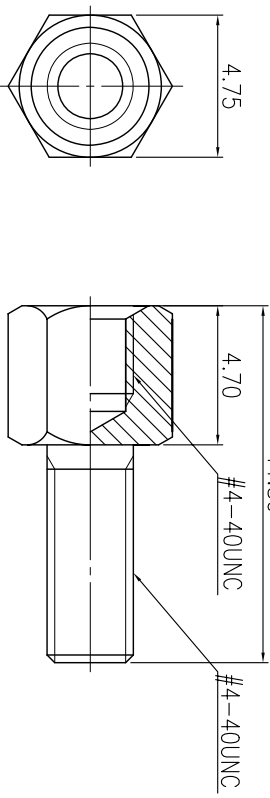

HEX NUT (HSW-4-40) 2PCS ARE OPTIONS

TOLERANCES UNLESS OTHERWISE SPECIFIED		SIGNATURES		DATE	MODEL
±0.25	DRAWN	DAVID	17/oct/03	HD D-SUB CONNECTOR	
mm	CHECKED	ZOLA	17/oct/03	HDB15X-PdF15G-2d	
3/1	APPROVALS				

MMT CORPORATION