

SPECIFICATIONS
 Current Rating: 3A AC,DC
 Voltage Rating: 250V AC,DC
 Temperature Range: -25°C ~ +85°C
 Contact Resistance: 10mΩ Max
 Insulation Resistance: 500MΩ Min
 Withstanding Voltage: 800V AC/minute
 Pin Material: Brass/Tin-plated
 Material: Nylon 66,UL94V-0
 Color: Natural(White)

Ordering Information & Dimensions

PART NO.	Dimensions	
	A	B
A2540WVA-02P	2.50	5.00
A2540WVA-03P	5.00	7.50
A2540WVA-04P	7.50	10.00
A2540WVA-05P	10.00	12.50
A2540WVA-06P	12.50	15.00
A2540WVA-07P	15.00	17.50
A2540WVA-08P	17.50	20.00
A2540WVA-09P	20.00	22.50
A2540WVA-10P	22.50	25.00
A2540WVA-11P	25.00	27.50
A2540WVA-12P	27.50	30.00
A2540WVA-13P	30.00	32.50
A2540WVA-14P	32.50	35.00
A2540WVA-15P	35.00	37.50

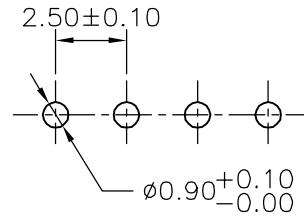
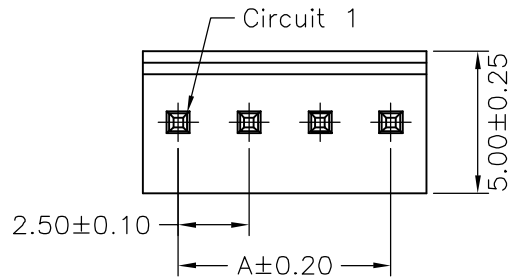
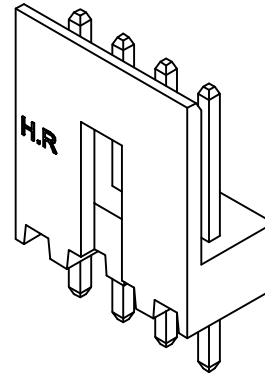

P.C.B. LAYOUT

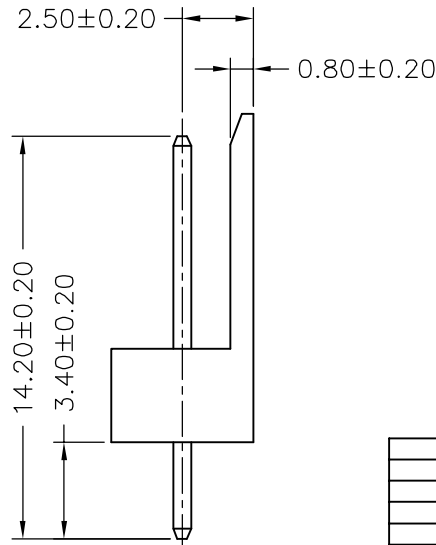
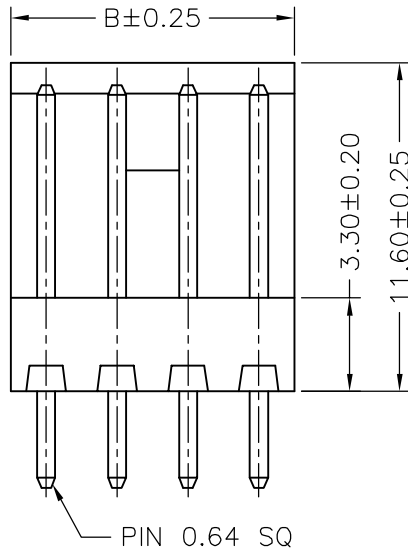

				UNIT: mm SCALE: SHEET: 1 of 1		TITLE: 2.50mm PITCH 180° WAFER
				DRAWN BY: 蕭惠風 APPROVED BY: 謝瑞清 2004.04.05 2004.04.05		
REV.	DESCRIPTION	DATE	X.X±0.25 X.XX±0.15 X.XXX±0.05	ANGLE±		DRAW NO.: A2540WVA-XP REV. B2