

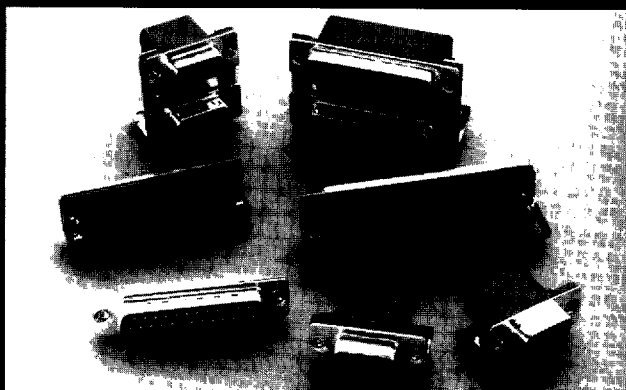

## KYCON D-Subminiature Connectors



### Features

- CSA Certified File No. LR78160 
- UL Recognized File No. E140125 
- Meets EIA, RS232C and RS449 Standards for Data Communication Input/Output Connectors
- Bright Tin Shells for Exceptional Conductivity and Grounding
- Indentations (Dimples) for Exceptional Grounding and Mating Retention
- D Shape Connector Mating and Polarization

### Performance Specifications

#### Materials and Finish

##### Shell

Steel Material, Tin Finish, and Indentations (Dimples) on Plug Only

##### Insert

PBT Thermoplastic, Black Color, 30% Glass Filled, 94V-0 Rated

##### Contact Material

Pin: Brass .040 (1.02) Diameter  
Socket: Phosphor Bronze

##### Contact Finish

Gold Flash Over 0.0001 (0.00254) Nickel on Entire Contact Area with Additional 0.000008 (0.000203) Gold on Mating End of Pin for a Length of .196 (5.0) Min. and .118 (3.0) Min. on the Socket for a Total of 0.00001 (0.000254) Min. of Gold on Mating Area

##### Riveted Insert

Brass Material, Nickel Finish

### Mechanical Characteristics

#### Contact Retention

Precision Machined Contact 10 Lbs  
Precision Formed Contact 10 Lbs

#### Contact Separation Force

4 Oz. Min

#### Contact Engagement Force

9 Oz. Max

#### Durability

500 Insertion Cycles Min  
1,000 Insertion Cycles Min with Nominal Machined Contact Pins

### Electrical Characteristics

#### Contact Current Rating

Precision Machined Contact 7.6 Amps  
Precision Formed Contact 5.0 Amps

#### Contact Resistance

Precision Machined Contact 5 Milliohms Max  
Precision Formed Contact 8 Milliohms Max

#### Dielectric Withstanding Voltage

1000 V AC Min

#### Insulation Resistance

5000 Megohms Min

#### Temperature Rating

-55° To + 125°C

#### Plating Options

Designator	Plating Description
Standard	Gold Flash Over 0.0001 (0.00254) Nickel on the Entire Contact Area
15	0.0001 (0.00254) Nickel on the Entire Contact area with 0.000015 (0.000381) Gold on Mating End of Pin for a Length of .196 (5.0) Min and .118 (3.0) Min on the Socket 0.00015 (0.00381) of Bright Tin-Lead is Plated on the Termination End of the Contact
30	0.0001 (0.00254) Nickel on the Entire Contact area with 0.000030 (0.00076) Gold on Mating End of Pin for a Length of .196 (5.0) Min and .118 (3.0) Min on the Socket 0.00015 (0.00381) of Bright Tin-Lead is Plated on the Termination End of the Contact

9005174 0000004 304



## KF85 Series Dimensions

### High Frequency EMI/RFI Suppression

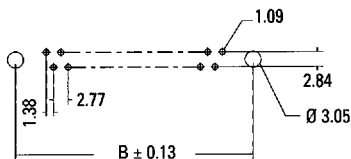
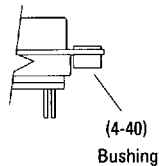
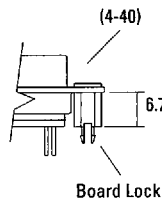
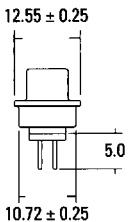
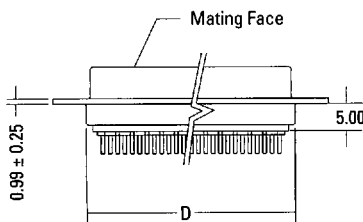
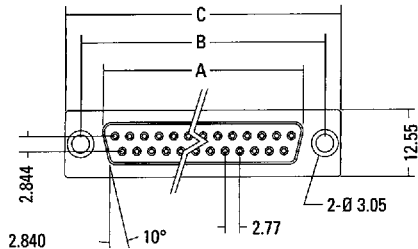

**Recommended P.C. Board Layout  
K85/KF85  
(Top View)**

Dimensions in mm

## Ferrite Specifications

Item	Measured Value	Test Frequency
Z (Ohm)	10 Min	30 MHz
Z (Ohm)	17 Min	50 MHz
Z (Ohm)	35 Min	100 MHz

JS-1035-(4-40) Hex Jack Screws Recommended  
for BR Option

9005174 0000015 19T

## K88 Series Vertical P.C. Mount

### KF88 Series with Ferrite

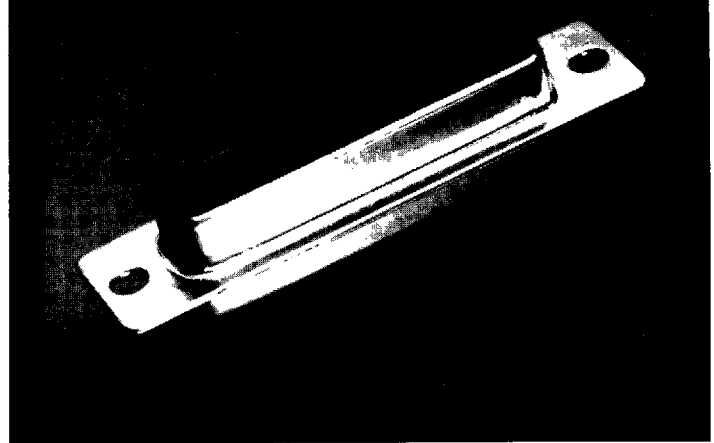

## Ordering Information

K88	-	B	C	-	25	S	-	K	-	
Series		Shell Size	Contact Construction		Number of Contacts	Contact Type		Mounting Options		Plating Options

### Series

K88-Kycon D-Subminiature Connector Vertical  
(P.C. Mount) Termination, High Profile

KF88-Kycon D-Subminiature Connector Vertical (P.C. Mount)  
Termination High Profile, with Ferrite

### Shell Size

- E-9 Contacts
- A-15 Contacts
- B-25 Contacts
- C-37 Contacts

### Contact Construction

- C-Precision Machined
- D-Precision Formed

### Number of Contacts

9, 15, 25, 37

### Contact Type

- P-Pin Contact (Plug)
- S-Socket Contact (Receptacle)

### Mounting Options

- K-with Riveted Threaded (4-40) Bushings
- KJ-with Riveted Threaded (4-40) Bushings and (4-40) Hex Jack Screws Installed
- BR-with (4-40) Riveted Threaded Board Lock

Plating Options (See Page 3)

## K88 Series Dimensions

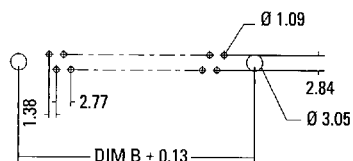
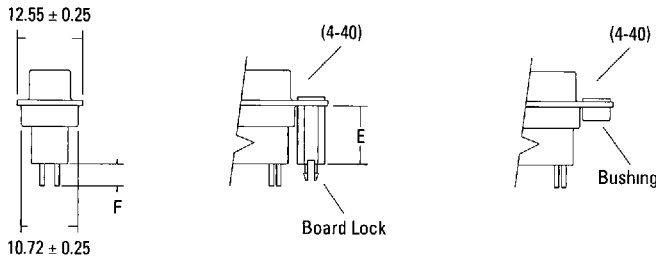
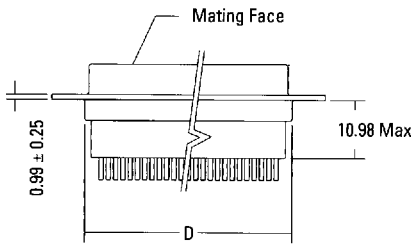
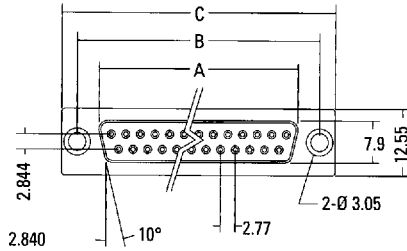

**Recommended P.C. Board Layout  
K88/KF88  
(Top View)**

Number of Contact (Shell Size)	Dimensions (Inch/mm)							
	A	A1	B	C	D	E	F	G
9 (E)	.643 16.33	.666 16.92	.984 24.99	1.231 30.81	.795 19.28	14.5	7.2	2.8
15 (A)	.971 24.66	.994 25.25	1.312 33.32	1.541 39.14	1.083 27.51			
25 (B)	1.511 38.38	1.534 38.96	1.852 47.04	2.088 53.04	1.652 41.30	11.0	3.8	(K88)
37 (C)	2.056 52.22	2.182 55.42	2.500 63.50	2.729 69.32	2.272 57.71			

## KF88 Series Dimensions

### High Frequency EMI/RFI Suppression

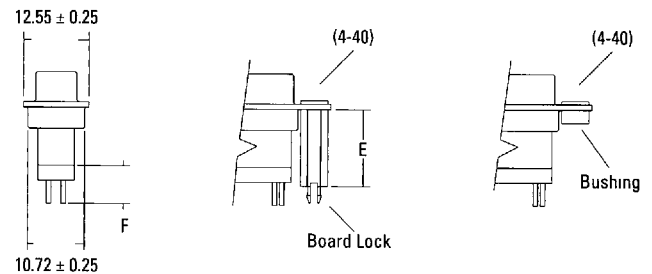
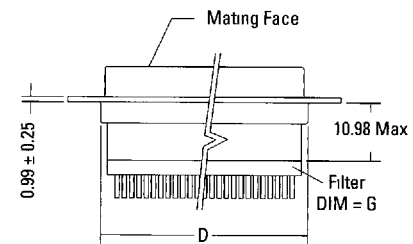
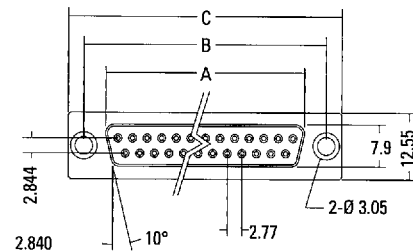

Dimensions in mm

### Ferrite Specifications (Optional)

**G = 1.2**

Item	Measured Value	Test Frequency
Z (Ohm)	10 Min	30 MHz
Z (Ohm)	17 Min	50 MHz
Z (Ohm)	35 Min	100 MHz

### Ferrite Specifications (Standard)

**G = 2.8**

Item	Measured Value	Test Frequency
Z (Ohm)	20 Min	30 MHz
Z (Ohm)	30 Min	50 MHz
Z (Ohm)	50 Min	100 MHz

9005174 0000016 026