

- Series 319, 330 and 399 single row strips may be cut to any length.
- Spring Target connectors present a large flat surface for making tangent connections to our standard .042" dia spring pin plungers. The target connectors provide an excellent gold plated conductive path back to the board mounted spring pin connector.
- Target connectors use MM #1938, #1940, #1941, #1942 and #3024 pins. See page 185 for details.
- Insulators are high temp. thermoplastic.

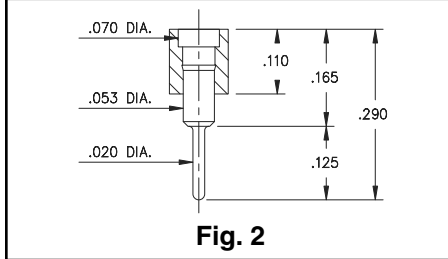

**Ordering Information**

<b>Fig. 1</b>	<b>Series 319...041</b> <b>SMT w/ Alignment Pins</b>
	319-10-1__-30-041000 Specify # of pins      ↳      03-64

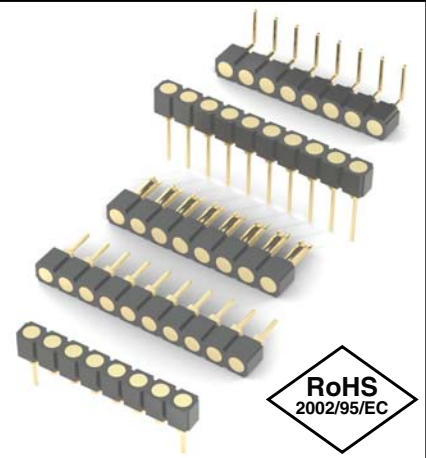
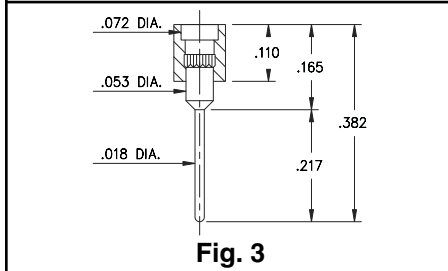

<b>Fig. 2</b>	<b>Series 319...001</b> <b>Standard Solder Tails</b>
	319-10-1__-00-001000 Specify # of pins      ↳      01-64

<b>Fig. 3</b>	<b>Series 319...002</b> <b>Long Solder Tails</b>
	319-10-1__-00-002000 Specify # of pins      ↳      01-64

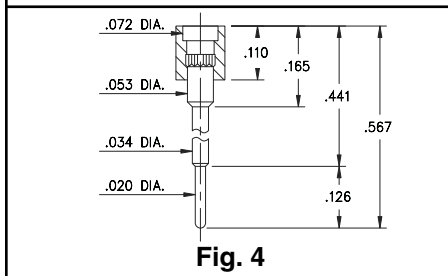

<b>Fig. 4</b>	<b>Series 319...005</b> <b>Elevated Solder Tails</b>
	319-10-1__-00-005000 Specify # of pins      ↳      01-64

<b>Fig. 5</b>	<b>Series 330...240</b> <b>Solder Cups</b>
	330-10-1__-00-240000 Specify # of pins      ↳      01-64

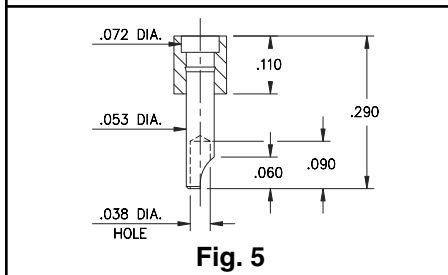

<b>Fig. 6</b>	<b>Series 399...008</b> <b>Right Angle Solder Tails</b>
	399-10-1__-10-008000 Specify # of pins      ↳      01-64

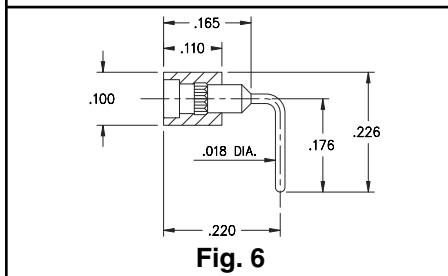

For Electrical,  
Mechanical & Environmental  
Data, See pg. 4

PLATING CODE =	10			
Pin Plating	10 μ" Au			

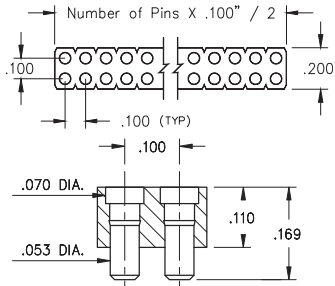

Coplanarity .005". For Pin Counts >20 positions consult Technical Support.

Fig. 1

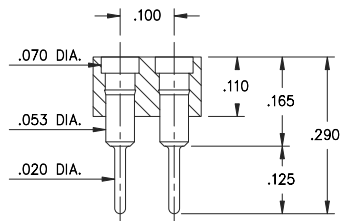

Fig. 2

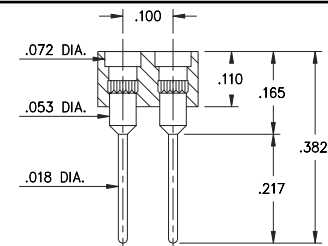

Fig. 3

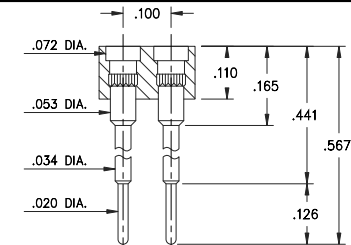

Fig. 4

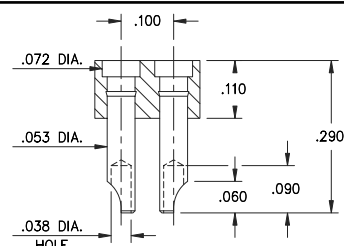

Fig. 5

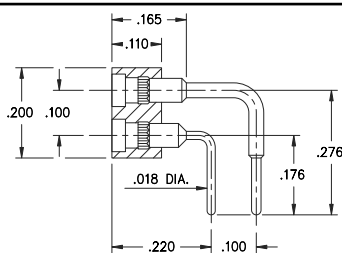
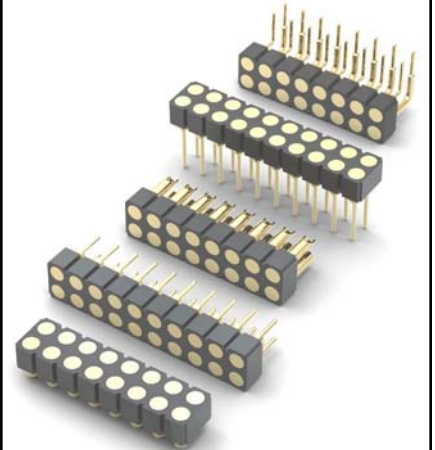

Fig. 6

- Series 419, 430 and 499 double row strips may be cut to any length.
- Spring Target connectors present a large flat surface for making tangent connections to our standard .042" dia spring pin plungers. The target connectors provide an excellent gold plated conductive path back to the board mounted spring pin connector.
- Target connectors use MM #1938, #1940, #1941, #1942 and #3024 pins. See page 185 for details.
- Insulators are high temp. thermoplastic.



Ordering Information

Fig. 1	Series 419...041	Surface Mount
	419-10-2_ _ -30-041000	Specify # of pins → 04-64
Fig. 2	Series 419...001	Standard Solder Tails
	419-10-2_ _ -00-001000	Specify # of pins → 04-64
Fig. 3	Series 419...002	Long Solder Tails
	419-10-2_ _ -00-002000	Specify # of pins → 04-64
Fig. 4	Series 419...005	Elevated Solder Tails
	419-10-2_ _ -00-005000	Specify # of pins → 04-64
Fig. 5	Series 430...240	Solder Cups
	430-10-2_ _ -00-240000	Specify # of pins → 04-64
Fig. 6	Series 499...008	Right Angle Solder Tails
	499-10-2_ _ -10-008000	Specify # of pins → 04-64

For Electrical, Mechanical & Environmental Data, See pg. 4



PLATING CODE =	10		
Pin Plating	10 μ" Au		