

P.C.B. LAYOUT

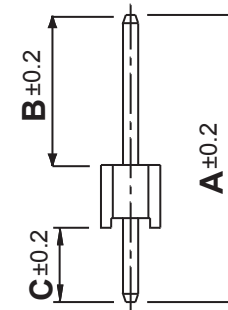
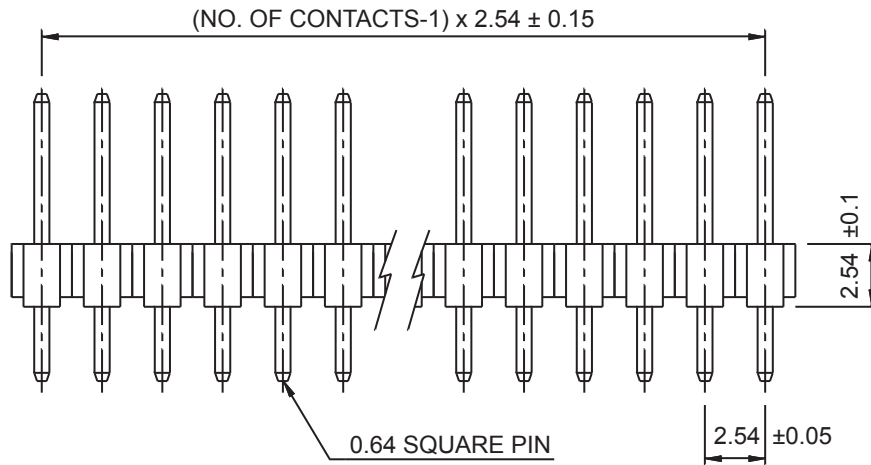

DIMENSION NUMBER	A	B	C
0002	9.54	4.00	3.00
0011	11.33	6.00	2.79
0001	11.60	5.90	3.16
1180	11.80	6.10	3.16

**HOW TO ORDER:**

H 1 1 1 - X X X X - X X X - Z R

**CONTACT MATERIAL:**  
1 - COPPER ALLOY

**DIMENSION NUMBER:**  
SEE DIMENSION NUMBER ABOVE

**NUMBER OF CONTACTS:**  
01 thru 98  
A0=100

**PLATING OVERALL:**  
0 - FULL TIN  
1 - FULL Au FLASH  
3 - 10u" Au  
4 - 15u" Au  
5 - 30u" Au

**IR REFLOW COMPATIBLE**  
260°C

**RoHS COMPLIANT**

**NUMBER OF ROWS:**  
1 - SINGLE ROW

**SELECTIVE PLATING:**  
6 - Au FLASH CONTACT AREA/TIN TAIL  
7 - 10u" Au CONTACT AREA/TIN TAIL  
8 - 15u" Au CONTACT AREA/TIN TAIL  
9 - 30u" Au CONTACT AREA/TIN TAIL

**ELECTRICAL:**

CURRENT: 1 AMP  
CONTACT RESISTANCE: 30 Milliohms Max.  
INSULATOR RESISTANCE: 1000 Megaohms Min  
DIELECTRIC WITHSTANDING VOLTAGE: 500VAC FOR 1 MIN.  
OPERATING TEMPERATURE: -55° C TO +105° C

**MATERIAL**

INSULATOR OPTIONS: PBT & 30% Glass Fiber UL94V-0  
NYLON 6T UL94V-0 ( 260 C Rated - 10 Sec) - Add R to Part Number  
CONTACT: Copper Alloy  
PLATING: Gold and/or Matte Tin over 50 Microinches Nickel

Rev		Apv.	Date
0	Issued	S.E.	10/1/97
A	Revised For RoHS Compliance	A.M.	7/12/05
B	Revised For Reflow Compatible	WHS	5/19/06

**SMP TECHNOLOGY, INC.**

SCALE	MAT'L	FINISH	ANGLE +/-	UNIT: mm
TOL. DEC.	.X +/- 0.35	.XX +/- 0.25	.XXX +/-	

PIN HEADER, 2.54mm PITCH, STRAIGHT  
SERIES: H1 11 - X X X X - X X X - Z R  
Pg: 1