

TRIANGLE INDICATES POSITION 1

LEFT POLARIZING SLOT SEE TABLE

CENTRAL POLARIZING KEY

RIGHT POLARIZING SLOT SEE TABLE

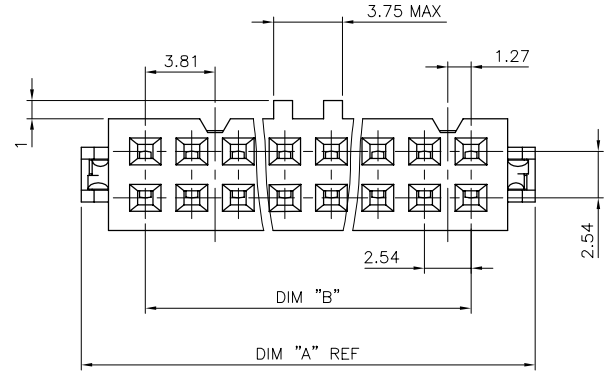

COVER ORIENTATION

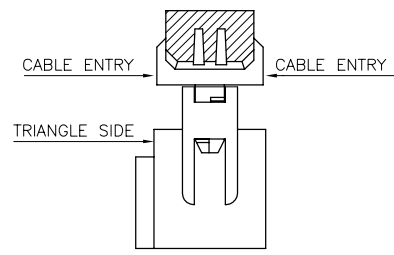

NOTES:

- MATERIAL: BASE AND COVER: 30% GLASS FILLED POLYESTER FLAME RETARDANT PER UL-94-V0  
COLOUR GREY  
STRAIN RELIEF: UNREINFORCED THERMOPLASTIC FLAME RETARDANT PER UL-94-V0  
COLOUR GREY  
CONTACT: PHOSPHOR BRONZE
- PLATING: 1.9 µm Au OVER 1.27 µm Ni  
IN CONTACT AREA REMAINDER OF PRODUCT (IDC PART)  
1.27 µm TIN LEAD OVER 1.27 µm Ni
- TRIANGLE NOT MOLDED-IN ON 2x2 AND 2x3 POSITIONS WITH CENTRAL KEY
- FOR PRINTING SPECIFICATION SEE TA 812.

CUSTOMER COPY FOR REFERENCE ONLY

mat'l. code		SEE NOTES		tolerances unless otherwise specified		CUSTOMER COPY			
ltr	ecr no	dr	date	linear		projection			
H	F40427	PNZ	94.07.27					title	QUICKIE III FEM
J	F10566	DLE	01.10.24					size	1.9 µm Au
K	F03019	DLE	03.01.23	angles				product family	QKIE FEM
				dr	VAUTHIER	91.09.24	mm [inch]	code	213
				engr	JM PHAMVAN	94.07.27	scale	sheet	1 of 2
				chr	O MATHEVON	94.07.27	5:1	size	71907
				appd	JM P	94.07.27			
sheet	revision	K	K						
index	sheet	1	2						

PRODUCT NUMBER	SIZE	DIM "A"	DIM "B"	DIM "C"	DIM "S"	SLOT STYLE
71907-X04	2x 2	9.54	2.54	9.46	5.66	NO SLOT
71907-X06	2x 3	12.08	5.08	12.00	8.20	RIGHT IF NO KEY
71907-X08	2x 4	14.62	7.62	14.54	10.74	RIGHT IF NO KEY
71907-X10	2x 5	17.16	10.16	17.08	13.28	RIGHT SLOT
71907-X14	2x 7	22.24	15.24	22.16	18.36	RIGHT SLOT
71907-X16	2x 8	24.78	17.78	24.70	20.90	2 SLOTS
71907-X18	2x 9	27.32	20.32	27.24	23.44	2 SLOTS
71907-X20	2x 10	29.86	22.86	29.78	25.98	2 SLOTS
71907-X24	2x 12	34.94	27.94	34.85	31.06	2 SLOTS
71907-X26	2x 13	37.48	30.48	37.40	33.60	2 SLOTS
71907-X30	2x 15	42.56	35.56	42.48	38.68	2 SLOTS
71907-X34	2x 17	47.64	40.64	47.56	43.76	2 SLOTS
71907-X40	2x 20	55.26	48.26	55.18	51.38	2 SLOTS
71907-X44	2x 22	60.34	53.34	60.26	56.46	2 SLOTS
71907-X50	2x 25	67.96	60.96	67.88	64.08	2 SLOTS
71907-X60	2x 30	80.66	73.66	80.58	76.78	2 SLOTS
71907-X64	2x 32	85.74	78.74	85.66	81.86	2 SLOTS

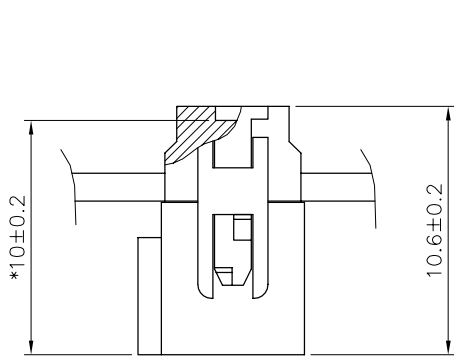

WITHOUT STRAIN RELIEF

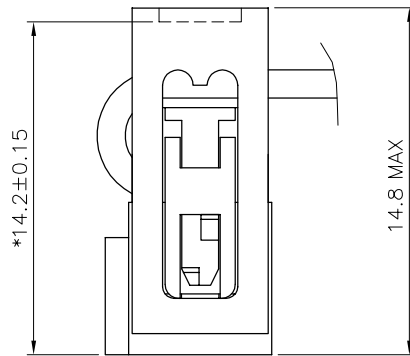

WITH LOW PROFILE STRAIN RELIEF

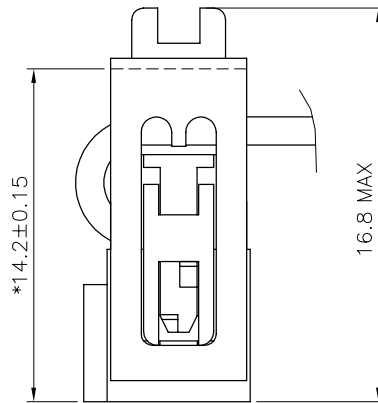

WITH STANDARD STRAIN RELIEF

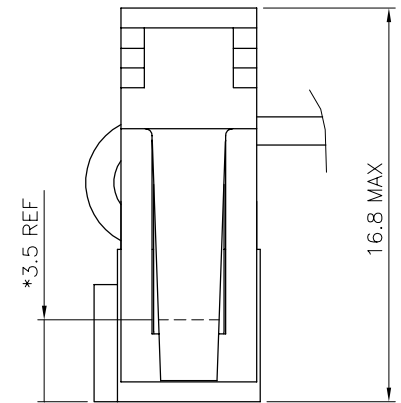

WITH LATCHING STRAIN RELIEF

AFTER TERMINATION SIDE VIEW OF ASSEMBLY (\* LATCHING DIM ON HEADER)

71907-7YY		●				●	
71907-6YY	●					●	
71907-5YY		●			●		504 530
71907-4YY		●		●			
71907-3YY		●	●				304
71907-2YY	●				●		204 230
71907-1YY	●				●		
71907-0YY	●		●				004
PRODUCT NUMBER	WITH CENTRAL KEY	WITHOUT CENTRAL KEY	STANDARD STRAIN RELIEF	WITHOUT STRAIN RELIEF	LOW PROFILE STRAIN RELIEF	LATCHING STRAIN RELIEF	DASHES NOT AVAILABLE

mat'l. code		tolerances unless otherwise specified		CUSTOMER COPY		FCI ELECTRONICS	
ltr	ecn no	dr	date	linear	projection	title	www.fciconnect.com
H	F40427	PNZ	94.07.27			QUICKIE III FEM	
J	F10566	DLE	01.10.24			1.9 μm Au	
K	F03019	DLE	03.01.23	angles		product family	code
					mm [inch]	QKIE FEM	213
		dr	VAUTHIER	91.09.12		size	sheet
		enr	JM PHAMVAN	94.07.27	scale	71907	2 of -
		chr	O MATHEVON	94.07.27	N/A		
		app	JM P	94.07.27			
sheet index	revision sheet						