

SINGLE ROW RIGHT ANGLE PIN HEADER



2567 SERIES. 2.54 mm (0.100") pitch.

General Features

- Available in 2 through 40 circuits
- Mates with sockets 2.54 mm pitch 2101, 2550, 2595, 2596, 2553, 2554, 2247, 2551, 2552, 2577, 2102, 2106 & 2452 series
- 0,64 mm. square pin with different plating
- Different pin length
- Consult Sales Office

Materials

- Insulator: High temperature thermoplastic UL 94 V-0
- Contact: brass
- Operating temperature: -40°C to +105°C
- RoHS compliant

Dimensional Information

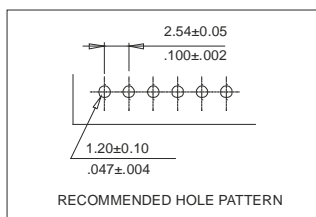
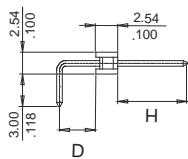
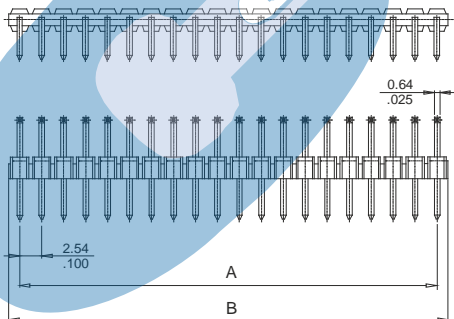
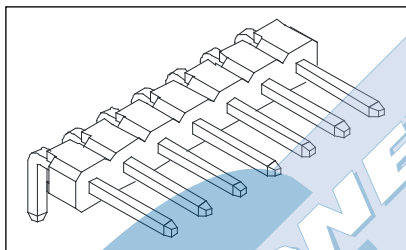

Dimensions: (In mm.)

A = 2.54 x (XX*-1)

B = 2.54 x (XX*)

* XX (Number of circuits)

Electrical Features

- Voltage rating: < 250V
- Current rating: < 3 A
- Contact resistance: < 20 mΩ
- Dielectric withstanding voltage: 600 V AC/minute
- Insulation resistance: >1000 MΩ
- Capacitance: < 2 pF at 1 KHz

Mechanical Features

- Pin retention force to insulator: > 0,50 Kgf
- Durability: 50 cycles

Ordering Information:

2567 - T- XX- C E
 1 2 3 4 5

1. Connector Series

2. (T) Contact Plating

- T = 2. Tin plated
 - T = 3. Gold flash over nickel
- Recommended Finish

- T = 5. 15μ" gold over nickel
- T = 6. 30μ" gold over nickel

3. (XX) Number of circuits

- Available in 2 through 40 circuits

5. (C) Pin Dimensions

- C = 0. H = 2.80 mm. D = 1.50 mm.
- C = 2. H = 6.85 mm. D = 1.50 mm.
- C = 3. H = 7.26 mm. D = 1.50 mm.
- C = 4. H = 8.00 mm. D = 1.50 mm.
- C = 5. H = 3.30 mm. D = 3.30 mm.
- C = 6. H = 6.26 mm. D = 1.50 mm.
- C = 7. H = 8.86 mm. D = 1.50 mm.
- C = 8. H = 5.86 mm. D = 1.50 mm.
- C = 9. H = 6.00 mm. D = 1.50 mm.
- C = 10. H = 15.00 mm. D = 1.50 mm.
- C = 15. H = 9.00 mm. D = 3.00 mm.
- C = 16. H = 25.00 mm. D = 3.00 mm.
- C = 17. H = 6.00 mm. D = 2.00 mm.
- C = 18. H = 8.00 mm. D = 3.20 mm.
- C = 19. H = 3.40 mm. D = 1.50 mm.
- C = 20. H = 10.65 mm. D = 1.50 mm.

6. (E) Packing Options

- E = 1. Tube + Pad
- E = 2. Reel + Pad