

CUSTOMER INFORMATION SHEET

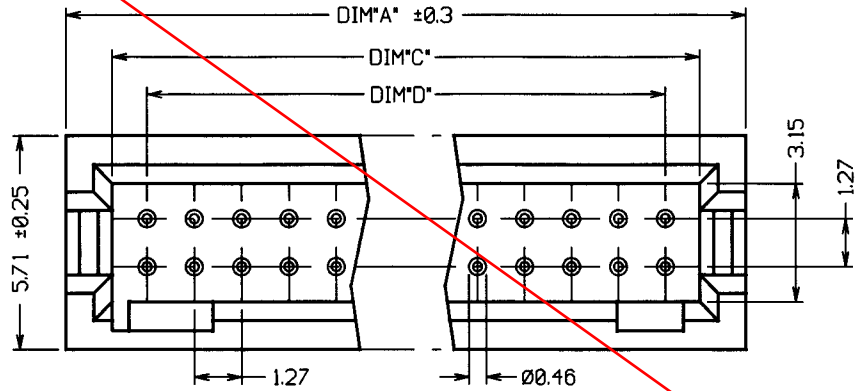

PART NUMBER	No. WAYS	DIM "A"	DIM "B"	DIM "C"	DIM "D"
M50-4720805	8+8	13.36	11.94	11.50	8.89
M50-4721005	10+10	15.80	14.48	13.30	11.43
M50-4721505	15+15	22.15	20.83	19.65	17.78
M50-4722005	20+20	28.50	27.18	26.00	24.13
M50-4722505	25+25	34.85	33.53	32.35	30.48
M50-4723005	30+30	41.20	39.88	38.70	36.83
M50-4723505	35+35	47.55	46.23	45.05	43.18
M50-4724005	40+40	53.90	52.58	51.40	49.53
M50-4725005	50+50	66.60	65.28	64.10	62.23

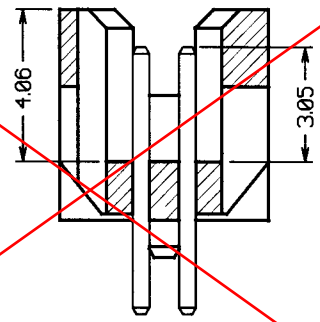
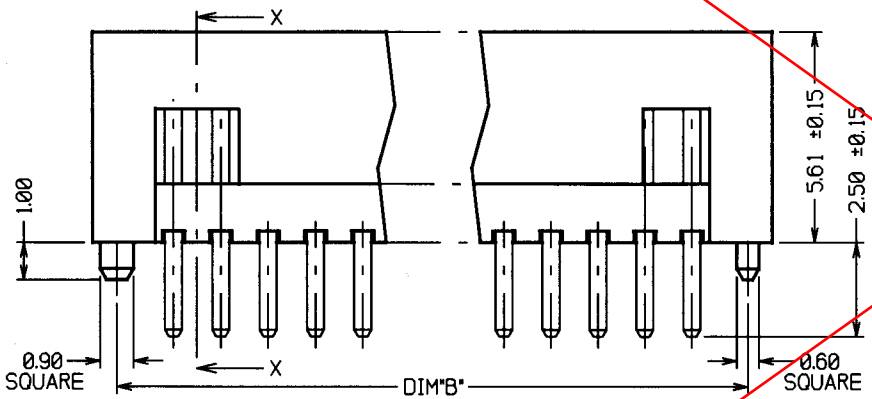

OBSOLETE

ORDER CODE

M50-472XX05

NUMBER OF WAYS _____

PER ROW _____

FINISH _____

GOLD

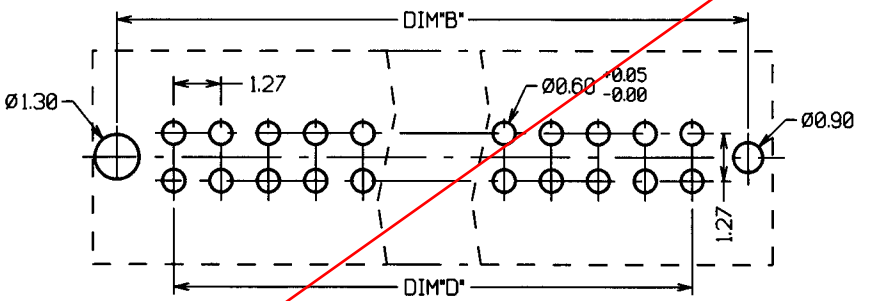

SECTION X-X

MATERIALS:-

- MOULD - LVP UL94V-0 (BLACK)
- PINS - BRASS
- FINISH - GOLD

SPECIFICATION

- CURRENT RATING - 10A
- VOLTAGE RATING - 150V AC
- DIELECTRIC STRENGTH - 500V ONE MINUTE
- TEMPERATURE RANGE - -40°C TO +150°C

2	13.05.96	3299
1	05.10.94	
ISS.	DATE	C/N
APPROVED: <i>[Signature]</i>		
CHECKED: <i>[Signature]</i>		
DRAWN: A LIOTTA		
CUSTOMER REF.		
ASSEMBLY DRG:		



HARWIN INC U.S.A. TEL: (812) 285 0055 FAX: (812) 285 0056	HARWIN PLC U.K. TEL: (0705) 370451 FAX: (0705) 324010	HARWIN PTE SINGAPORE TEL: 7794909 FAX: 7793868
--	--	---

TOLERANCES X. - ±1mm X.X - ±0.25mm X.XX - ±0.10mm X.XXX - ±0.01mm ANGLES - ±1° UNLESS STATED	MATERIAL: SEE SHEET 1	TITLE: 1.27mm PITCH THRU BOARD DUAL ROW HEADER
	FINISH: SEE ABOVE	DRAWING NUMBER: M50-472XX05
	S/AREA: mm²	SHT 2 OF 2