

RECEPTACLE

HI	REV -P2 OPTION UCR #2002-0773 3-20-02 BW
H	ADD PLUG OPTION UCR #2002-0715 2-25-02 RW
G	REVISED UCR1999-0301 WANG 98-11-10
F2	REVISED UCR1998-0128 WANG 98-04-08
F1	ADD -4P IRD W/EDP ECR U3 0034 GWC 1/8/93 RW
F	DEL 94V-0 MAT'L ECR U2-1699 AFC 92-11-20 RW
E	REVISE PER ECR U2 0211 GWC 2/10/92 RW
D	REVISED PER ECR #U00189 7-5-90 TRM
C	REVISED LATCH ECR #U90011 KBW 03-31-89 RW
B	REV. PICTORIALY ECR U8 2272 GEP 12-15-88 RW
A	ADDED OPTIONS ERO 27336 KBW 10-10-88 RW
I	*X REL PER ERO 27234 GEP 9-21-88 RW

3	HI
2	H
1	HI

DIMENSIONS SHOWN (METRIC) INCH	
UNLESS OTHERWISE SPECIFIED TOLERANCES: ANGULAR ± .000°	
3 PLACE	± .007
2 PLACE	± .010 ± 0.18
1 PLACE	± 0.25
DRAFT WHERE APPLICABLE MUST REMAIN WITHIN DIMENSIONS	
DRWG. BY	GEP
CHK'D. BY	RW
APP'D. BY	RAS
SCALE	2 : 1

▽ = 0	▼ = 0	REVISE ONLY ON CAD SYSTEM
TITLE .125/(3.17) HOUSING, PLUG AND RECEPTACLE, 4 CKT., .330/(8.38) CTRS.		
MOLEX INCORPORATED LITSE,ILL. 60532	SHEET NO. 1 OF 3	DATE 9/21/88
PART NO. SD-42179-4*	DRWG. NO.	
SEE CHART		
FILE NAME S421794X1.DGN	THIS DRAWING CONTAINS INFORMATION THAT IS PROPRIETARY TO MOLEX INC. AND SHOULD NOT BE USED WITHOUT WRITTEN PERMISSION	DIV. CP

42179

NO P.S. 1

PLUG	
PART NO.	ENG. NO.
03-12-2046	42179-4PI
03-12-2045	42179-4P
03-12-7042	42179-4PYW
03-12-7043	42179-4PIYW
03-12-7040	42179-4PBK
03-12-7041	42179-4PIBK
03-12-7044	42179-4PIRD
03-12-7045	42179-4P2

RECEPTACLE	
PART NO.	ENG. NO.
03-12-1046	42179-4RI
03-12-6040	42179-4RIBK
03-12-6041	42179-4RIYW

LEGEND:

42179-4***

CIRCUIT SIZE: _____
HOUSING TYPE: _____
P = PLUG
R = RECEPTACLE
FEATURE OPTIONS: _____
BLANK = WITH MOUNTING EARS (PLUG ONLY)
1 = WITHOUT MOUNTING EARS
2 = WITH MOUNTING EARS (PLUG ONLY);
WITHOUT LOCKING RAMP

COLOR: _____
BLANK = 94V-2: TRANSLUCENT NATURAL COLOR
AM=AMBER BK=BLACK BU=BLUE
BN=BROWN GY=GRAY GN=GREEN
OR=ORANGE RD=RED YW=YELLOW

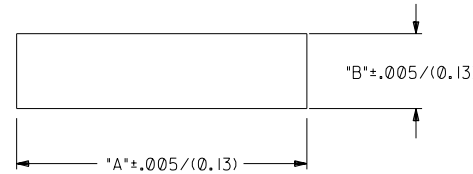
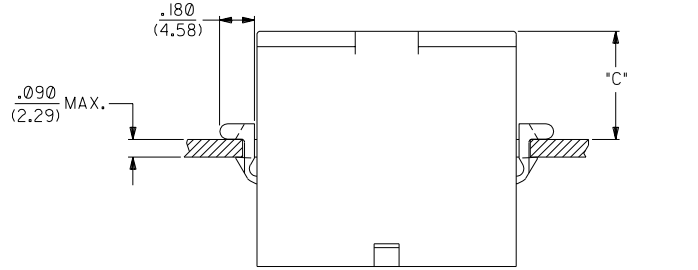

RECOMMENDED PANEL OPENING

HOUSING	DIM. "A"	DIM. "B"	DIM. "C"
PLUG	1.511/(38.38)	.440/(11.18)	.57/(14.5)

NOTES:

1. MATERIAL: NYLON (PA), UL94V-2, COLOR-NATURAL (TRANSLUCENT)
2. FINISH: NONE
3. PRODUCT SPECIFICATION: NONE
4. PART ACCEPTS A MAXIMUM .250/(6.35) INSULATION DIAMETER WIRE.
5. FOR USE WITH ALL MOLEX .125/(3.17) DIAMETER SERIES TERMINALS EXCEPT THE I219/I220 SERIES.

F2	SEE SHEET I
F1	SEE SHEET I
F	SEE SHEET I
D	SEE SHEET I
B	SEE SHEET I
HI	SEE SHEET I
H	SEE SHEET I
LTR.	REVISIONS

DRWG. BY	GEP	CHK'D. BY	RW
APP'D. BY	RAS	SCALE	2 : 1

DIMENSIONS SHOWN (METRIC) INCH
UNLESS OTHERWISE SPECIFIED
TOLERANCES: ANGULAR ± .5°

5 PLACE	± .007	---
2 PLACE	± .010	± 0.18
1 PLACE	---	± 0.25

DRAFT WHERE APPLICABLE MUST REMAIN WITHIN DIMENSIONS

FILE NAME	5421794X3
DRWG. NO.	SD-42179-4*

SEE CHART

THIS DRAWING CONTAINS INFORMATION THAT IS PROPRIETARY TO MOLEX INC. AND SHOULD NOT BE USED WITHOUT WRITTEN PERMISSION.