

CRSH8-40FP
CRSH8-60FP
CRSH8-100FP

SILICON SCHOTTKY RECTIFIERS
8.0 AMP, 40 THRU 100 VOLT



TO-220FP-2 CASE



www.centrasemi.com

DESCRIPTION:

The CENTRAL SEMICONDUCTOR CRSH8-40FP series are silicon Schottky rectifiers designed for fast switching applications requiring a low forward voltage drop.

MARKING: FULL PART NUMBER

FEATURES:

- High reliability
- High current capability
- UL flammability classification 94V-O
- Low power loss, high efficiency
- Low forward voltage
- High surge capacity
- High voltage

MAXIMUM RATINGS: (T_C=25°C unless otherwise noted)

SYMBOL	CRSH8	CRSH8	CRSH8	UNITS	
	-40FP	-60FP	-100FP		
Peak Repetitive Reverse Voltage	V _R RM	40	60	100	V
DC Blocking Voltage	V _R	40	60	100	V
RMS Reverse Voltage	V _R (RMS)	28	42	70	V
Average Forward Current (T _C =100°C)	I _O		8.0		A
Peak Forward Surge Current (tp=8.3ms)	I _{FSM}		150		A
Critical Rate of Rise of Reverse Voltage	dV/dt		10,000		V/μs
Operating and Storage Junction Temperature	T _J , T _{stg}		-65 to +150		°C
Typical Thermal Resistance	θ _{JA}		50		°C/W
Typical Thermal Resistance	θ _{JC}		4.0		°C/W

ELECTRICAL CHARACTERISTICS: (T_C=25°C unless otherwise noted)

SYMBOL	TEST CONDITIONS	CRSH8-40FP		CRSH8-60FP		CRSH8-100FP		UNITS
		TYP	MAX	TYP	MAX	TYP	MAX	
I _R	V _R =Rated V _R RM	-	100	-	100	-	100	μA
I _R	V _R =Rated V _R RM, T _C =125°C	-	15	-	15	-	15	mA
V _F	I _F =8.0A	-	0.65	-	0.75	-	0.85	V
V _F	I _F =8.0A, T _C =125°C	-	0.57	-	0.65	-	0.75	V
V _F	I _F =16A	-	0.84	-	0.95	-	1.1	V
V _F	I _F =16A, T _C =125°C	-	0.72	-	0.85	-	1.0	V
C _J	V _R =4.0V, f=1.0MHz	300	-	300	-	300	-	pF

CRSH8-40FP
 CRSH8-60FP
 CRSH8-100FP

SILICON SCHOTTKY RECTIFIERS
 8.0 AMP, 40 THRU 100 VOLT



TO-220FP-2 CASE - MECHANICAL OUTLINE

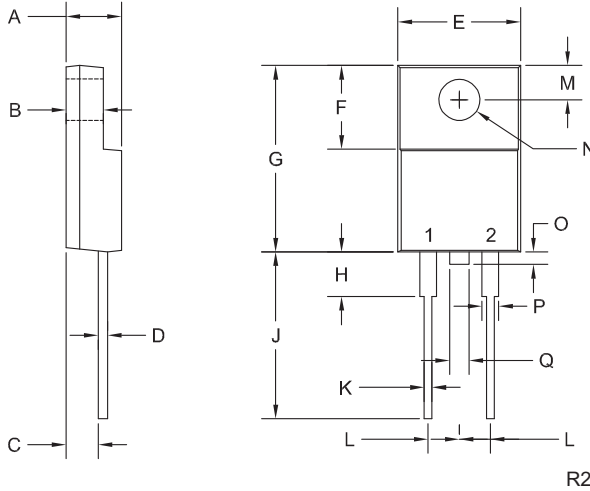

SYMBOL	INCHES		MILLIMETERS	
	MIN	MAX	MIN	MAX
A	-	0.189	-	4.80
B	-	0.123	-	3.12
C	0.098	0.114	2.50	2.90
D	-	0.032	-	0.81
E	-	0.406	-	10.31
F	0.248	0.272	6.30	6.90
G	0.583	0.606	14.80	15.40
H	-	0.161	-	4.10
J	0.512	0.543	13.00	13.80
K	-	0.035	-	0.90
L	0.100		2.55	
M	0.100	0.112	2.55	2.85
N (DIA)	0.118	0.134	3.00	3.40
O	-	0.063	-	1.60
P	-	0.055	-	1.40
Q	-	0.071	-	1.80

TO-220FP-2 (REV: R2)

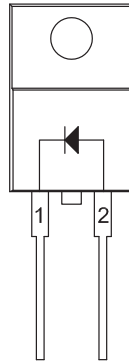

LEAD CODE:

- 1) Cathode
- 2) Anode

MARKING:

FULL PART NUMBER

R2 (9-September 2013)

OUTSTANDING SUPPORT AND SUPERIOR SERVICES



PRODUCT SUPPORT

Central's operations team provides the highest level of support to insure product is delivered on-time.

- Supply management (Customer portals)
- Inventory bonding
- Consolidated shipping options
- Custom bar coding for shipments
- Custom product packing

DESIGNER SUPPORT/SERVICES

Central's applications engineering team is ready to discuss your design challenges. Just ask.

- Free quick ship samples (2nd day air)
- Online technical data and parametric search
- SPICE models
- Custom electrical curves
- Environmental regulation compliance
- Customer specific screening
- Up-screening capabilities
- Special wafer diffusions
- PbSn plating options
- Package details
- Application notes
- Application and design sample kits
- Custom product and package development

REQUESTING PRODUCT PLATING

1. If requesting Tin/Lead plated devices, add the suffix " TIN/LEAD" to the part number when ordering (example: 2N2222A TIN/LEAD).
2. If requesting Lead (Pb) Free plated devices, add the suffix " PBFREE" to the part number when ordering (example: 2N2222A PBFREE).

CONTACT US

Corporate Headquarters & Customer Support Team

Central Semiconductor Corp.
145 Adams Avenue
Hauppauge, NY 11788 USA
Main Tel: (631) 435-1110
Main Fax: (631) 435-1824
Support Team Fax: (631) 435-3388
www.centrasemi.com

Worldwide Field Representatives:
www.centrasemi.com/wwreps

Worldwide Distributors:
www.centrasemi.com/wwdistributors

For the latest version of Central Semiconductor's **LIMITATIONS AND DAMAGES DISCLAIMER**, which is part of Central's Standard Terms and Conditions of sale, visit: www.centrasemi.com/terms