

Material:

Insulator: Thermoplastic UL94V-0, Color: White

Contact: Phosphor Bronze

Plating: Tin plated 100u" min. over 30~50u" nickel overall

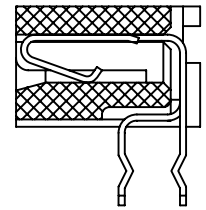
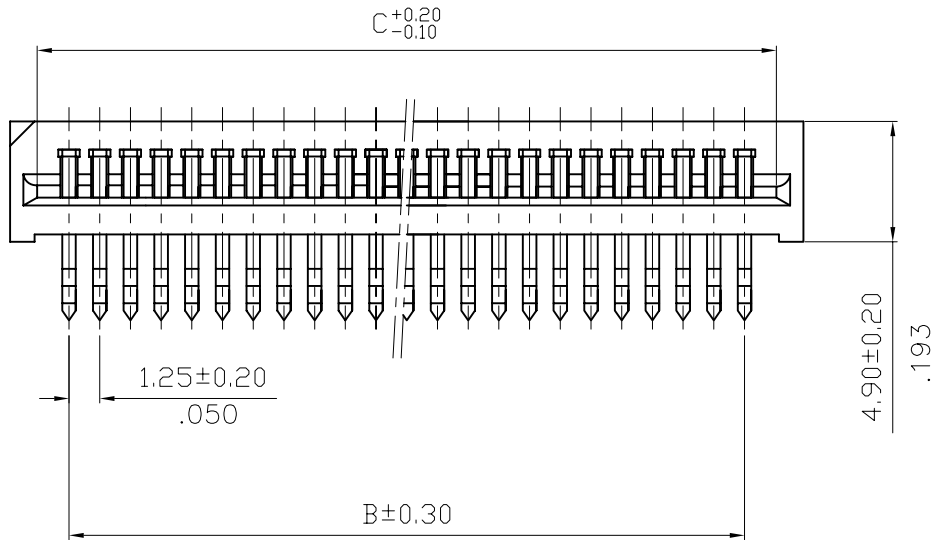

(Upper contact)

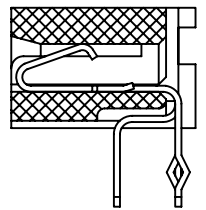

(Lower contact)

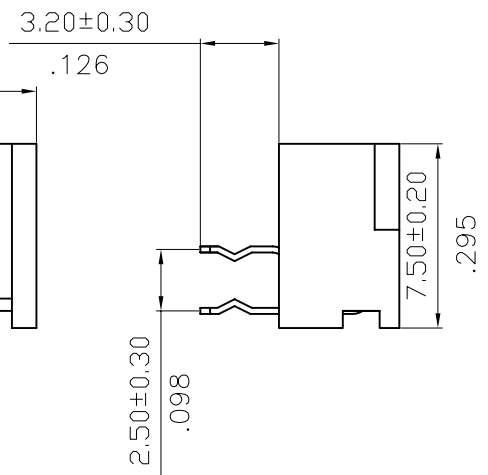
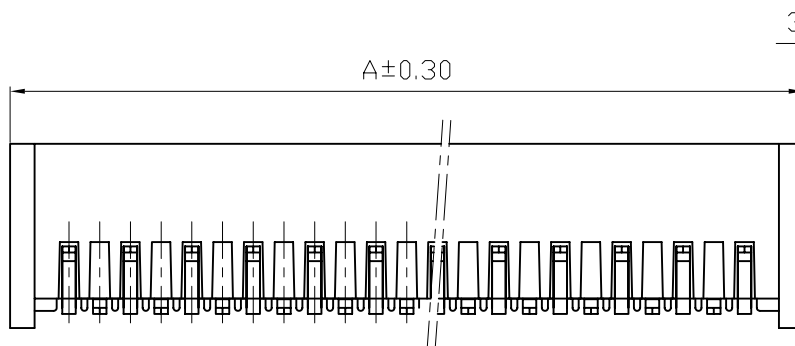

$A = \text{Contacts} \times 1.25 + 3.55$   
 $B = (\text{Contacts} - 1) \times 1.25$   
 $C = \text{Contacts} \times 1.25 + 1.35$

				<b>leoco</b> LEOCO CORPORATION		APPROVED:		PART NO.: 1257S**HT*0				
				GENERAL TOLERANCE		DATE:		CHECKED:				
				X. ±	X. ± 2°	DATE:		TITLE: 1.25mm FPC/FFC				
B	ES060518			.X ± $\frac{0.30}{.012}$	.X ± 1°	DRAWN:		DRAWING NO.: 125702S				
A	DWG REL			.XX ± $\frac{0.20}{.008}$	.XX ± 0.5°	DATE:						
REV.	ECO. NO.	CHG.	APP.	.XXX ± $\frac{0.10}{.004}$	.XXX ± 0.1°			UNITS	SCALE	SIZE	SHEET	REV.
								$\frac{\text{mm}}{\text{inch}}$		A4	1/2	B

Specification

Current: 1 Amp

Operating Voltage: 30V DC/AC

Operating Temperature: -40°C to 85°C

Contact Resistance: 30mΩ max.

Insulation Resistance: 500 MΩ min.

Withstanding Voltage: AC 500 Volts (r.m.s.)

Ordering Information:

1257S  $\frac{**}{1}$  H T  $\frac{*}{2} \frac{*}{3}$

1. No. of Circuits

02 to 40 Circuits

2. 1 = Upper contact (Material: PBT)

T = Upper contact (Material: PA46)

2 = Lower contact (Material: PBT)

S = Lower contact (Material: PA46)

3. Packing options:

0= Tube Type (standard product)

A= Tray Type (standard product)

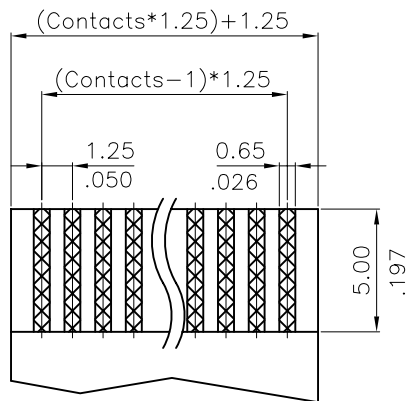

FFC/FPC Dimension  
Thickness  $0.30 \pm 0.05$

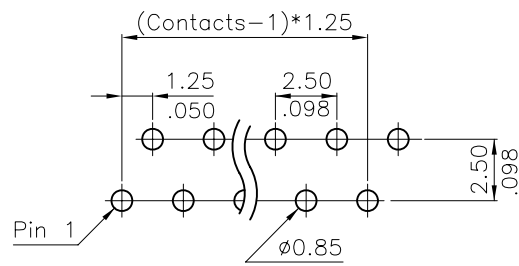

Recommended P.C.Board Layout  
(Standard Type)

				LECO CORPORATION		APPROVED:		PART NO.:				
				GENERAL TOLERANCE		DATE:		1257S**HT*0				
				X. ±		X° ± 2°		CHECKED:		TITLE:		
				.X ± $\frac{0.30}{.012}$		.X° ± 1°		DATE:		1.25mm FPC/FFC		
B ES060518				.XX ± $\frac{0.20}{.008}$		.XX° ± 0.5°		DRAWN:		DRAWING NO.:		
A DWG REL				.XXX ± $\frac{0.10}{.004}$		.XXX° ± 0.1°		DATE:		125702S		
REV.	ECO. NO.	CHG.	APP.					UNITS	SCALE	SIZE	SHEET	REV.
								$\frac{\text{mm}}{\text{inch}}$		A4	2/2	B