

Tous droits strictement réservés. Reproduction ou communication à des tiers interdite sous quelque forme que ce soit sans autorisation écrite du propriétaire. Propriété de c FCI. Droits de reproduction FCI.

**FCI**

All rights strictly reserved. Reproduction or issue to third parties in any form whatever is not permitted without written authority from the proprietor. Property of FCI. Copyright FCI.

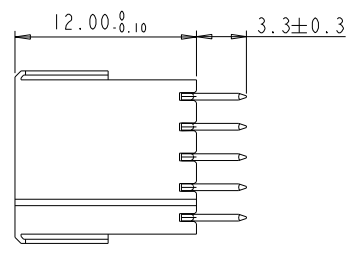
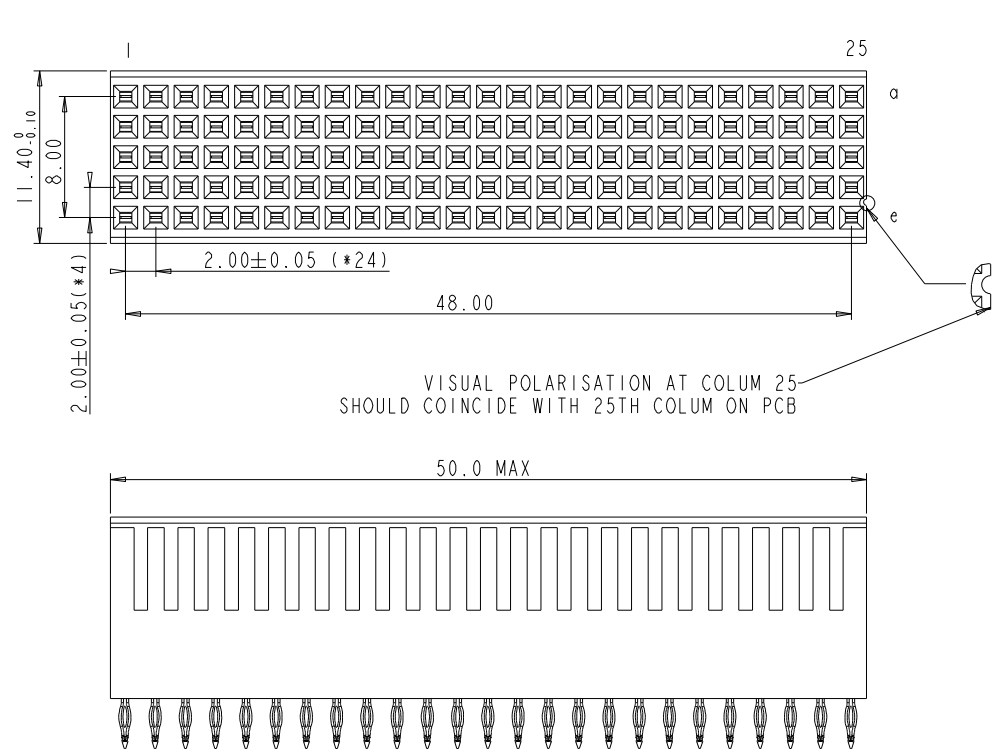

**PERFORMANCE CHARACTERISTICS**

- CURRENT RATING 1.5A AT 20°C (FULLY LOADED)  
1 A AT 70°C (FULLY LOADED)
- RATED VOLTAGE : 500 V AC (CONT /CONT)
- OPERATING TEMPERATURE : -55°C TO 125°C
- CONTACT RESISTANCE 20 MΩ MAX
- INSERTION FORCE : 0.75N MAX/CONT
- EXTRACTION FORCE : 0.15N MIN/CONT
- INSULATION RESISTANCE : 10<sup>4</sup> MΩ MIN

**NOTES**

- "C" PERFORMANCE LEVEL INDICATOR (REF DWG NO.BS,C ,201844,003)
- THIS PRODUCT IS CSA APPROVED. THIS PRODUCT IS UL RECOGNIZED.
- FOR RECOMMENDED PTH DIMENSIONS REFER DRAWING BSA .201572.001
- THE PRODUCT (C) MEETS EUROPEAN UNION DIRECTIVES AND OTHER COUNTRY REGULATIONS AS DESCRIBED IN GS-22-008 EXCEPT FOR LEAD.

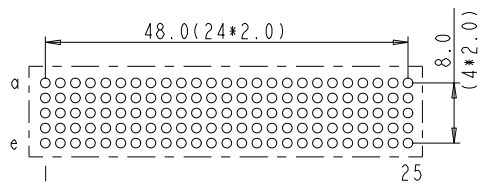

LAY-OUT P.C.B. - HOLE (FRONT SIDE)

rev	ecn no	dr	date
A	DG05-0262	Kason	05-08-05
-	-	-	-
-	-	-	-
-	-	-	-
-	-	-	-

Material		Spec ref		
Mat code		✓	tolerance	projection
Heatreat			1DEC±0.2 IDEC	⊕
Plating/Finish			ANGLESET* HOEKEN	MM
Dr	Kason luo	05-08-05	size	A4
Eng	Colins lu	05-08-05	Scale	2.000
Chr	Victor Lin	05-08-05	Product family	MILLIPICS
Appr	Joseph Hsia	05-08-05	Model Name	HM2S02PE5100
			Model Revision	REL Level
title		BSC201419019		Rev. A
Pro/E file	catalog	HM2S02PE5100--C	CUSTOMER DRAWING	sheet 1 of 1