

FEATURES

- ✓ SMD Construction
- ✓ Standard 5X3.2mm Package Size
- ✓ Mil-Std-202 Compliant
- ✓ CMOS/HCMOS Output

Crystal Oscillator

#blileytakesyoufurther

Part Number Configuration

BOCS5 – **XXXXM** – **CT**

Center Frequency	Voltage	Output Control	Frequency Stability	Operating Temperature
32.768kHz 1MHz to 150MHz	B: 1.8Vdc D: 3.3Vdc E: 5.0Vdc	T: Tristate N: N.C.	A: ±25ppm B: ±50ppm	B: -20°C to +70°C C: -40°C to +85°C

Physical Specifications

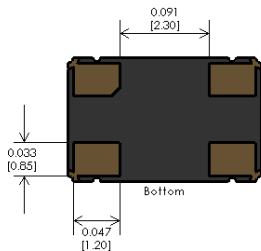
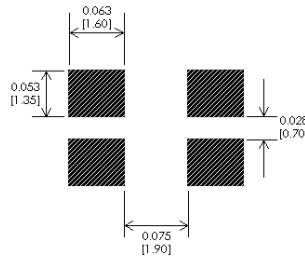
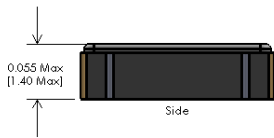
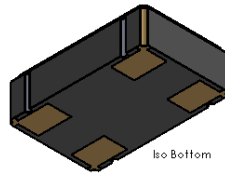
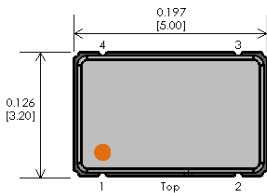

PIN	FUNCTION
1	Tristate/N.C.
2	Ground
3	Output
4	Vdc

Tolerances (mm) .X = ± 0.5, .XX = ±0.2 unless otherwise specified



Notes

- 1) Connection Pads: Gold(10-40 μ in.) over Nickel (100-250 μ in.)
- 2) Weight = 1.5gms typical

Performance Specifications

Parameter	Conditions	Supply Voltage ($\pm 10\%$)			Unit
		Voltage (Vdd)	1.8	3.3	
Frequency Range		32.768kHz and 1-150MHz			
Output Type & Load	CMOS/HCMOS	15pf/10TTL			
Frequency Stability		± 25 or ± 50			ppm
Current Consumption @10 MHz	Typical	10	15	20	mA
Current Consumption @100 MHz	Typical	25	45	60	mA
Output Levels	Typical	10% Vdd Logic 0 90% Vdd Logic 1			Vdc
Rise Time (10% to 90% Vdd) Fall Time (90% to 10% Vdd)	Typical	6	8	10	ns
Duty Cycle		40/60			%
Tristate	Enabled-High Disabled-Low				
Startup Time		10			ms
Operating Temperature Range		-20 to +70 / -40 to +85			$^{\circ}\text{C}$
Storage Temperature Range		-55 to +125			$^{\circ}\text{C}$

DISCLAIMER: Bliley Technologies, Inc. reserves the right to make changes to the product(s) and/or information contained herein without notice. No liability is assumed as a result of their use or application. No intellectual property rights accompany the sale or delivery of any such product(s) or information.

Tape and Reel

Embossed Carrier Dimensions (8mm, 12mm, 16mm, 24mm Tape Only)

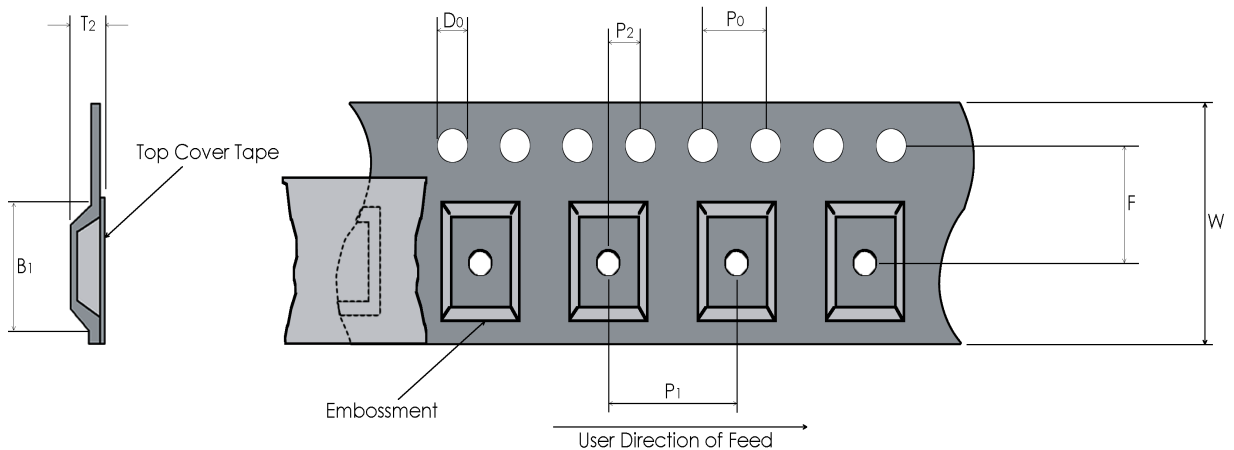

Tape Dimensions (mm)				Reel Dimensions (mm)					
W	F	Do	Po	P1	P2	B1	T2	Outside Dia.	Parts / Reel
12	5.5	1.5	4.0	8	2.0	5.5	1.7	180	1,000

Recommended Reflow Profile

Reflow Profile: in accordance to IPC/JEDEC J-STD-020 (Latest Revision)

Additional Notes:

- This part has been designed for pick and place reflow soldering
- This part may be reflowed once
- This part should not be reflowed in the inverted position

Packaging

Packaging: All packaging must conform to ESD Controls detailed in ANSI/ESD S20.20 (Latest Revision)