

Headers and Sockets

STANDARD

- 0.635 mm (.025") square pin header
- 2.54 mm (.100") pitch and multiple
- Number of ways on request

TECHNICAL DATA

PLATING

- Ni 2 μ + Sn 5 μ or gold plated

INSULATOR

- Glass filled plastic UL 94V-0

MECHANICAL ENDURANCE

- Au = 500
- Sn = 50

INSERTION FORCE

- 1.5 max.
- 3N max.

ELECTRICAL SPECIFICATIONS

- Contact resistance: 20 m Ω
- AC current rating per contact: 3 A
- Min. withstanding voltage: 500V eff.
- Min. insulation resistance: 1000M Ω

THERMAL SPECIFICATIONS

- Operating temperature: -40°C to +150°C

STRAIGHT SINGLE AND DOUBLE ROW

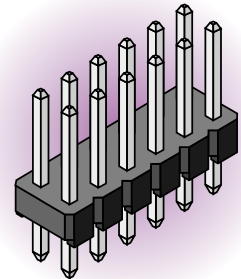
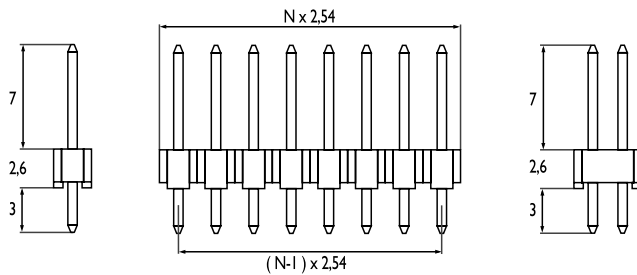
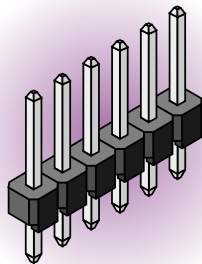

Dimensions in mm

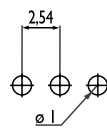

REF.	PLATING	NUMBER OF CONTACTS XX
12-17-111-XX-1	Tin plated	02 ≤ XX ≤ 40
12-17-141-XX-1	Gold plated	02 ≤ XX ≤ 40
16-17-111-XX-1	Tin plated	04 ≤ XX ≤ 80
16-17-141-XX-1	Gold plated	04 ≤ XX ≤ 80

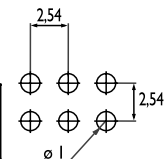

RIGHT ANGLE SINGLE AND DOUBLE ROW

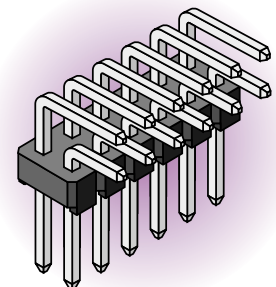
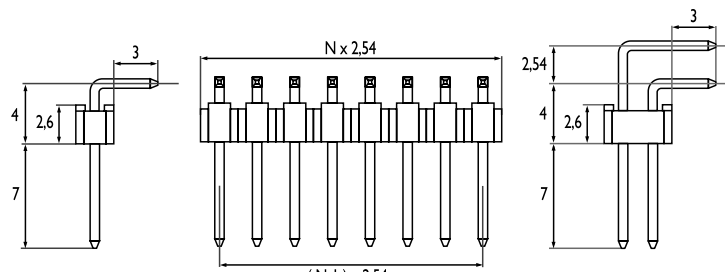
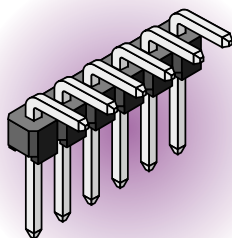

Dimensions in mm

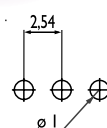

REF.	PLATING	NUMBER OF CONTACTS XX
12-19-211-XX-1	Tin plated	02 ≤ XX ≤ 40
12-19-241-XX-1	Gold plated	02 ≤ XX ≤ 40
16-52-211-XX-1	Tin plated	04 ≤ XX ≤ 80
16-52-241-XX-1	Gold plated	04 ≤ XX ≤ 80

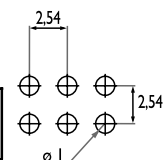

Headers and Sockets

WALLED HEADERS

STRAIGHT SINGLE AND DOUBLE ROW

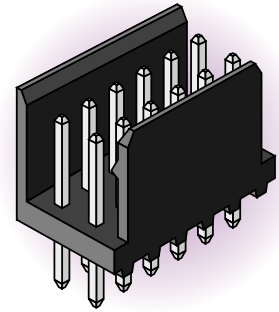
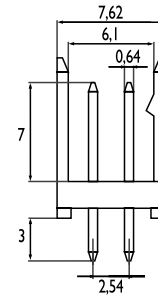
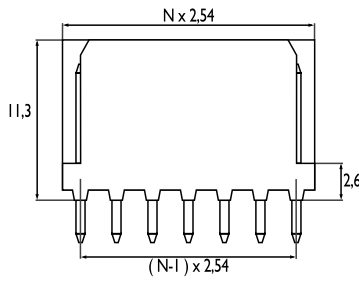
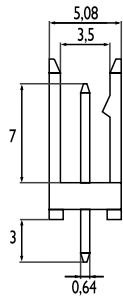
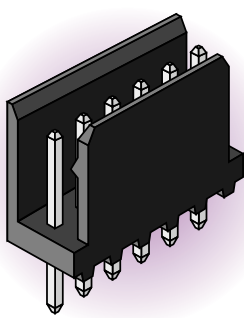

Dimensions in mm

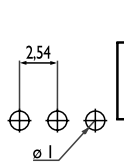

REF.	PLATING	NUMBER OF CONTACTS XX
1Y-10-111-XX-1	Tin plated	02 ≤ XX ≤ 20
1Y-10-141-XX-1	Gold plated	02 ≤ XX ≤ 20
1Y-20-111-XX-1	Tin plated	04 ≤ XX ≤ 40
1Y-20-141-XX-1	Gold plated	04 ≤ XX ≤ 40

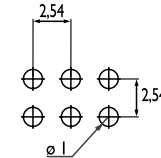

RIGHT ANGLE SINGLE AND DOUBLE ROW

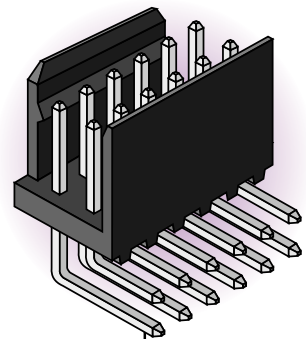
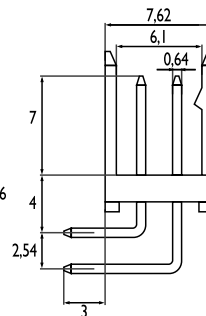
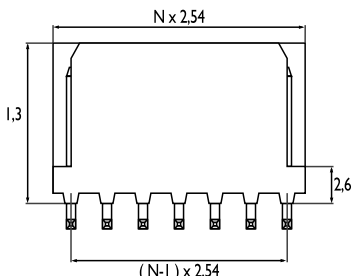
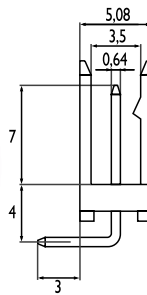
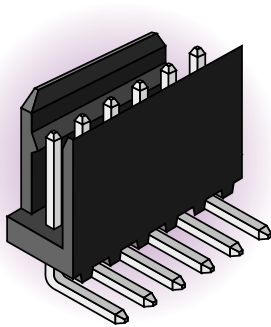

Dimensions in mm

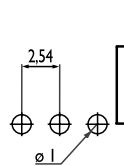

REF.	PLATING	NUMBER OF CONTACTS XX
1Y-10-211-XX-1	Tin plated	02 ≤ XX ≤ 20
1Y-10-241-XX-1	Gold plated	02 ≤ XX ≤ 20
1Y-20-211-XX-1	Tin plated	04 ≤ XX ≤ 40
1Y-20-241-XX-1	Gold plated	04 ≤ XX ≤ 40

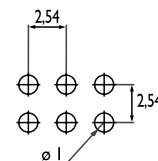

Headers and Sockets

■ Strong tails : the contact is firmly retained in the PCB holes thus allowing the solder to ascend.

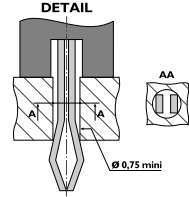

STANDARD AND LOW PROFILE SINGLE AND DOUBLE ROW

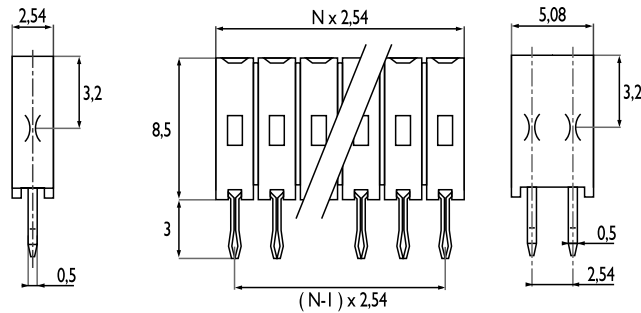
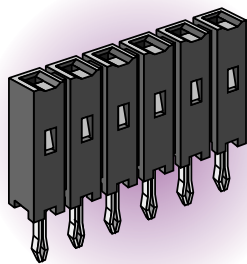

Dimensions in mm

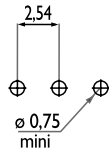
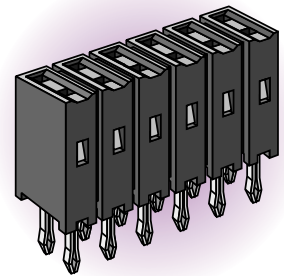

REF.	PLATING	NUMBER OF CONTACTS XX
8Y-10-111-XX-1	Tin plated	02 ≤ XX ≤ 40
8Y-10-131-XX-1	Selective gold plated	02 ≤ XX ≤ 40
8Y-20-111-XX-1	Tin plated	04 ≤ XX ≤ 80
8Y-20-131-XX-1	Selective gold plated	04 ≤ XX ≤ 80

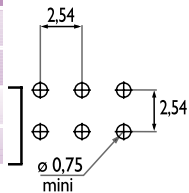

DOUBLE ROW DUAL ENTRY

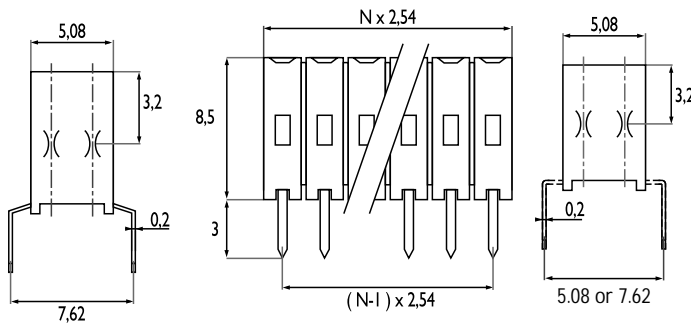
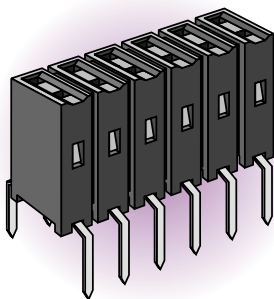

Dimensions in mm

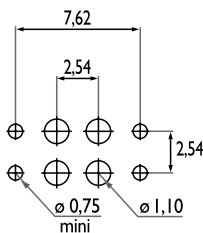
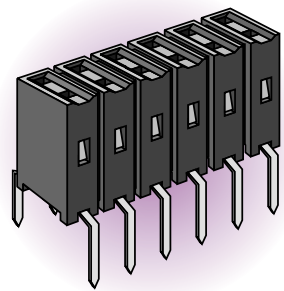

REF.	PLATING	NUMBER OF CONTACTS XX	PITCH
3Y-20-311-XX-1	Tin plated	04 ≤ XX ≤ 80	7.62
3Y-20-331-XX-1	Selective gold plated	04 ≤ XX ≤ 80	7.62

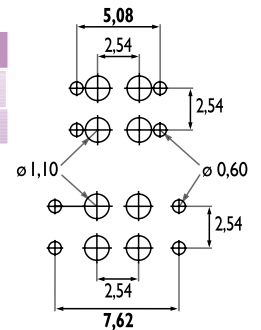

Male Headers

STRAIGHT HEADER 1L-10-1Z1-XX-1

■ It allows the locking of OL xx, OM xx and OP xx housings (refer to page 25 and 26).

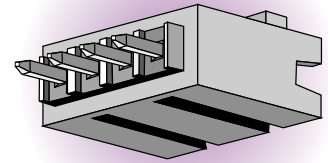
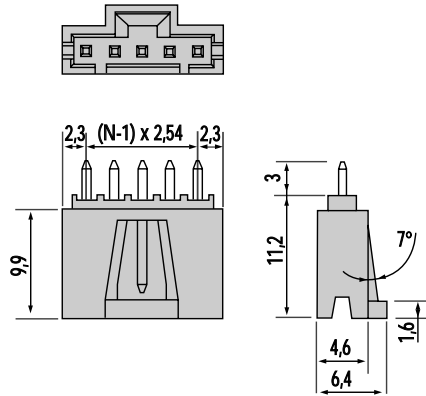

Dimensions in mm

REF.	PLATING	NUMBER OF CONTACTS XX
1L-10-111-XX-1	tin plated	$02 \leq XX \leq 25$
1L-10-141-XX-1	gold plated	$02 \leq XX \leq 25$

RIGHT ANGLE HEADER 1L-10-2Z1-XX-1

■ It allows the locking of OL xx, OM xx and OP xx housings (refer to page 25 and 26).

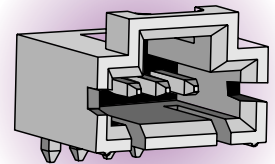
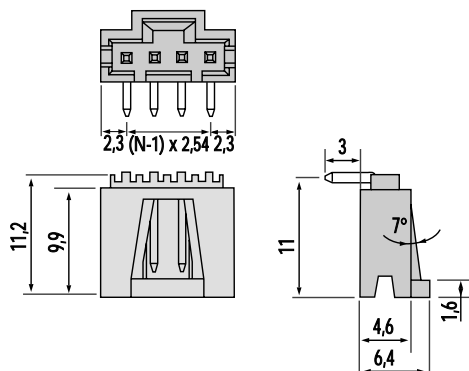

Dimensions in mm

REF.	PLATING	NUMBER OF CONTACTS XX
1L-10-211-XX-1	tin plated	$02 \leq XX \leq 25$
1L-10-241-XX-1	gold plated	$02 \leq XX \leq 25$