

PLATING CONTACT AREA:	
DASH NR:	PERFORMANCE LEVEL
-1YY/1YYLF	TELCORDIA CO
-2YY/2YYLF	CUSTOMER SPECIAL
-3YY/3YYLF	CUSTOMER SPECIAL

PC BOARD VERSIONS		
PRODUCTNR:	PCB THICKNESS	DIM"A"
89049-X0Z/X0ZLF	1.6	2.90
89049-X1Z/X1ZLF	2.4	3.53

LOADING CONFIGURATION	POSITION ROW	POSITION					
		1	2	3	4	5	6
89049-XY1 89049-XY1LF	d	+	0	+	+	0	0
	c	+	0	0	0	0	0
	b	0	0	0	0	+	0
	a	+	+	0	0	+	0
89049-XY2 89049-XY1LF	d	0	0	0	0	0	0
	c	+	+	+	+	+	+
	b	+	+	+	+	+	+
	a	+	+	+	+	+	+

+ = LOADED POSITION
0 = EMPTY POSITION

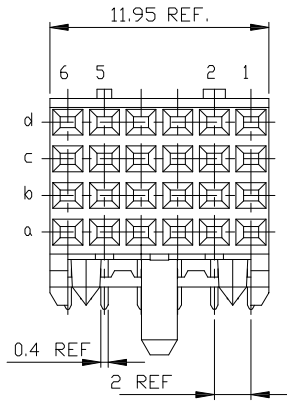
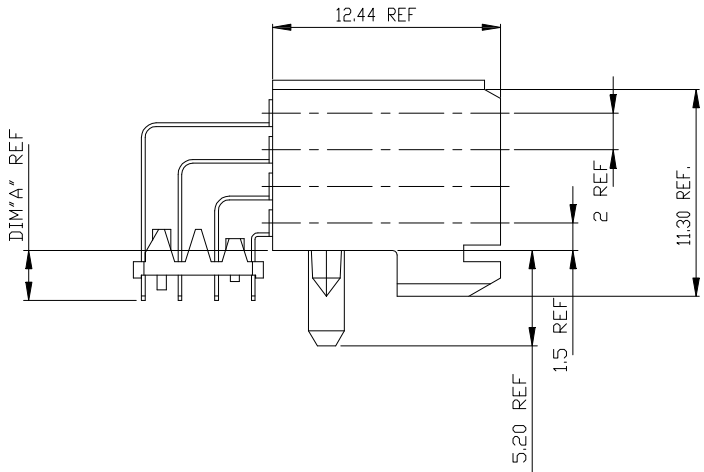

ASSEMBLY AFTER HOT RIVETTING.

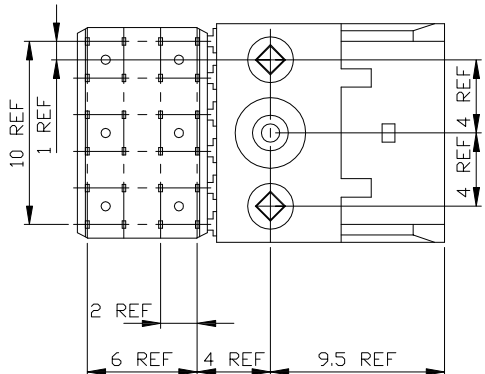

PC BOARD THICKNESS±0.20
(SEE TABLE)

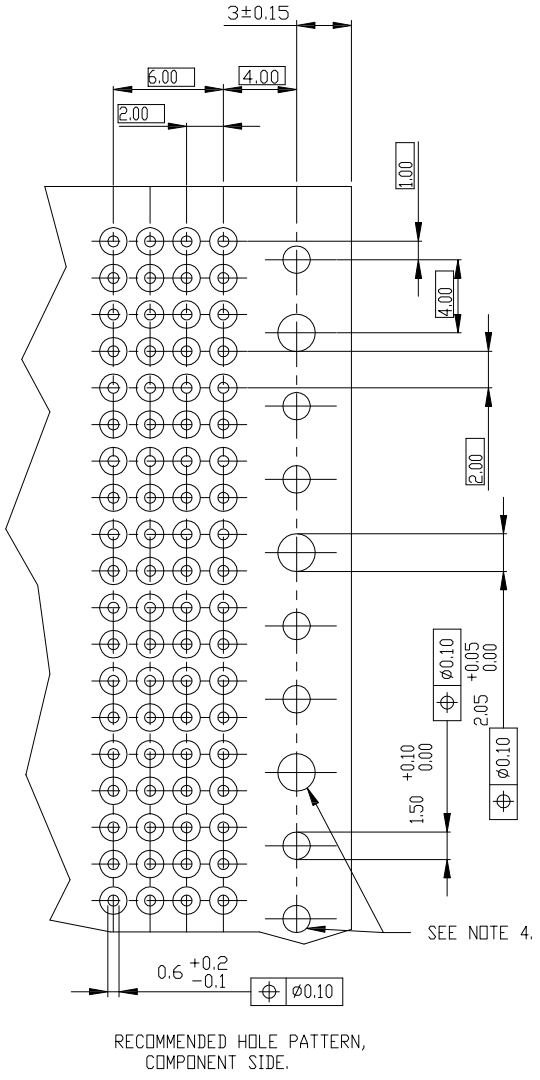
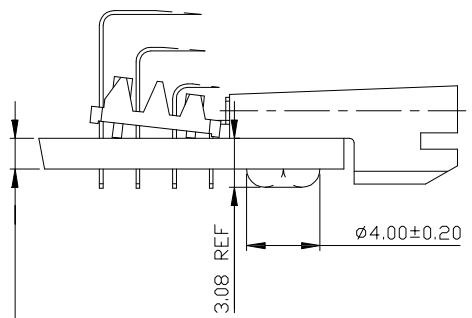

SEE NOTE 4.

RECOMMENDED HOLE PATTERN,
COMPONENT SIDE.

NOTES:

- 1 BODY MAT'L: LIQUID CRYSTAL POLYMER 30% GLASS FLAME RETARDANT ACC. UL 94-V0
- 2 TERMINAL MATERIAL: PHOSPHOR BRONZE.
- 3 PLATING SOLDER TAILS 2-8 um SnPb 90-97.
- 4 INDICATED HOLES ARE UNPLATED.
- 5 PRODUCT MARKING : PARTNUMBER & BATCH ID.

mat'l code		tolerances unless otherwise specified		CUSTOMER CDPY		 www.fciconnection.com	
ltr	ecnr n°dr date	linear		projection	title	product family	code
H	DG09-0068 Cent 06/06/09			⊕	RA FEMALE SIGNAL STB 12MM SPECIAL	METRAL (tm)	213
c	H40118 EFE 940211	angles				size	dwg no
D	H40625 DDB 941006	dir	H.Bouwknegt 931207	mm		89049	sheet 1 of 3
E	DG05-0465 CLU 051115	engr	H.Bouwknegt 931207	scale	A2		
F	DG06-0448 Cent 11/02/06	chr	S.Lee 931207	5:1			
G	DG07-0171 Cent 05/25/07	app	H.Bouwknegt 931208				
sheet	revision	H	H				
index	sheet	1	2				

PC BOARD VERSIONS			
PRODUCTNR.	PCB THICKNESS	DIM"A"	
89049-X0Z/X0ZLF	1.6	2.90	
89049-X1Z/X1ZLF	2.4	3.53	

14.64 REF. SEE NOTE 6

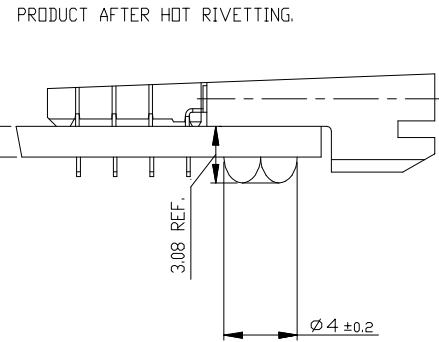
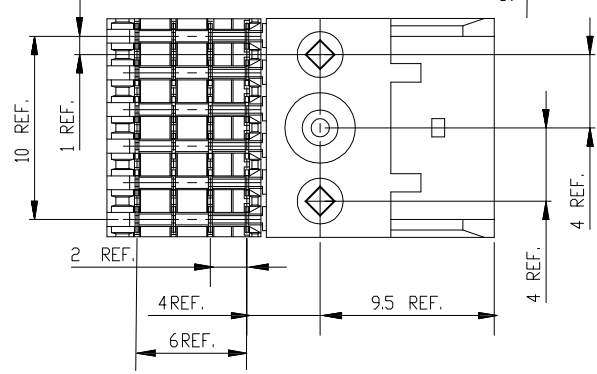
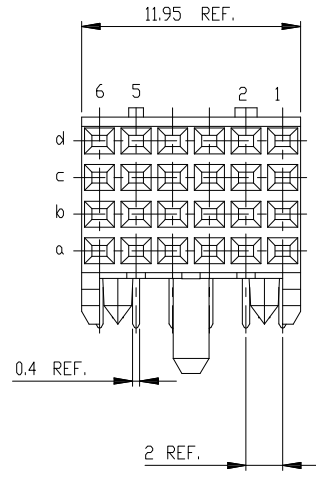
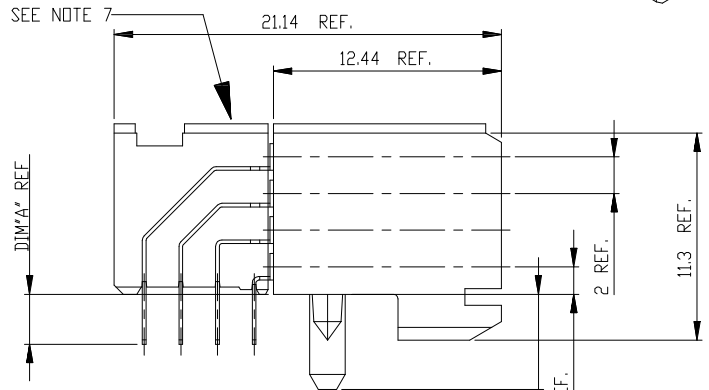
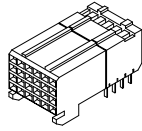

PC BOARD THICKNESS ±0.20

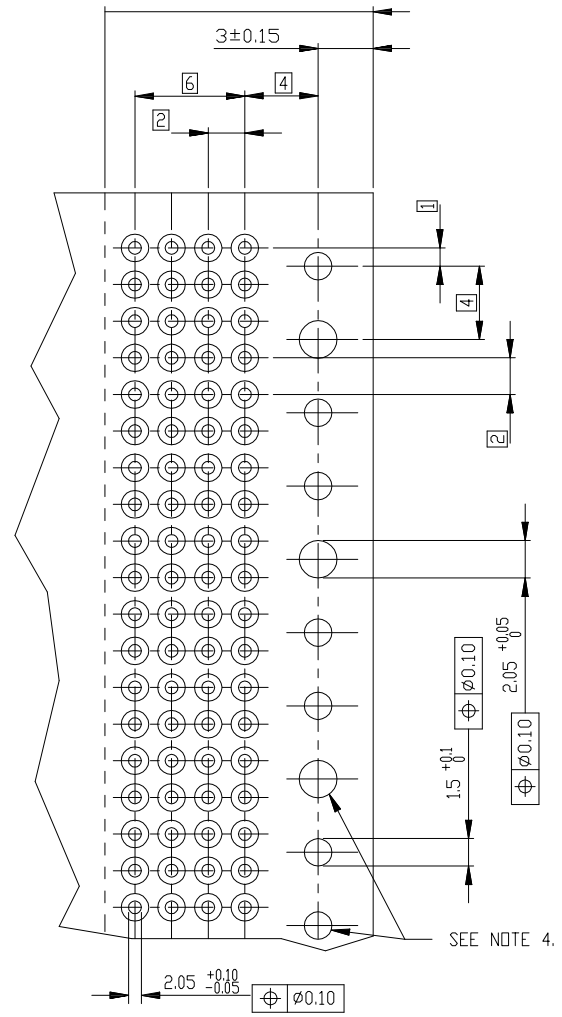

RECOMMENDED HOLE PATTERN, COMPONENT SIDE.

LOADING CONFIGURATION	POSITION ROW	1	2	3	4	5	6
		89049-XY3	d	+	0	+	+
89049-XY3LF	c	+	0	0	0	0	0
	b	0	0	0	0	+	0
	a	+	+	0	0	+	0
89049-XY4	d	0	0	0	0	0	0
	c	+	+	+	+	+	+
89049-XY4LF	b	+	+	+	+	+	+
	a	+	+	+	+	+	+

+ = LOADED POSITION
0 = EMPTY POSITION

PLATING CONTACT AREA:	
DASH NR:	PERFORMANCE LEVEL
-1YY/1YYLF	TELCORDIA CO
-2YY/2YYLF	CUSTOMER SPECIAL
-3YY/3YYLF	CUSTOMER SPECIAL

- NOTES:
- BODY MAT'L: LIQUID CRYSTAL POLYMER 30% GLASS
FLAME RETARDANT ACC. UL 94-V0
 - TERMINAL MATERIAL: PHOSPHOR BRONZE.
 - PLATING SOLDER TAILS 2-8 um SnPb 90-97 OR 2-8 um PURE Sn
 - INDICATED HOLES ARE UNPLATED.
 - PRODUCT MARKING: PARTNUMBER & BATCH ID.
 - SET BACK FOR PRESS BLOCK.
 - TOP SURFACE OF PRESS BLOCK MAY EXTEND UP TO 0.4MM HIGHER THAN HOUSING. THIS MAY AFFECT THE TAIL LENGTH BEFORE APPLICATION TO A BOARD
 - THIS PRODUCT MEETS EUROPEAN UNION DIRECTIVES AND OTHER COUNTRY REGULATIONS AS DESCRIBED IN GS-22-008.
 - THE HOUSING WILL WITHSTAND EXPOSURE TO 260DEGREE PEAK TEMPERATURE FOR 10 SECONDS IN A WAVE SOLDER APPLICATION.

mat'l. code		tolerances unless otherwise specified		CUSTOMER COPY		FCI	
ltr	ecn no	dr	date	linear	projection	title	www.fciconnection.com
H				angles	mm	RA FEMALE SIGNAL STB 12 mm SPECIAL	
		dr	Heaven Cen	11/02/06		product family METRAL(tn)	code
		engr	Collins Lu	11/02/06	scale	size dwg no	213
		chr	Beer Fu	11/02/06	5:1	89049	sheet
		appd	Joseph Hsia	11/02/06			2 of -
sheet	revision						
index	sheet						

All rights strictly reserved. Reproduction or issue in third parties in any form without written authority from the proprietor. Property of FCI BV. © FCI BV.

PLATING CONTACT AREA:	
DASH NR:	PERFORMANCE LEVEL
-1YY/1YYLF	TELCORDIA CO
-2YY/2YYLF	CUSTOMER SPECIAL
-3YY/3YYLF	CUSTOMER SPECIAL

PC BOARD VERSIONS		
PRODUCTNR:	PCB THICKNESS	DIM "A"
89049-X0Z/X0ZLF	1.6	2.90
89049-X1Z/X1ZLF	2.4	3.53

LOADING CONFIGURATION	POSITION ROW	POSITION					
		1	2	3	4	5	6
89049-XY5 89049-XY5LF	d	+	0	+	+	0	0
	c	+	0	0	0	0	0
	b	0	0	0	0	+	0
89049-XY6 89049-XY6LF	a	+	+	0	0	+	0
	d	0	0	0	0	0	0
	c	+	+	+	+	+	+
	b	+	+	+	+	+	+
	a	+	+	+	+	+	+

+ = LOADED POSITION
0 = EMPTY POSITION

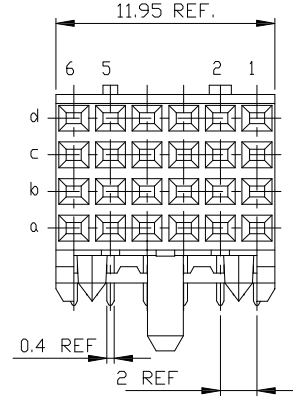
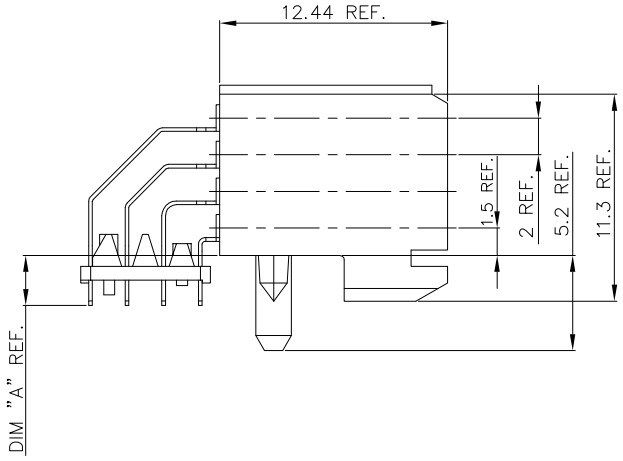

ASSEMBLY AFTER HOT RIVETTING.

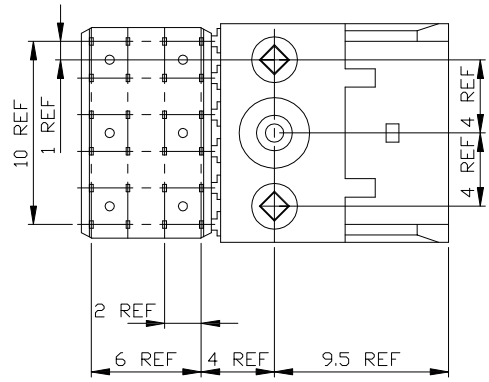

PC BOARD THICKNESS±0.20
(SEE TABLE)

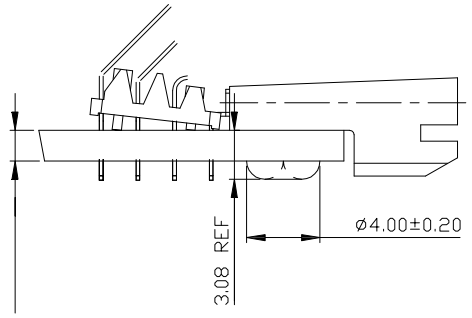

- NOTES:
- BODY MAT'L: LIQUID CRYSTAL POLYMER 30% GLASS
FLAME RETARDANT ACC. UL 94-V0
 - TERMINAL MATERIAL: PHOSPHOR BRONZE.
 - PLATING SOLDER TAILS 2-8 um SnPb 90-97 OR 2-8 um PURE Sn FOR LEAD FREE.
 - INDICATED HOLES ARE UNPLATED.
 - PRODUCT MARKING: PART NUMBER & BATCH ID.
 - THIS PRODUCT MEETS EUROPEAN UNION DIRECTIVES AND OTHER
 - THE HOUSING WILL WITHSTAND EXPOSURE TO 260 DEGREE PEAK

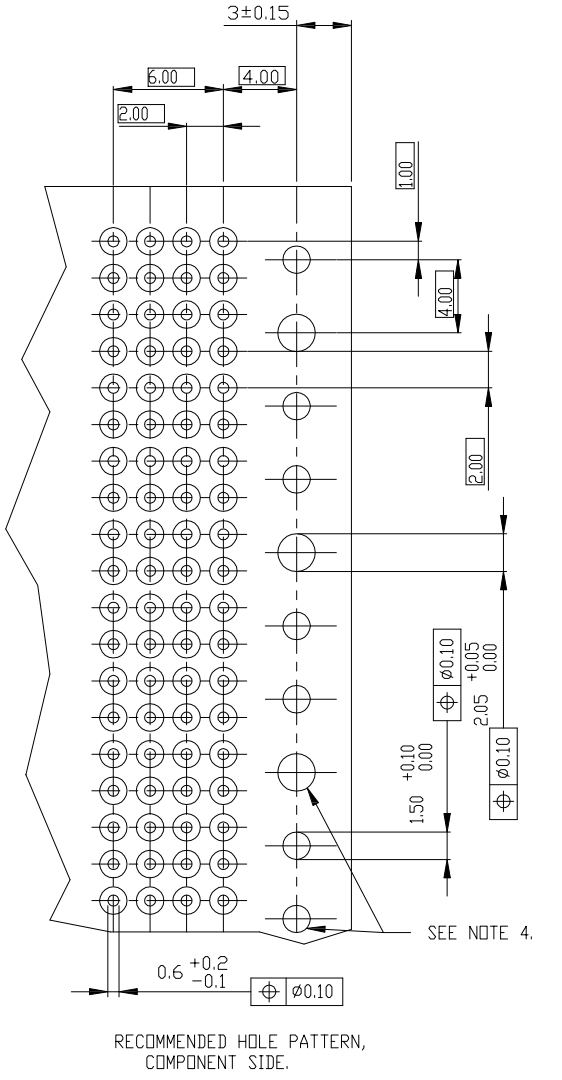

RECOMMENDED HOLE PATTERN, COMPONENT SIDE.

nat'l. code	tolerances unless otherwise specified	CUSTOMER CDPY		
ltr/ecn no/dt date	linear	projection	title	
	angles		RA FEMALE SIGNAL	
dr Heaven Cen 11/02/06		mm	product family METRAL (tm) code	
engr Collins Lu 11/02/06		scale	sizedwg no 213	
chr Beer Fu 11/02/06		5:1	sheet	
app Joseph Hsia 11/02/06			3 of-	
sheet index	revision sheet			

All rights strictly reserved. Reproduction or use in any form without written authority from the proprietor. Property of F.C.I. Inc. © F.C.I. Inc.