

H=8.50: Pin = 0.60mm x 0.40mm
H=5.65: Pin = 0.74mm x 0.40mm

H=8.50: Minimum Insertion Depth = 2.00 ref.
H=5.65: Minimum Insertion Depth = 1.75 ref.

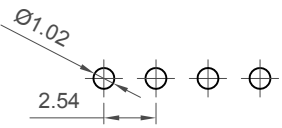

Recommended PCB Layout

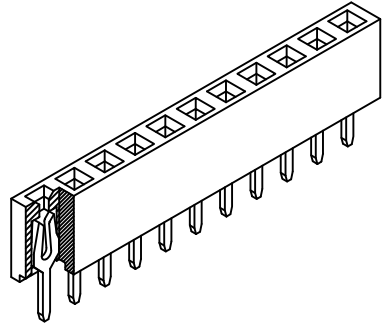
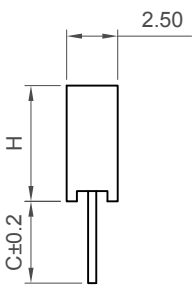

Number of Contacts	Dimensions	
	A	B
2	2.54	5.58
3	5.08	8.12
4	7.62	10.66
5	10.16	13.20
6	12.70	15.74
7	15.24	18.28
8	17.78	20.82
9	20.32	23.36
10	22.86	25.90
11	25.40	28.44
12	27.94	30.98
13	30.48	33.52
14	33.02	36.06
15	35.56	38.60
16	38.10	41.14
17	40.64	43.68
18	43.18	46.22
19	45.72	48.76
20	48.26	51.30
21	50.80	53.84
22	53.34	56.38
23	55.88	58.92
24	58.42	61.46
25	60.96	64.00
26	63.50	66.54
27	66.04	69.08
28	68.58	71.62
29	71.12	74.16
30	73.66	76.70
31	76.20	79.24
32	78.74	81.78
33	81.28	84.32
34	83.82	86.86
35	86.36	89.40
36	88.90	91.94
37	91.44	94.48
38	93.98	97.02
39	96.52	99.56
40	99.06	102.10

Specifications 规格

Material 物料
Contact 端子: Copper Alloy
Insulator Material 绝缘体:
Standard 标准: Polyamide, Nylon 6T, UL 94V-0
Options 可选: Polyester, LCP, UL 94V-0

Electrical 电气
Current Rating 电流额定值: 3 Amp
Insulator Resistance 绝缘电阻值: 1000 MΩ min.
Contact Resistance 接触电阻值: 20 mΩ max.
Dielectric Withstanding 耐电压: AC 600 V

Environmental & Mechanical 机械 & 环境
Operating Temperature 工作温度: -40° to +105°C
Soldering Process 可焊性:

Nylon 6T (Standard 标准物料) -
IR Reflow 回流焊: 260°C for 10 sec.
Wave 波峰焊: 230°C for 5-10 sec.
Manual Solder 人工焊接: 350°C for 3-5 sec
LCP (Option 可选物料) -
IR Reflow 回流焊: 260°C for 10 sec.
Wave 波峰焊: 250°C for 5-10 sec.
Manual Solder 人工焊接: 350°C for 3-5 sec

Ordering Grid

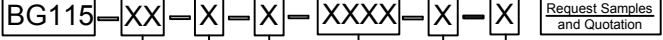

No. of Contacts
02 to 40

Contact Plating
A = Gold Flash All Over (Standard)
B = Selective Gold Flash Contact Area/Tin On Tail
C = Tin All Over
G = 10µ" Gold Contact Area/Tin On Tail
I = 30µ" Gold Contact Area/Tin On Tail

Insulator Height "H"
2 = 5.65mm (Standard)
1 = 8.50mm

Packing Options
H = Tray (Standard)
D = Tube
G = Plastic Box (2 position only)

Insulator Material
N = Nylon 6T (Standard)
L = LCP

Dimension C (1/100mm) (Tail Length)
0320 = 3.20mm (Standard where H = 8.50mm)
0300 = 3.00mm (Standard where H = 5.65mm)
Or specify custom Tail Length
eg 0250 = 2.50mm

Mates with 配套之母座 (Subject to pin length 在端子长度适合的条件下)

BG025	BG040	BG045	BG050
BG065	BG070	BG085	

Part Number		Product Description	
BG115		2.54mm Pitch Socket	
Drawing Date		Single Row, Through-Hole, Vertical	
30th October 2006			
By	AJO	Tolerances (Except as Noted)	Units:
Detail	BG115 G PCN	X, ± 0.30 X° ± 5°	Metric (mm)
Revision	G	X.XX ± 0.20 X.XX° ± 2°	
Date	22/07/15	X.XXX ± 0.15 X.XXX° ± 1°	
		X.XXX ± 0.10 X.XXX° ± 0.5°	



This drawing is confidential and copyright of Global Connector Technology, Ltd (GCT). This drawing must not be copied or disclosed without written consent. E & OE



Global Connector Technology

www.gct.co

Not to Scale	Drawn By LYH	Sheet No. 1/1
--------------	--------------	---------------