

EDAL INDUSTRIES, INC.

51 COMMERCE STREET * EAST HAVEN, CONNECTICUT 06512 * TELEPHONE (203)-467-2591 * FAX (203)-469-5928
 Internet: <http://www.eemonline.com/edal> Email: edalind@aol.com

B1203- 35 AMP SILICON BRIDGE RECTIFIER

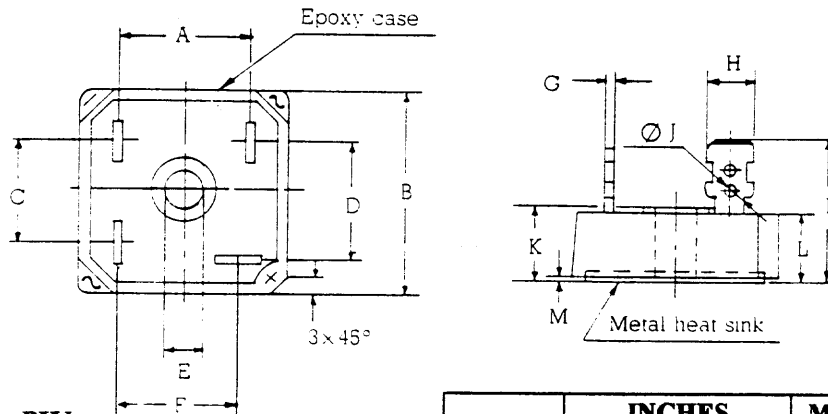

PART NUMBER	PIV (VOLTS)
B1203-5-1	50
B1203-10-1	100
B1203-20-1	200
B1203-30-1	300
B1203-40-1	400
B1203-50-1	500
B1203-60-1	600
B1203-70-1	700
B1203-80-1	800
B1203-100-1	1000
B1203-120-1	1200

DIM.	INCHES		MILLIMETERS	
	MIN.	MAX.	MIN.	MAX.
A	0.688	0.728	17.5	18.5
B	1.12	1.13	28.4	28.7
C	0.53	0.57	13.5	14.5
D	0.618	0.658	15.7	16.7
E	0.20	0.21	5.1	5.3
F	0.618	0.658	15.7	16.7
G	0.030	0.034	0.76	0.86
H	0.248	0.252	6.3	6.40
I	0.826	0.905	21.0	23.0
J	0.09	0.10	2.4	2.6
K	0.28	0.31	7.30	7.90
L	0.28	0.31	7.30	7.90
M	0.004	0.008	0.1	0.2

ELECTRICAL SPECIFICATIONS

MAXIMUM FORWARD CURRENT SINGLE PHASE FULL WAVE @ 50°C AMPS.....	35
MAXIMUM SURGE CURRENT SINGLE CYCLE AMPS @ RATED LOAD.....	400
MAXIMUM FORWARD DROP @ 25°C	
Io AMPS (FULL WAVE).....	17.5
V VOLTS (PER SECTION).....	1.1
MAXIMUM REVERSE CURRENT @ 25°C FCA.....	10 uA
THERMAL RESISTANCE, JUNCTION TO CASE @ RATED LOAD.....	1.85°C °C/W
MAXIMUM JUNCTION TEMPERATURE.....	175°C
RECOGNIZED UNDER UL FILE #E57830	

B129

**DIODES * BRIDGES * POWER RECTIFIERS * HIGH VOLTAGE ASSEMBLIES *
 VARISTORS * MOV'S * TVS * SPECIAL DESIGNS**

RATING AND CHARACTERISTIC CURVES

B526- 15 AMP
 B682- 25 AMP
 B1203- 35 AMP

FIG. 1 TYPICAL FORWARD CURRENT DERATING CURVE

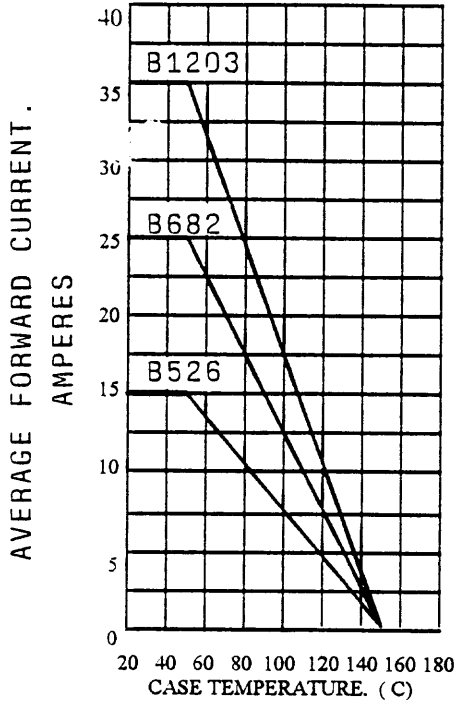

FIG. 2 MAXIMUM NON-REPETITIVE SURGE CURRENT

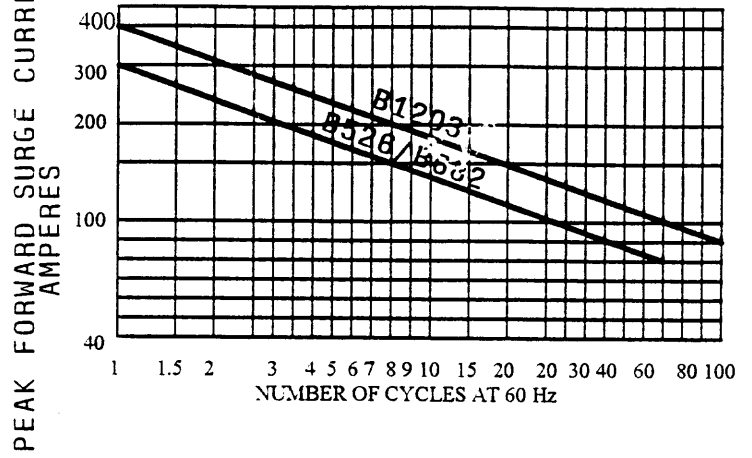

FIG. 4 TYPICAL FORWARD CHARACTERISTICS

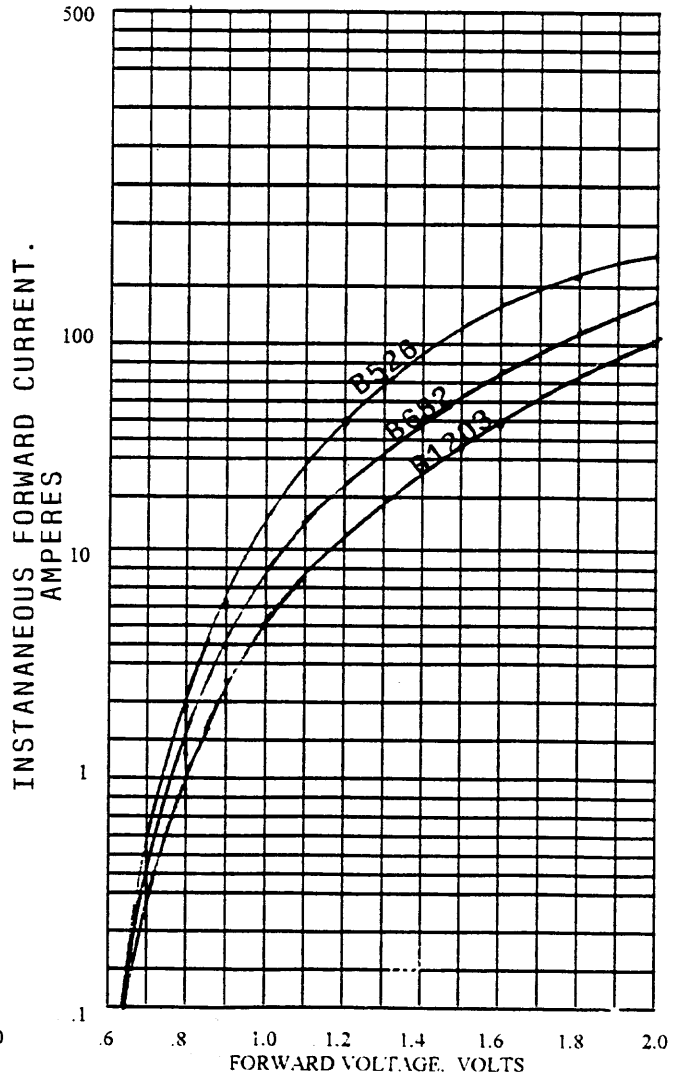

FIG. 3 TYPICAL REVERSE CHARACTERISTICS

