

acetate tape	NOTE
5.1mm	02~08PIN
10mm	09~40PIN

SPECIFICATIONS

Current Rating: 3Amp
 Contact Material: Phosphor Bronze
 Contact Resistance: 20mΩ Max.
 Insulation Material: Nylon 6T High Temp
 Insulation Resistance: 1000MΩ Min.
 Withstanding: 600V AC
 Durability: 2500 Cycles min.
 Processing Temp: 260°C, 10 sec
 Operating Temp: -40°C to +105°C

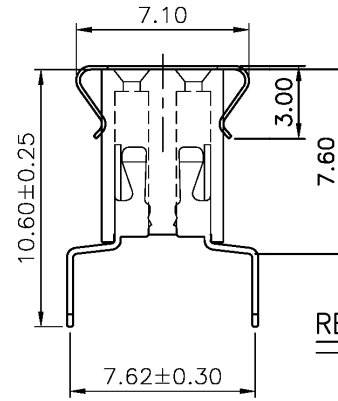
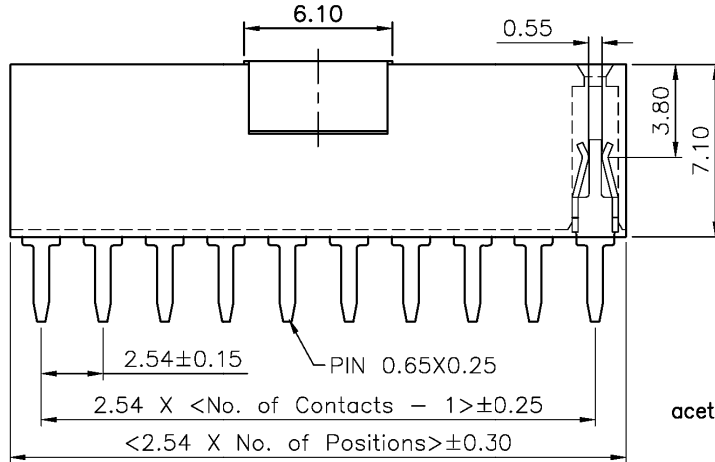

RECOMMENDED P.C.B LAYOUT
 (Tolerance: ±0.05)

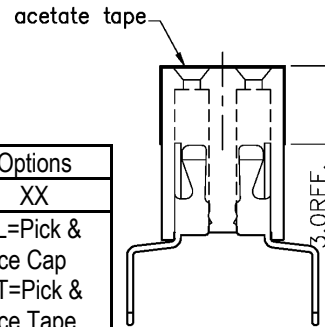
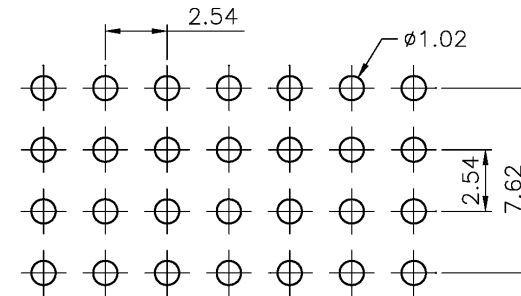

RoHS compliant

Series	Rows	Style/Profile	Positions	Plating	Options
ARS	02	BELPB	XX	XX	XX
.100 pitch receptacle strip	02=dual rows	BELPB=Bottom entry 7.1mm height (Others Available)	04-80	TN=Tin SG=Selective Gold GD=Gold	PPL=Pick & Place Cap PPT=Pick & Place Tape TR=Tape & Reel

Rev.	Description	Date	Approved	Drawing	Name	Date
				Approved	Howard	08/04/08
				Checked	Lizzy	08/04/08
				Drawn	Tina	08/04/08
				0.0 ± 0.35	0.00 ± 0.20	Angles ± 3'
				UNIT: mm		

Central Components Manufacturing
 440 Lincoln Blvd., Middlesex, New Jersey 08846
 Phone 732 469-5720 888 288-5152 Fax 732 469-1919

Part No.: **ARS-02-BELPB-XX-XX-XX**

Description: 2.54 Female Header Dual Rows SMT Type Connector