

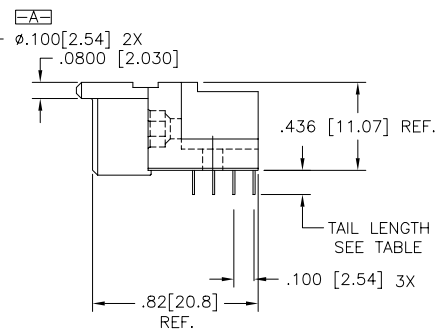

FCIconnect.com

Copyright FCI

PRODUCT NUMBER
SEE TABLE

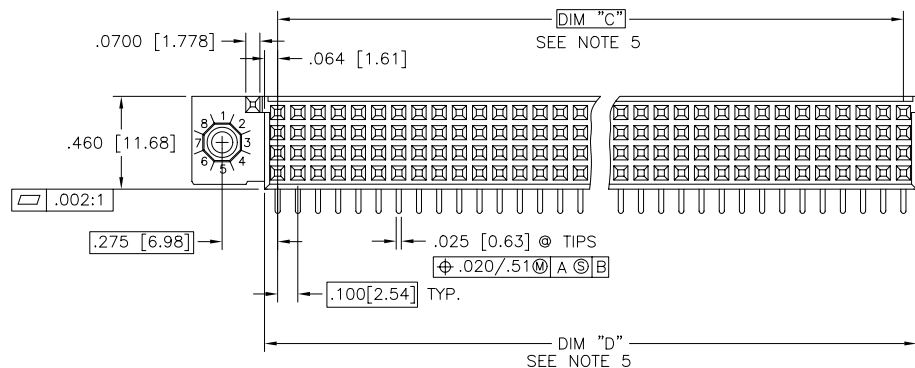
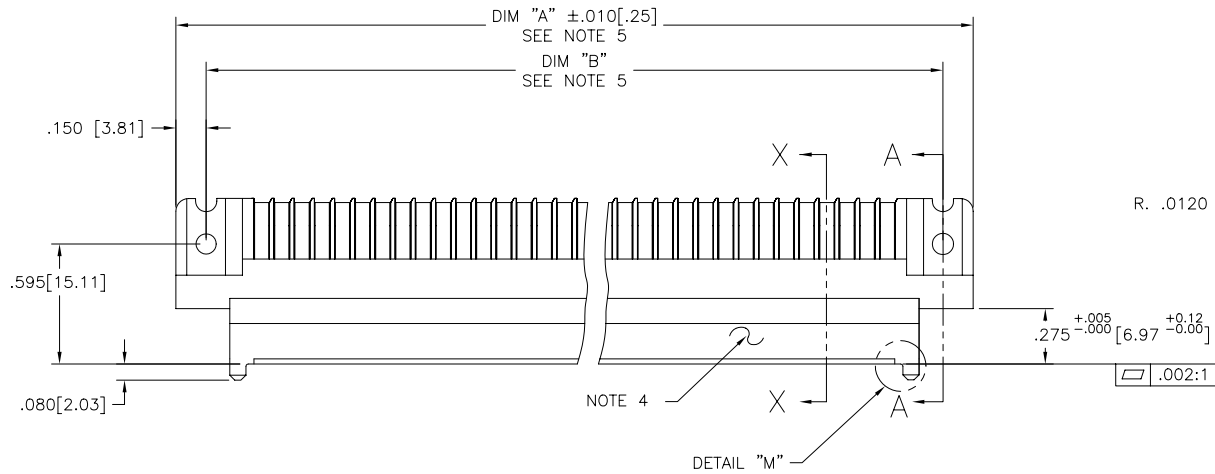

| | | | | | | | | | |
|---------------------------|----------------|---|----------|----------------------------------|-----------|---------------------------------------|-----------|-------------------------------|--|
| mat'l. code SEE NOTE 3 | | surface ISO 1302 <input checked="" type="checkbox"/> | | tolerance ISO 406 ISO 1101 | | projection | | product family HPC | |
| ltr | | ecn no | | date | | tolerances unless otherwise specified | | title | |
| C | v40839 | GIP | 5/04/94 | angles | linear | .xx $\pm 0.1/3$ | INCH/MM | 4 ROW R/A RECEPTACLE | |
| D | v60781 | GIP | 5/16/96 | | | .xxx $\pm 0.05/.13$ | | SOLDER TAIL W/NIBS, 0 G.P. | |
| E | v00293 | JWS | 2/07/00 | $\sigma \pm 2'$ | | .xxxx $\pm 0.020/.051$ | scale 1:1 | dwg no | |
| F | v05-0969 | DAI | 10/25/05 | dr | G. PETERS | 9/19/93 | | sheet 1 of 3 size | |
| G | M06-0261 | AEA | 5/10/06 | engr | S. CLARK | 9/19/93 | | 50736 A3 | |
| | | | | chr | S. CLARK | 12/13/93 | | type Product Customer Drawing | |
| | | | | appd | S. CLARK | 12/14/93 | | | |
| sheet index | revision sheet | G | G | G | G | G | | | |
| | | 1 | 2 | 3 | | | | | |

form: A3

PRODUCT NUMBER
SEE TABLE

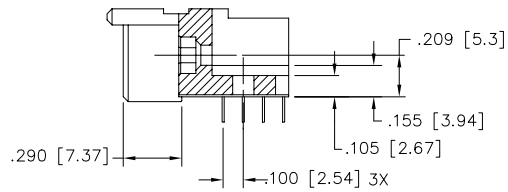

SECTION A-A

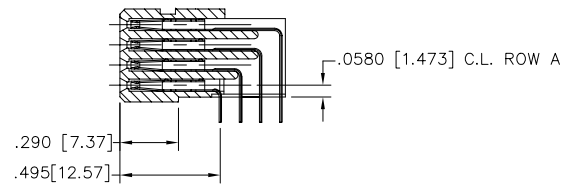

SECTION X-X

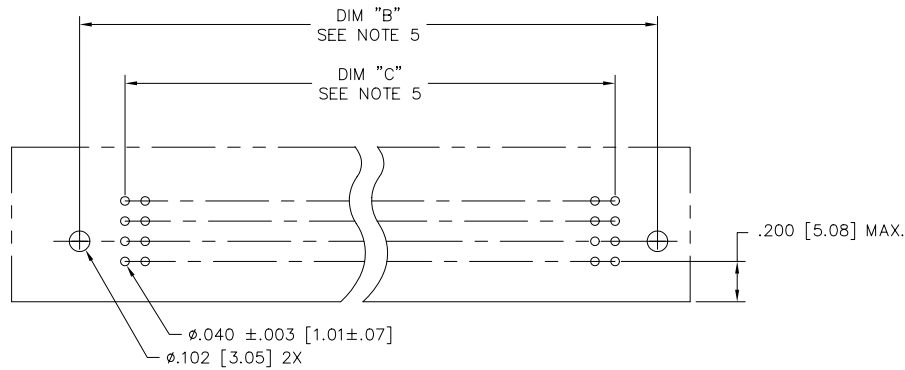

RECOMMENDED PCB LAYOUT
ALL HOLES LOCATED ON .100[2.54] GRID
UNLESS OTHERWISE SPECIFIED.

| | | | | | | | | | | |
|---------------------------|----------------|-----------------------|----|----------------------------------|---------------------------------------|-----------------|--|-----------------------|--|--------------------------|
| mat'l. code SEE NOTE 3 | | surface ISO 1302 ✓ | | tolerance ISO 406 ISO 1101 | | projection ⊕ | | product family HPC | | |
| ltr | ecn | no | dr | date | tolerances unless otherwise specified | | title | | | |
| G | | | | | angles | linear | .xx ±.01/.3 .xxx ±.005/.13 .xxxx ±.0020/.051 | INCH/MM | 4 ROW R/A RECEPTACLE SOLDER TAIL W/NIBS, 0 G.P. | |
| | | | | | dr | G. PETERS | 9/19/93 | scale 1:1 | dwg no | |
| | | | | | enr | S. CLARK | 9/19/93 | FCJ | sheet 2 of 3 size | |
| | | | | | chr | S. CLARK | 12/13/93 | | 50736 | A3 |
| | | | | | appd | S. CLARK | 12/14/93 | | type | Product Customer Drawing |
| sheet index | revision sheet | | | | | | | | | |

| PRODUCT NUMBER | NUMBER OF POSITIONS, NOTE 2 | SOLDER TAIL TAIL LENGTH | PLATING | CONTACT AREA PLATING |
|----------------|-----------------------------|-------------------------|----------|----------------------|
| 50736-1YYYYE | YYY | .125±.010/3.18±.25 | TIN-LEAD | 30μ"/.76μ GOLD |
| 50736-1YYYYF | YYY | .145±.010/3.68±.25 | TIN-LEAD | 30μ"/.76μ GOLD |
| 50736-1YYYYH | YYY | .180±.010/4.57±.25 | TIN-LEAD | 30μ"/.76μ GOLD |
| 50736-3YYYYE | YYY | .125±.010/3.18±.25 | TIN-LEAD | 50μ"/1.25μ GOLD |
| 50736-3YYYYF | YYY | .145±.010/3.68±.25 | TIN-LEAD | 50μ"/1.25μ GOLD |
| 50736-3YYYYH | YYY | .180±.010/4.57±.25 | TIN-LEAD | 50μ"/1.25μ GOLD |
| 50736-5YYYYE | YYY | .125±.010/3.18±.25 | TIN-LEAD | 30μ"/.76μ GXT |
| 50736-5YYYYELF | YYY | .125±.010/3.18±.25 | TIN | 30μ"/.76μ GXT |
| 50736-5YYYYF | YYY | .145±.010/3.68±.25 | TIN-LEAD | 30μ"/.76μ GXT |
| 50736-5YYYYFLF | YYY | .145±.010/3.68±.25 | TIN | 30μ"/.76μ GXT |
| 50736-5YYYYH | YYY | .180±.010/4.57±.25 | TIN-LEAD | 30μ"/.76μ GXT |
| 50736-5YYYYHLF | YYY | .180±.010/4.57±.25 | TIN | 30μ"/.76μ GXT |

NOTES:

- ① PRODUCT DESCRIPTION CODE:
50736 - X YYY Z LF
 - LEAD FREE (OPTIONAL)
 - TAIL LENGTH SEE TABLE
 - NO. OF POSITIONS SEE NOTE 2
 - PLATING SEE TABLE
 - BASE NUMBER
- ② THIS PRODUCT IS CONFIGURED IN SIZES OF 6 THRU 80 COLUMNS IN INCREMENTS OF ONE. i.e. 6,7,8,9.....79,80.
- ③ MATERIALS:
HOUSING - GLASS AND MINERAL FILLED
HIGH TEMP. THERMOPLASTIC, FLAME RETARDANT
PER UL94V-0. COLOR: BLACK.
PINS - PHOS BRONZE
- ④ MANUFACTURE'S NAME, P/N, & LOT CODE TO APPEAR ON THIS SURFACE PER BUS-12-108.

- ⑤ LENGTH FORMULAS
DIM "A"= .100/2.54 x NO. OF COLUMNS + .750/19.05
DIM "B"= .100/2.54 x NO. OF COLUMNS + .450/11.43
DIM "C"= .100/2.54 x NO. OF COLUMNS - .10/2.5
DIM "D"= .100/2.54 x NO. OF COLUMNS + .028/.71
- 6. THIS PRODUCT (WITH "LF") MEETS EUROPEAN UNION DIRECTIVES AND OTHER COUNTRY REGULATIONS AS DESCRIBED IN GS-22-008.
- 7. THIS HOUSING WILL WITHSTAND EXPOSURE TO 260° C PEAK TEMPERATURE FOR 10-30 SECONDS IN A CONVECTION, INFRA-RED OR VAPOR PHASE REFLOW OVEN.

FCJ
FCIconnect.com
Copyright FCI

| | | | | | |
|---------------------------|----------------|-----------------------|----------------------------------|---|---|
| mat'l. code SEE NOTE 3 | | surface ISO 1302 ✓ | tolerance ISO 406 ISO 1101 | projection | product family HPC |
| ltr | ecn | no | dr | date | tolerances unless otherwise specified |
| G | | | | | angles linear |
| | | | | | .xx ±.01/.3 .xxx ±.005/.13 .xxxx ±.0020/.051 |
| | | | | | dr G. PETERS 9/19/93 enr S. CLARK 9/19/93 chr S. CLARK 12/13/93 appd S. CLARK 12/14/93 |
| sheet index | revision sheet | | | | |
| | | | | title 4 ROW R/A RECEPTACLE SOLDER TAIL W/NIBS, 0 G.P. | |
| | | | | scale 1:1 | |
| | | | | dwg no 50736 sheet 3 of 3 size A3 | |
| | | | | type Product Customer Drawing | |