

JST

Crimp

5.0mm
(.197") pitch

SV CONNECTOR

Disconnectable Crimp style connectors

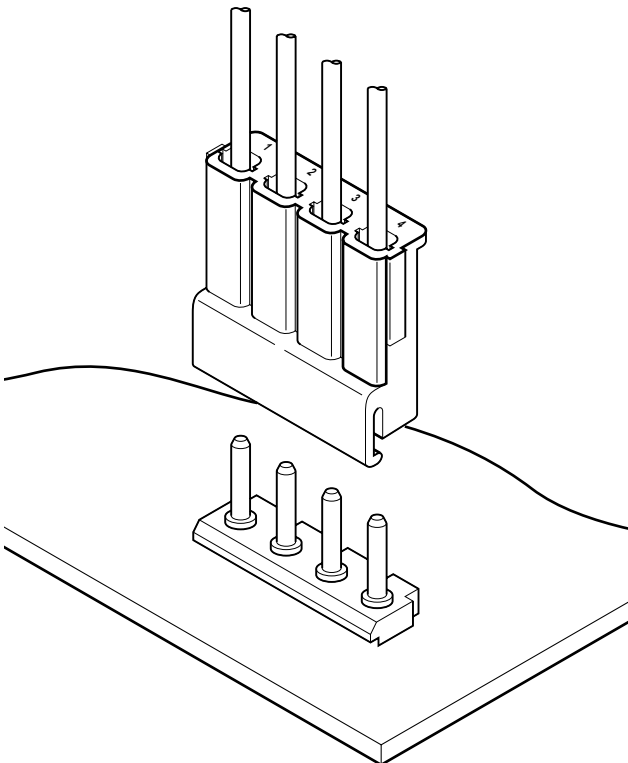
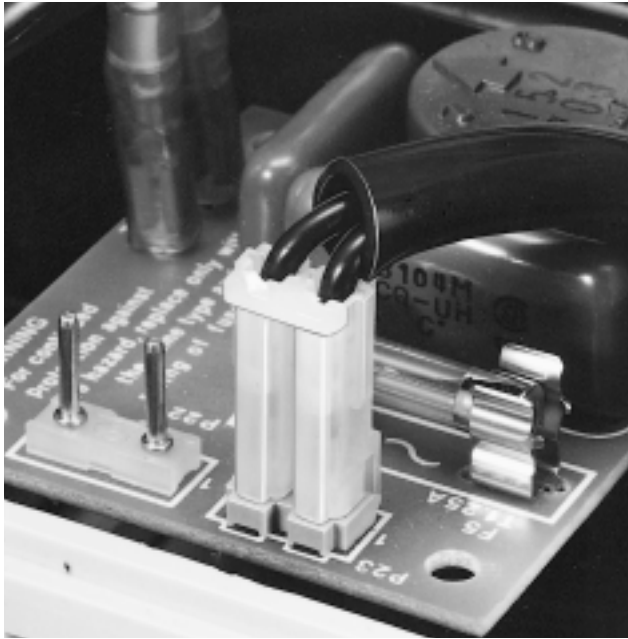

Features

• Anti-misinsertion feature

The directional features of the housing prevent reverse contact insertion.

• Locking mechanism

The housings with two or four circuits have locking mechanisms. This feature also provides polarization so that the housing cannot be mated with the header.

Specifications

- Current rating: 5A AC, DC (AWG #20)
 - Voltage rating: 250V AC, DC
 - Temperature range: -25°C to +85°C
(including temperature rise in applying electrical current)
 - Contact resistance: Initial value/10m max.
After environmental testing/15m max.
 - Insulation resistance: 1,000M min.
 - Withstanding voltage: 1,500V AC/minute
 - Applicable wire: AWG #24 to #20
 - Applicable PC board thickness: 1.6mm(.063")
- * Contact JST for details.

Standards

Recognized E60389

Certified LR20812

R75171

SV CONNECTOR

Contact

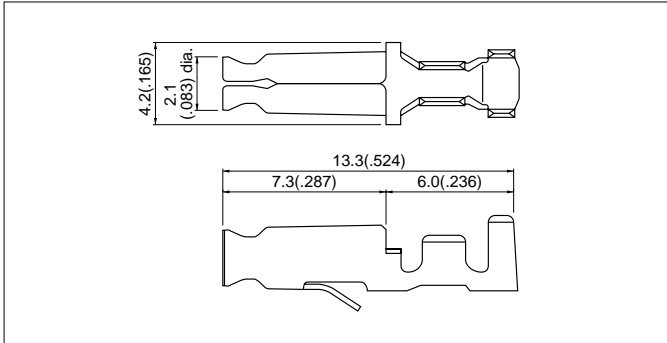

Model No.	Applicable wire			Q'ty / reel
	mm ²	AWG #	Insulation O.D. mm(in.)	
SVF-01T-1.5N	0.2 to 0.5	24 to 20	1.5 to 2.5(.059 to .098)	4,000

Material and Finish

Brass, tin-plated

Note: Contact JST for details if you require shielded wires, thin wires or other special wires, or if two wires must be crimped in one contact.

Housing

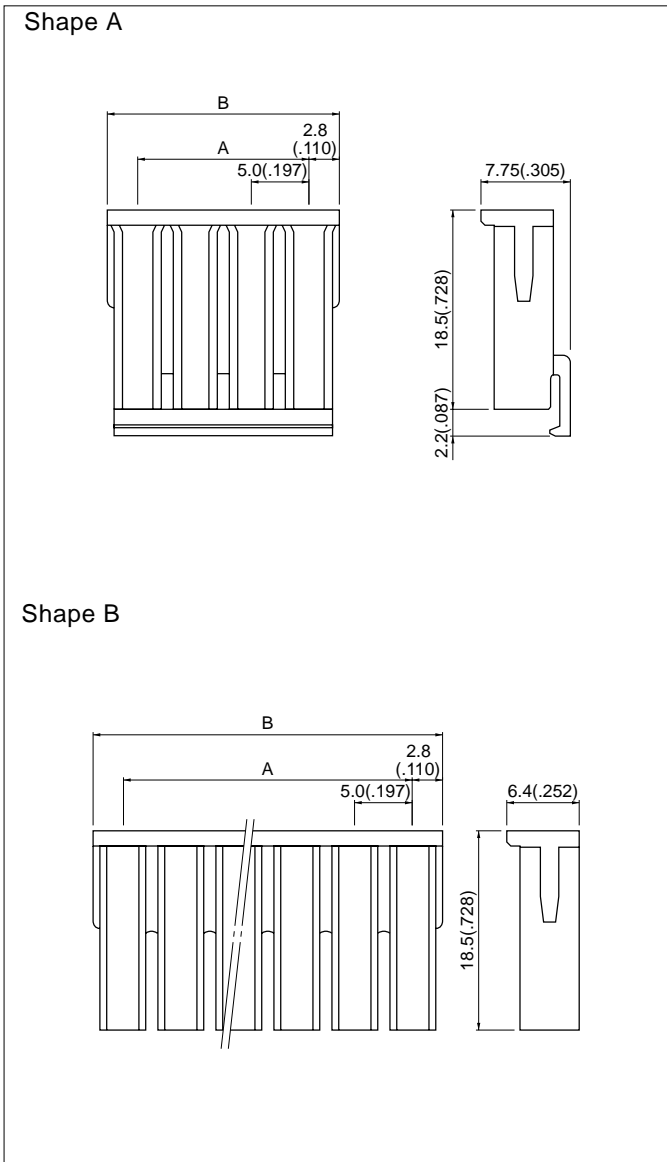

Circuits	Model No.	Shape	Dimensions mm(in.)		Q'ty / bag
			A	B	
2	S 2P-SVF	A	5.0(.197)	10.6(.417)	1,000
4	S 4P-SVF	A	15.0(.591)	20.6(.811)	500
6	S 6P-SVF	B	25.0(.984)	30.6(1.205)	500
8	S 8P-SVF	B	35.0(1.378)	40.6(1.598)	200
10	S10P-SVF	B	45.0(1.772)	50.6(1.992)	200

Material

Nylon 6, UL94V-2, natural (white)

Header

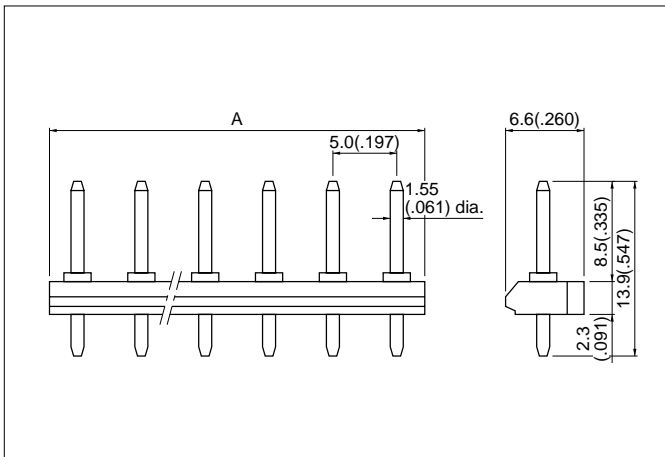

Circuits	Model No.	Dimension A mm(in.)	Q'ty / box
2	RTB-1.5- 2F	10.0(.394)	1,000
4	RTB-1.5- 4F	20.0(.787)	500
6	RTB-1.5- 6F	30.0(1.181)	500
8	RTB-1.5- 8F	40.0(1.575)	200
10	RTB-1.5-10F	50.0(1.969)	200

Material and Finish

Post: Brass, copper-undercoated, tin/lead-plated
 Wafer: Glass filled nylon 66, UL94V-0, natural (ivory)

PC board layout (viewed from soldering side) and Assembly layout

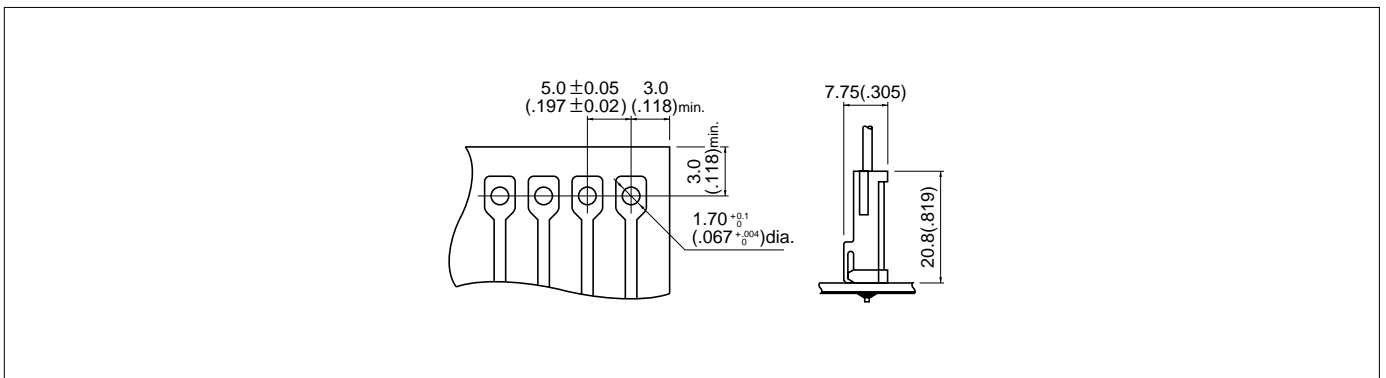

Note:

1. Tolerances are non-cumulative: $\pm 0.05\text{mm}(\pm .002")$ for all centers.
2. Hole dimensions differ according to the kind of PC board and piercing method. The dimensions above should serve as a guideline. Contact JST for details.

Applicator for the semi-automatic press AP-K2N

Contact	Crimp applicator MKS-L		Compact crimp applicator MKS-LS		Strip-crimp applicator MKS-SC
	with safety cover	without safety cover	with safety cover	without safety cover	with safety cover
SVF-01T-1.5N	APLMK SVF01-15N	APLNC SVF01-15N	-	-	-