

SPECIFICATIONS

Voltage rating: 250VAC/VDC
 Current rating: 3 amps AC/DC
 Contact material: Brass
 Contact plating: Tin
 Contact resistance: 20 milliohms max.
 Base material: Nylon 66, UL94V-2
 Insulation resistance: 1,000 megohms min.
 Withstanding: 1,000VAC for 1 min.
 Temperature range: -25°C to +85°C
 Packaging: 1,000 pcs/bag

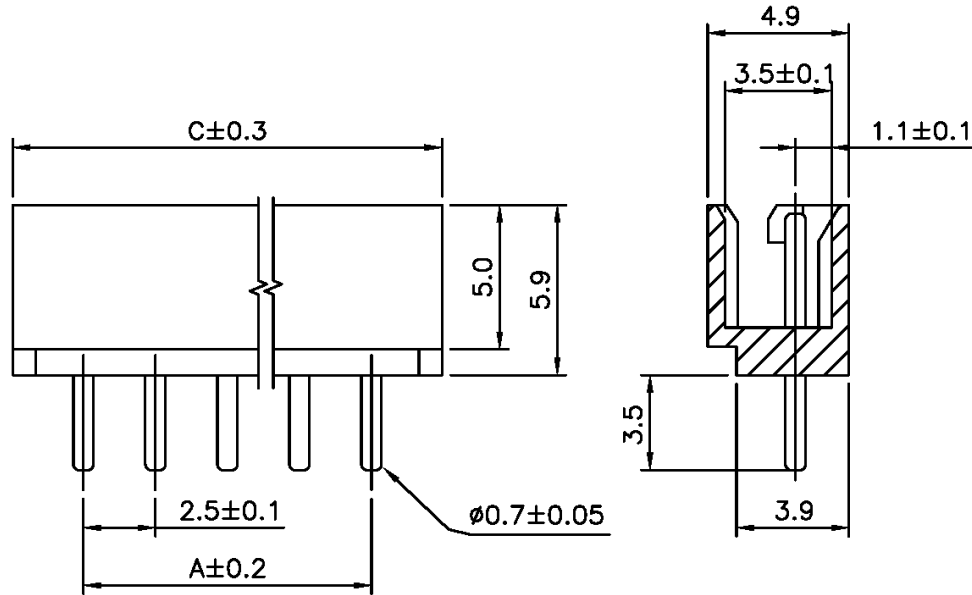

Dimensions (mm)			
Pos.	A	B	C
2	2.50	6.00	7.50
3	5.00	8.50	10.00
4	7.50	11.00	12.50
5	10.00	13.50	15.00
6	12.50	16.00	17.50
7	15.00	18.50	20.00
8	17.50	21.00	22.50
9	20.00	23.50	25.00
10	22.50	26.00	27.50
11	25.00	28.50	30.00
12	27.50	31.00	32.50
13	30.00	33.50	35.00
14	32.50	36.00	37.50
15	35.00	38.50	40.00
16	37.50	41.00	42.50
17	40.00	43.50	45.00
18	42.50	46.00	47.50
19	45.00	48.50	50.00
20	47.50	51.00	52.50

RoHS compliant

Rev.	Description	Date	Approved	Drawing	Name	Date
				Approved	Howard	05/15/05
				Checked	Lizzy	05/15/05
				Drawn	Tina	05/15/05
				0.0 ± 0.35	0.00 ± 0.20	Angles $\pm 3'$
					UNIT: mm	

Central Components Manufacturing
 440 Lincoln Blvd., Middlesex, New Jersey 08846
 Phone 732 469-5720 888 288-5152 Fax 732 469-1919

Part No.: **JS-1135-XX**

Description: 2.50mm crimp style connector wafer