

PRODUCT NUMBER
10085788-YXXLF

- LEAD FREE, RoHS COMPATIBLE
SEE NOTE 5
- PIN STYLE, SEE SHEET 2 & 3.
- PLATING SEE SHEET 2 & 3.

NOTES:

- 1 - HOUSING MAT'L : GLASS FILLED THERMOPLASTIC. UL94V-0 COLOR: BLUE
- 2 - PIN MATERIAL : PHOSPHOR BRONZE
- 3 - PRODUCT PACKAGED IN TUBES.
- 4 - TO DETERMINE DIMENSIONS :
N = NUMBER OF POSITIONS PER ROW
EXAMPLE : 8 POS N x 2.54 = 20.32mm
- 5 - RoHS COMPATIBLE PRODUCT SPECIFICATIONS
 - a - PLATING:
 - "LF" MEANS THE PRODUCT IS LEAD-FREE, 2µm MINIMUM MATTE TIN OVER 1.27µm MINIMUM NICKEL UNDERPLATE.
 - b - MANUFACTURING PROCESS COMPATIBILITY
 - THE HOUSING WILL WITHSTAND EXPOSURE TO 260°C ±5°C SOLDER BATH TEMPERATURE FOR 5 SECONDS IN A WAVE SOLDER APPLICATION WITH A 1.6mm MIN THICK CIRCUIT BOARD.
 - c - LABELLING:
 - MEETS PACKAGING SPECS AS PER GS-14-920
 - d - LEGAL STATEMENT: SEE GS-47-0004

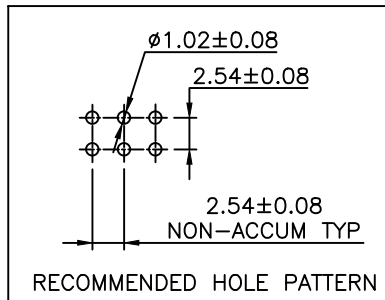
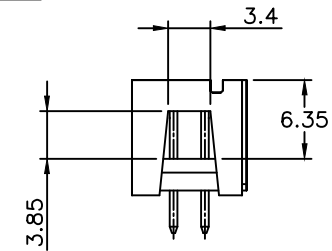
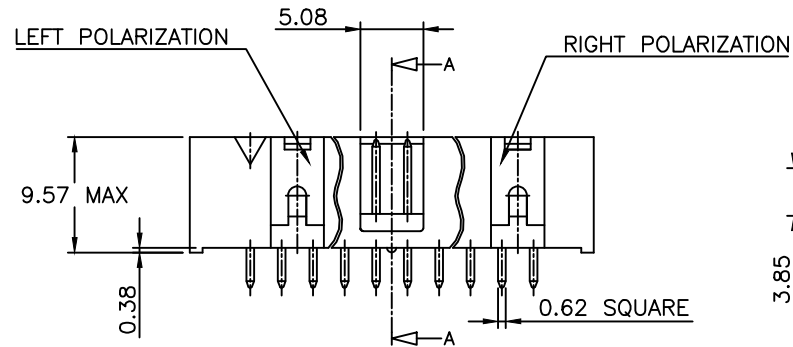
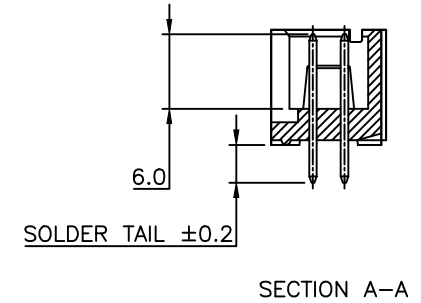
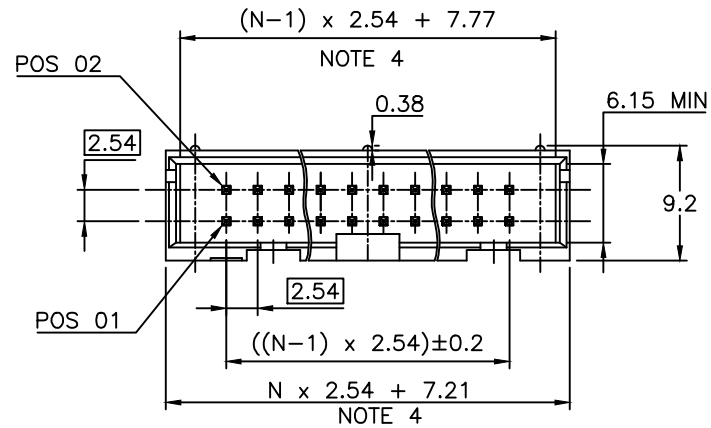

mat'l. code SEE NOTES		surface ISO 1302 ✓	tolerance ISO 406 ISO 1101	projection mm	product family QUICKIE
ltr	ecn no	dr	date	tolerances unless otherwise specified	title SHR.LP.HEADER 0.76µm GXT
A	F08-0112	LMU	08.01.10	angles Linear .X ±0.3	dwg no 10085788 sheet 1 of 2 size A3
B	B-19070	LMU	14.10.15	.XX ±0.13	
C	B-19564	BVE	14.12.01	.XXX ±0.05	
		dr	LMU	08.01.10	scale 2.5:1
		enrg	MULIN.L	08.01.10	FCJ type CUSTOMER Drawing
		chr	JM.C	08.01.10	
		appd	JM.C	08.01.10	
sheet index	revision sheet	C	A		
		1	2		

1

2

4

5

6

CORE RANGE

PIN STYLE	NUMBER OF POSITIONS	SOLDER TAIL REF	LEFT POLARIZATION	RIGHT POLARIZATION
30	2 x 2	3.05	NO	NO
31	2 x 3	3.05	NO	NO
32	2 x 4	3.05	NO	NO
01	2 x 5	3.05	NO	YES
02	2 x 7	3.05	NO	YES
03	2 x 8	3.05	YES	YES
04	2 x 10	3.05	YES	YES
05	2 x 13	3.05	YES	YES
33	2 x 15	3.05	YES	YES
06	2 x 17	3.05	YES	YES
07	2 x 20	3.05	YES	YES
08	2 x 25	3.05	YES	YES
09	2 x 30	3.05	YES	YES
10	2 x 32	3.05	YES	YES

CATALOGUE RANGE

PIN STYLE	NUMBER OF POSITIONS	SOLDER TAIL REF	LEFT POLARIZATION	RIGHT POLARIZATION
30	2 x 2	3.05	NO	NO
31	2 x 3	3.05	NO	NO
32	2 x 4	3.05	NO	NO
01	2 x 5	3.05	NO	YES
02	2 x 7	3.05	NO	YES
03	2 x 8	3.05	YES	YES
04	2 x 10	3.05	YES	YES
05	2 x 13	3.05	YES	YES
33	2 x 15	3.05	YES	YES
06	2 x 17	3.05	YES	YES
07	2 x 20	3.05	YES	YES
08	2 x 25	3.05	YES	YES
09	2 x 30	3.05	YES	YES
10	2 x 32	3.05	YES	YES

PLATING :

1 = 0.76µm GXT (PdNi WITH GOLD FLASH)
 ON CONTACT AREA
 2µm MATTE TIN ON TAILS
 1.27µm Nickel MIN UNDERPLATING

PLATING :

1 = 0.76µm GXT (PdNi WITH GOLD FLASH)
 ON CONTACT AREA
 2µm MATTE TIN ON TAILS
 1.27µm Nickel MIN UNDERPLATING



FCJconnect.com

Copyright FCJ

mat'l. code		surface		tolerance		projection		product family	
SEE NOTES		ISO 1302 ✓		ISO 406 ISO 1101				QUICKIE	
ltr	ecn no	dr	date	tolerances unless otherwise specified		mm		title	
A	F08-0112	LMU	08.01.10	angles	.X ±0.3			SHR.LP.HEADER	
				linear	.XX ±0.13	scale 2.5:1		0.76µm GXT	
					.XXX ±0.05			dwg no	
				dr	LMU	08.01.10		sheet 2 of	
				enr	MULIN.L	08.01.10		size	
				chr	JM.C	08.01.10		10085788	
				appd	JM.C	08.01.10		type	
sheet index		revision sheet						CUSTOMER Drawing	

