

- NOTES:**
- MATERIAL: BASE AND COVER: 30% GLASS FILLED POLYESTER FLAME RETARDANT PER UL-94-V0 COLOUR GREY STRAIN RELIEF: UNREINFORCED THERMOPLASTIC FLAME RETARDANT PER UL-94-V0 COLOUR GREY CONTACT: BERILLIUM COPPER
 - PLATING: 0.76 μ m Au OVER 1.27 μ m Ni IN CONTACT AREA REMAINDER OF PRODUCT (IDC PART) 1.27 μ m Ni
 - TRIANGLE NOT MOLDED-IN ON 2x3 POSITIONS WITH CENTRAL KEY
 - THE DASH "L" AT THE END OF THE PART NUMBER TO INDICATE A NEW LATCH DESIGN

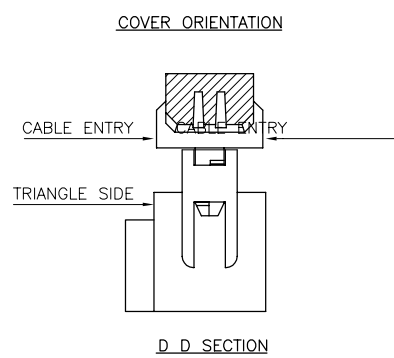
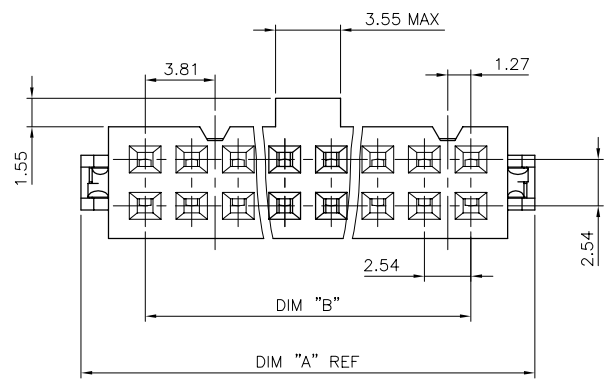

SPECIAL KEY PRODUCT

CUSTOMER COPY FOR REFERENCE ONLY

| | | | | | | | | | |
|-------------|----------|-----------|-------------|---------------------------------------|--|---------------|-----------------|--------------------|--------|
| mat'l. code | | SEE NOTES | | tolerances unless otherwise specified | | CUSTOMER COPY | | | |
| ltr | ecm no | dr | date | linear | | projection | title | www.fciconnect.com | |
| A | F60302 | OMA | 96.04.16 | | | | EURO QUICKIE | | |
| | | | | angles | | mm | 0.76 μ m Au | | |
| | | dr | O. MATHEVON | 96.04.16 | | | product family | EURO QKIE FEM | code |
| | | engn | JM PHAMVAN | 96.04.16 | | | size | dwg no | 213 |
| | | chr | P. NIZZI | 96.04.16 | | scale | A2 | 95248 | sheet |
| | | appd | JM P | 96.04.16 | | 5:1 | | | 1 of 2 |
| sheet | revision | A | A | | | | | | |
| index | sheet | 1 | 2 | | | | | | |

| PRODUCT NUMBER | SIZE | DIM "A" | DIM "B" | DIM "C" | DIM "S" | SLOT STYLE |
|----------------|-------|---------|---------|---------|---------|-----------------|
| 95248-X06 | 2x 3 | 12.08 | 5.08 | 12.00 | 8.20 | RIGHT IF NO KEY |
| 95248-X08 | 2x 4 | 14.62 | 7.62 | 14.54 | 10.74 | RIGHT IF NO KEY |
| 95248-X10 | 2x 5 | 17.16 | 10.16 | 17.08 | 13.28 | RIGHT SLOT |
| 95248-X14 | 2x 7 | 22.24 | 15.24 | 22.16 | 18.36 | RIGHT SLOT |
| 95248-X16 | 2x 8 | 24.78 | 17.78 | 24.70 | 20.90 | 2 SLOTS |
| 95248-X18 | 2x 9 | 27.32 | 20.32 | 27.24 | 23.44 | 2 SLOTS |
| 95248-X20 | 2x 10 | 29.86 | 22.86 | 29.78 | 25.98 | 2 SLOTS |
| 95248-X24 | 2x 12 | 34.94 | 27.94 | 34.85 | 31.06 | 2 SLOTS |
| 95248-X26 | 2x 13 | 37.48 | 30.48 | 37.40 | 33.60 | 2 SLOTS |
| 95248-X30 | 2x 15 | 42.56 | 35.56 | 42.48 | 38.68 | 2 SLOTS |
| 95248-X34 | 2x 17 | 47.64 | 40.64 | 47.56 | 43.76 | 2 SLOTS |
| 95248-X40 | 2x 20 | 55.26 | 48.26 | 55.18 | 51.38 | 2 SLOTS |
| 95248-X44 | 2x 22 | 60.34 | 53.34 | 60.26 | 56.46 | 2 SLOTS |
| 95248-X50 | 2x 25 | 67.96 | 60.96 | 67.88 | 64.08 | 2 SLOTS |
| 95248-X60 | 2x 30 | 80.66 | 73.66 | 80.58 | 76.78 | 2 SLOTS |
| 95248-X64 | 2x 32 | 85.74 | 78.74 | 85.66 | 81.86 | 2 SLOTS |

95248-XYL SEE NOTE 4 SHEET 1

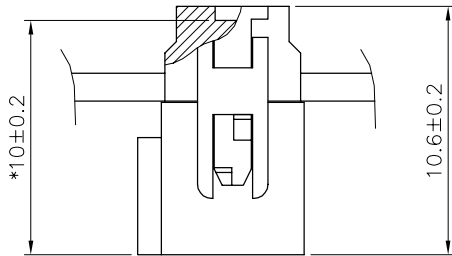

WITHOUT STRAIN RELIEF

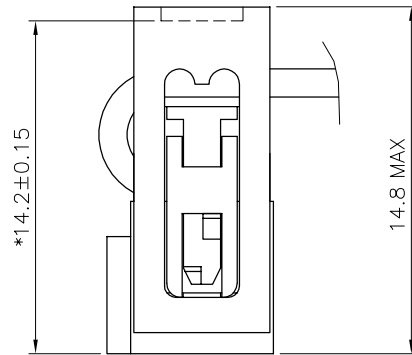

WITH LOW PROFILE STRAIN RELIEF

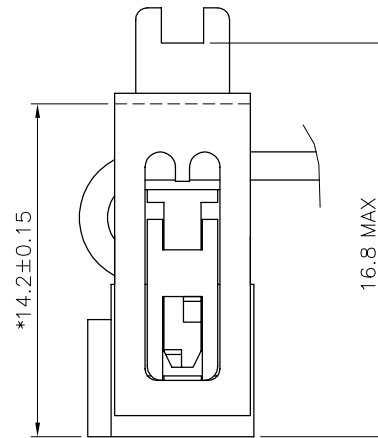

WITH STANDARD STRAIN RELIEF

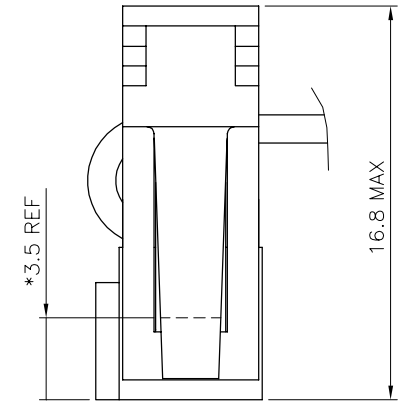

WITH LATCHING STRAIN RELIEF

AFTER TERMINATIO SIDE VIEW OF ASSEMBLY (* LATCHING DIM ON HEADER)

| 95248-7YY | | ● | | | | ● | 724 |
|----------------|------------------|---------------------|------------------------|-----------------------|---------------------------|------------------------|----------------------|
| 95248-6YY | ● | | | | | ● | 624 |
| 95248-5YY | | ● | | | ● | | 524 |
| 95248-4YY | | ● | | ● | | | |
| 95248-3YY | | ● | ● | | | | |
| 95248-2YY | ● | | | | ● | | 224 |
| 95248-1YY | ● | | | | ● | | |
| 95248-0YY | ● | | ● | | | | |
| PRODUCT NUMBER | WITH CENTRAL KEY | WITHOUT CENTRAL KEY | STANDARD STRAIN RELIEF | WITHOUT STRAIN RELIEF | LOW PROFILE STRAIN RELIEF | LATCHING STRAIN RELIEF | DASHES NOT AVAILABLE |

| mat'l. code | | tolerances unless otherwise specified | | CUSTOMER COPY | | FCI ELECTRONICS | |
|-------------|----------|---------------------------------------|----------|---------------|------------|-----------------|--------------------|
| ltr | ecn no | dr | date | linear | projection | title | www.fciconnect.com |
| A | F60302 | OMA | 96.04.16 | | ⊕ | EURO QUICKIE | |
| | | | | angles | | 0.76 μm Au | |
| | | | | dr | O.MATHEVON | 96.04.16 | code |
| | | | | engn | JM PHAMVAN | 96.04.16 | 213 |
| | | | | chr | P. NIZZI | 96.04.16 | sheet |
| | | | | appd | JM P | 96.04.16 | 2 of |
| sheet | revision | | | scale | N/A | A2 | 95248 |
| index | sheet | | | | | | |