

PRODUCT NUMBER
SEE TABLE

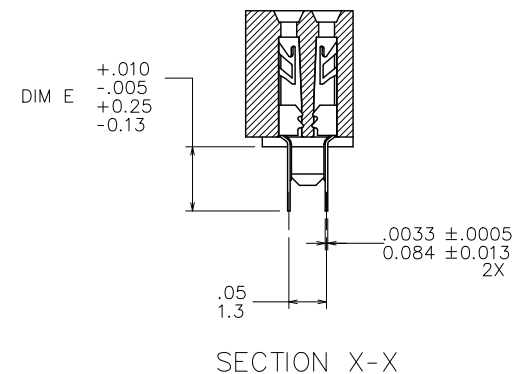
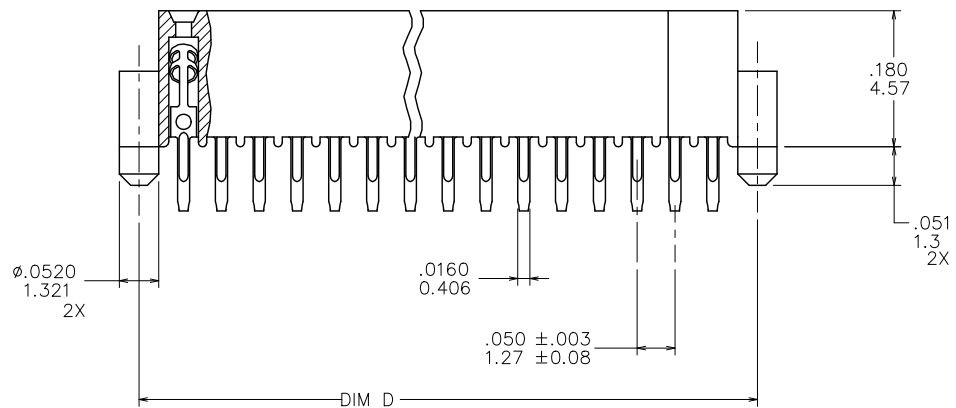
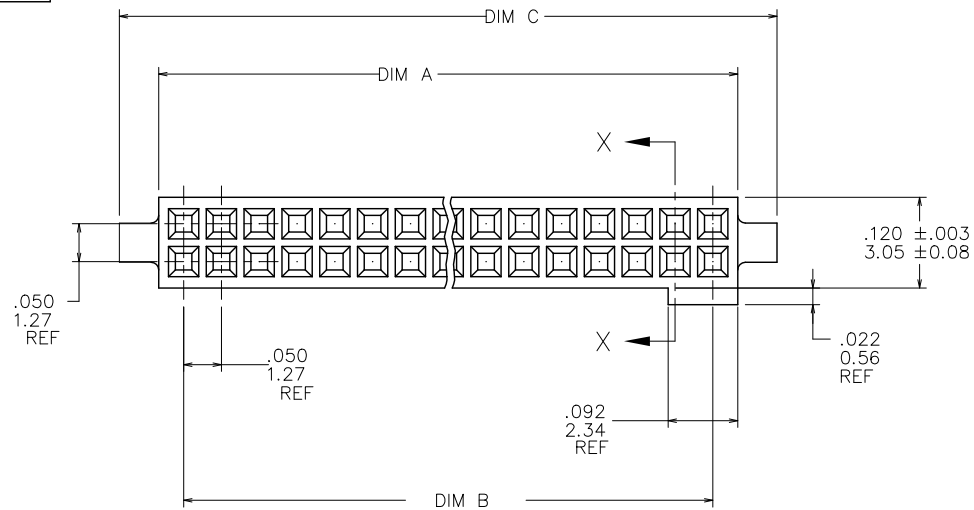

mat'l. code -				surface ISO 1302 ✓		tolerance ISO 406 ISO 1101		projection INCH/MM		product family RIBCAGE	
ltr				tolerances unless otherwise specified		angles		linear		title	
L	V10994	DLW	3/9/01			0°±2°		.xx±.01/0.3		.050 CC V.C.C. THRU MT. W/LOC. & POL FEATURES	
M	V11674	CRG	6/22/01					.xxx±.005/0.13		dwg no	
N	M05-0123	ERE	6/07/05					.xxxx±.0020/0.051		sheet 1 of 2	
P	M06-0225	ERE	6/12/06	dr	S. RAMP	5/9/90		scale 4:1		size	
R	M06-0370	MHT	9/26/06	engr	C. TREXLER	5/9/90		FCI		87014	
S	N10-0174	YO	6/17/10	chr	C. TREXLER	5/9/90				A3	
T	ELX-N-010267	YO	2/13/12	appd	C. TREXLER	5/9/90				type Product Customer Drawing	
sheet index	revision sheet	T	T								
		1	2								

PRODUCT NO. NOTE 6	SIZE	DIM A	DIM B	DIM C	DIM D	DIM E	PLATING
87014-510	2 X 10	.516/13.11	.450/11.43	.620/15.75	.5700/14.478	.100/2.54	NOTE 3
-605	2 X 5	.266/6.76	.200/5.08	.370/9.40	.3200/8.128	.085/2.16	
-610	2 X 10	.516/13.11	.450/11.43	.620/15.75	.5700/14.478		
-615	2 X 15	.766/19.46	.700/17.78	.870/22.10	.8200/20.828		
-620	2 X 20	1.016/25.81	.950/24.13	1.120/28.45	1.0700/27.178		
-625	2 X 25	1.266/32.16	1.200/30.48	1.370/34.80	1.3200/33.528		
-630	2 X 30	1.516/38.51	1.450/36.83	1.620/41.15	1.5700/39.878		
-635	2 X 35	1.766/44.86	1.700/43.18	1.870/47.50	1.8200/46.228		
-640	2 X 40	2.016/51.21	1.950/49.53	2.120/53.85	2.0700/52.578		
-645	2 X 45	2.266/57.56	2.200/55.88	2.370/60.20	2.3200/58.928		
87014-650	2 X 50	2.516/63.91	2.450/62.23	2.620/66.55	2.5700/65.278		NOTE 3
87014-905	2 X 5	.266/6.76	.200/5.08	.370/9.40	.3200/8.128		NOTE 5
-910	2 X 10	.516/13.11	.450/11.43	.620/15.75	.5700/14.478		
-915	2 X 15	.766/19.46	.700/17.78	.870/22.10	.8200/20.828		
-920	2 X 20	1.016/25.81	.950/24.13	1.120/28.45	1.0700/27.178		
-925	2 X 25	1.266/32.16	1.200/30.48	1.370/34.80	1.3200/33.528		
-930	2 X 30	1.516/38.51	1.450/36.83	1.620/41.15	1.5700/39.878		
-935	2 X 35	1.766/44.86	1.700/43.18	1.870/47.50	1.8200/46.228		
-940	2 X 40	2.016/51.21	1.950/49.53	2.120/53.85	2.0700/52.578		
-945	2 X 45	2.266/57.56	2.200/55.88	2.370/60.20	2.3200/58.928		
87014-950	2 X 50	2.516/63.91	2.450/62.23	2.620/66.55	2.5700/65.278	.085/2.16	NOTE 5

NOTES:

- HOUSING MATERIAL:
GLASS FILLED THERMOPLASTIC FLAME RETARDANT PER UL 94V-0
COLOR: NATURAL
- TERMINAL MATERIAL: BeCu
- TERMINAL PLATING:
30u"/0.76um MIN HARD Au OR GXT OVER Ni ON CONTACT ZONES.
100u"/2.54um MIN Sn OVER Ni IN SOLDERING ZONES.
OTHERWISE GOLD FLASH OR UNPLATED
- APPLICATION INFORMATION:
 - RECOMMENDED PCB LAYOUT PATTERN IS SHOWN IN FIGURE A.
 - MATING PINS TO BE .0176/0.447 TO .0181/0.459 DIA.
 - MATING PIN TIPS TO BE IN TRUE POSITION TO MATING GRID WITHIN .006/0.15 DIA.
 - SUGGESTED MATING PIN LENGTH .130/3.30±.010/0.25
- TERMINAL PLATING:
60u"/1.52um MIN HARD Au OVER Ni ON CONTACT ZONES.
100u"/2.54um MIN Sn OVER Ni ON SOLDER TAILS.
- ADD "LF" SUFFIX AT THE END OF PART NUMBER FOR LEAD FREE OPTION.
- THIS PRODUCT MEETS EUROPEAN UNION DIRECTIVES AND OTHER COUNTRY REGULATION AS DESCRIBED IN GS-22-008.
- THE HOUSING WILL WITHSTAND EXPOSURE TO 260° PEAK TEMPERATURE FOR 15 SECONDS IN A WAVE SOLDER APPLICATION WITH A 1.5mm MINIMUM THICK CIRCUIT BOARD. SEE APPLICATION NOTES/PROCEDURES IF THEY ARE AVAILABLE.
- PRODUCT SPEC PER BUS-12-087.

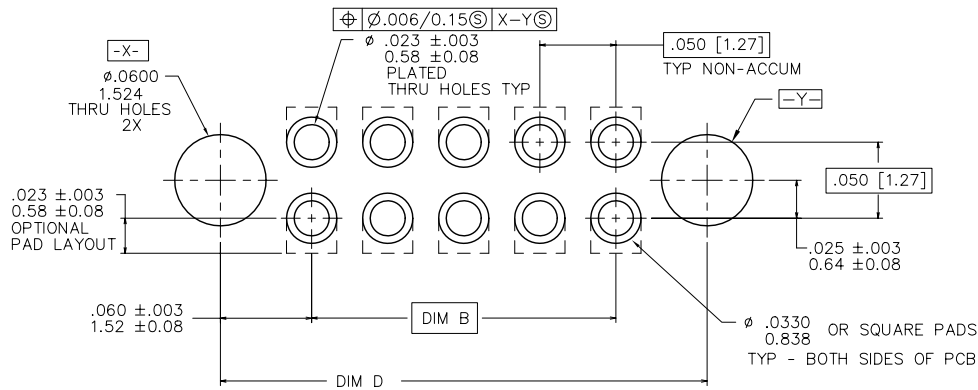

FIGURE A
RECOMMENDED
P.C.B. LAYOUT

mat'l. code		surface		tolerance		projection		product family	
-		ISO 1302 ✓		ISO 406 ISO 1101				RIBCAGE	
ltr	ecn	no	dr	date		tolerances unless otherwise specified		title	
T						angles linear .XX±.01/0.3 .xxx±.005/0.13 .0°±2' .xxxx±.0020/0.051		INCH/MM .050 CC V.C.C. THRU MT. W/LOC. & POL FEATURES	
				dr	S. RAMP	5/9/90	scale 4:1		dwg no
				engr	C. TREXLER	5/9/90			sheet 2 of 2
				chr	C. TREXLER	5/9/90	87014		size
				appd	C. TREXLER	5/9/90	type Product Customer Drawing		A3
sheet index	revision sheet								