

P.C.B LAYOUT

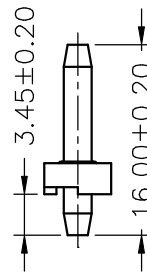
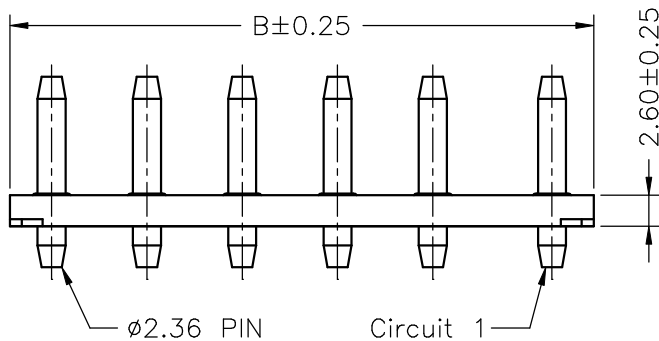
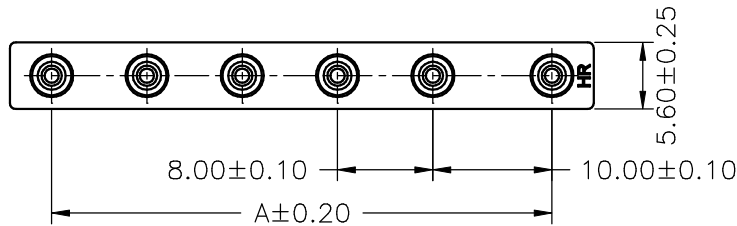

SPECIFICATIONS

Current Rating: 7A AC,DC
 Voltage Rating: 250V AC,DC
 Temperature Range: -25°C ~ +85°C
 Contact Resistance: 10mΩ Max
 Insulation Resistance: 1000MΩ Min
 Withstanding Voltage: 1500V AC/minute
 Pin Material: Brass/Tin-plated
 Material: Nylon 66,UL94V-0
 Color: Black

Ordering Information & Dimensions

PART NO.	Dimensions	
	A	B
A1080WV-01P	---	7.00
A1080WV-02P	10.00	17.00
A1080WV-03P	18.00	25.00
A1080WV-04P	26.00	33.00
A1080WV-05P	34.00	41.00
A1080WV-06P	42.00	49.00

UNIT	SCALE	SHEET	TITLE:
mm		1 of 1	10.00-8.00mm PITCH 180° WAFER
DRAWN BY	APPROVED BY		
董正一 2001.02.01	董正一 2001.02.01		
GENERAL TOLERANCE			
B1	REVISE	2006.04.24	X. X±0.25
B0	NEW RELEASE	2005.12.21	X. XX±0.15
REV.	DESCRIPTION	DATE	X. XXX±0.05
DRAW NO. :			REV.
A1080WV-XP			B1