

RECOMMENDED PCB LAYOUT

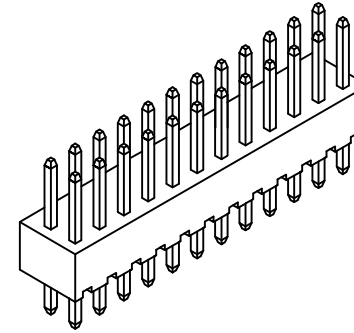
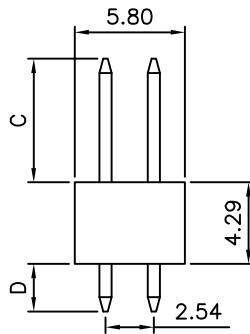
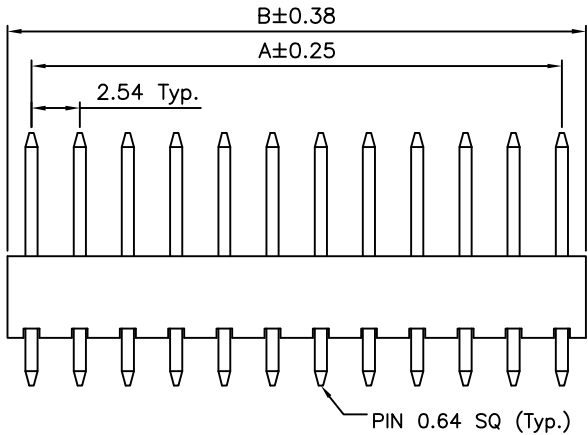

CONTACTS	DIMENSIONS	
	A	B
4	2.54	5.08
6	5.08	7.62
8	7.62	10.16
10	10.16	12.70
12	12.70	15.24
14	15.24	17.78
16	17.78	20.32
18	20.32	22.86
20	22.86	25.40
22	25.40	27.94
24	27.94	30.48
26	30.48	33.02
28	33.02	35.56
30	35.56	38.10
32	38.10	40.64
34	40.64	43.18
36	43.18	45.72
38	45.72	48.26
40	48.26	50.80
42	50.80	53.34
44	53.34	55.88
46	55.88	58.42
48	58.42	60.96
50	60.96	63.50
52	63.50	66.04
54	66.04	68.58
56	68.58	71.12
58	71.12	73.66
60	73.66	76.20
62	76.20	78.74
64	78.74	81.28
66	81.28	83.82
68	83.82	86.36
70	86.36	88.90
72	88.90	91.44
74	91.44	93.98
76	93.98	96.52
78	96.52	99.06
80	99.06	101.60

SPECIFICATIONS 规格

CURRENT RATING 电流额定值: 3.0 AMPERE
 INSULATION RESISTANCE 绝缘电阻值: 1000MΩ Min.
 DIELECTRIC WITHSTANDING 耐电压: 600V AC
 CONTACT RESISTANCE 接触电阻值: 20mΩ Max.
 OPERATING TEMPERATURE 工作温度: -40°C TO +105°C
 CONTACT MATERIAL 端子物料: COPPER ALLOY
 INSULATION MATERIAL 绝缘体物料:
 STANDARD 标准物料: POLYAMIDE 聚酰胺, NYLON 6T, UL 94-V0
 OPTIONS 可选物料: POLYESTER 聚酯, LCP, UL 94-V0
 OR POLYESTER 聚酯, PBT, UL94-V0
 SOLDERING PROCESS 可焊性:
 NYLON 6T (STANDARD 标准物料) -
 IR REFLOW 回流焊: 260°C for 10 sec.
 WAVE 波峰焊: 230°C for 5-10 sec.
 MANUAL SOLDER 人工焊接: 350°C for 3-5 sec
 PBT (OPTION 可选物料) - MANUAL SOLDER 人工焊接: 330°C for 3-5 sec.
 (NOT SUITABLE FOR HI-TEMP PROCESS 不适合高温处理)
 LCP (OPTION 可选物料) -
 IR REFLOW 回流焊: 260°C for 10 sec.
 WAVE 波峰焊: 250°C for 5-10 sec.
 MANUAL SOLDER 人工焊接: 350°C for 3-5 sec

Ordering Grid

BG045 - XX - X - XXXX - XXXX - X - X

REQUEST SAMPLES AND QUOTATION

No. of Contacts 04 to 80

Contact Plating
 A = Gold Flash All Over
 B = Selective Gold Flash Contact Area/ Tin On Tail
 C = Tin All Over
 G = 10µ" Gold Contact Area/Tin On Tail
 I = 30µ" Gold Contact Area/Tin On Tail
Standard = Gold Flash All Over

Insulator Material
N = Nylon 6T (Standard)
 P = PBT
 L = LCP

Packing Options
G = Plastic Box (Standard)
 D = Tube
 E = Tube with Cap

Dimension C (1/100mm) (Post Height)
Standard - 6.00mm = 0600
 Or specify Dimension C
 e.g. 2.50mm = 0250
 TOL.: ±0.2mm

Dimension D (1/100mm) (Tail Length)
Standard - 3.00mm = 0300
 Or specify Dimension D
 I.E. 2.5mm = 0250
 TOL.: ±0.2mm

MATES WITH 配套之母座 (SUBJECT TO PIN LENGTH 在端子长度适合的条件下):

BG120	BG140	BG150	BG151	BG160
BG165	BG170	BG175	BG180	BG185
BG190	BG195	BG200	BG210	

By	LYH	PN	CB	DR
DETAIL	DRAWING RELEASE	STANDARD INSULATOR MATERIAL CHANGED	PACKING OPTIONS CHANGED	CHANGE TO SOLDER TEMP. INFORMATION
REV DATE	A 20/10/06	B 12/03/09	C 27/04/09	D 05/08/09

Tolerances (Except as noted)	Part Number:-	Date:-
Dimensions in mm	BG045	20 OCT 06
X. ± 0.30	Description:-	
X.X ± 0.20	2.54mm PITCH PIN HEADER, DUAL ROW, THROUGH-HOLE, VERTICAL	
X.XX ± 0.15	© THIS DRAWING IS CONFIDENTIAL AND MUST NOT BE COPIED OR DISCLOSED WITHOUT WRITTEN CONSENT	
X.XXX ± 0.10	Third Angle Projection	



Global Connector Technology

www.globalconnectortech.com

Scale NTS
 Revision D
 Material See Note
 Drawn by LYH
 E & OE
 Sheet No. 1/1